

AUCTION CATALOG

SWANSON GROUP GLENDALE SAWMILL

2695 Glendale Valley Rd, Glendale, OR 97442

9 AM – Wednesday, August 7th

Preview 8 am to 4 pm, Tuesday, August 6th

ONLINE BIDDING LOTS 1 - END
LOTS 2002-2037 ROLLING STOCK & EQUIPMENT LOCATED OFFSITE TO BE SOLD AT 1 PM

TERMS AND CONDITIONS

10% BUYERS PREMIUM ON ALL ITEMS - 15% BUYERS PREMIUM ON ALL ONLINE PURCHASES

Due to insurance and safety reasons, children under 12 cannot be admitted

PAYMENT: Full payment must be made by no later than close of business auction day. Payment must be made by **CASH, CASHIERS CHECK, WIRE TRANSFERS, MASTERCARD OR VISA ONLY. Checks are accepted ONLY with Bank Letter of Guarantee.**

REMOVAL: No purchases may be removed during the auction unless announced by the auctioneer. Small items must be removed by 4:00 PM Friday, August 16th. **ALL EQUIPMENT MUST be removed no later than 4:00 PM, Friday, November 8th, 2019. (REMOVAL DEADLINES MAY BE MODIFIED BY AUCTIONEER'S ANNOUNCEMENT).** Removal hours: 8:00 AM – 4:00 PM, Monday through Friday. **NO WEEKEND OR HOLIDAY REMOVAL.** ****ITEMS NOT REMOVED BY REMOVAL DEADLINE MAY BE CHARGED STORAGE FEES****

Upon award of bid dismantlers take responsibility for any environment issues they create (e.g. spilled hydraulic oil). Dismantlers are required to provide their own materials to contain & clean up any oil spillage.

Insurance: Dismantlers, contractors or buyers removing equipment are required to provide \$1,000,000.00 dollar General Liability **Insurance certificate showing the James G. Murphy Company and Swanson Group, Inc.** as the **additional insured** parties. Insurance certificate and proof of workmen's compensation compliance must be on file at sale site with the James G. Murphy Co. before dismantling commences.

Purchased lots are at the buyer's risk. It is the responsibility of the buyer to provide adequate property insurance coverage for the items purchased and buyer's own equipment at the auction site.

FIRE PROTECTION POLICY: NO CUTTING WITHOUT A PERMIT

- Dismantlers required to provide their own fire hose & spray nozzles.
- A signed burning permit issued to dismantlers will be displayed in cutting area
- A limited number of burning permits will be issued. One burning permit per hose while cutting.
- Each man using a cutting torch will have one firewatch with a hose while cutting
- Firewatch to wet down before, during and after cutting.
- Firewatch to stay in area one hour after cutting is completed
- Cutting hours are from **8 AM to 2:00 PM**

Warranty Disclaimer: ALL SALES ARE FINAL. All items are being sold "As Is, Where Is, With All Faults" and without any warranties as to merchantability of fitness for a particular purpose. The principal, the auctioneer, the advertising coordinator, and any of their agents makes no express or implied warranties of any type. Complete terms and conditions of sale will be available at the time of sale. All information was obtained from sources deemed reliable. Although every precaution has been taken to ensure accuracy, the principal, the James G. Murphy Co., the advertising coordinator, and all of their agents shall not be responsible for any errors or omissions therein. It is for this reason that we recommend that all items be thoroughly inspected prior to the point of sale.

Announcements made by the auctioneer at the time of sale take precedence over printed matter. Auctioneer reserves the right to sell accessories, parts or attachments on a separate and/or aggregate basis

ABSENTEE BIDS: Absentee bids will be accepted with 25% Deposit. Absentee bids under \$100.00 are not accepted. For complete rules regarding absentee bids call our office or inquire at the auction site.

James G. Murphy Co.
PO Box 82160
Kenmore, Washington 98028
1-800-426-3008
Oregon Office:
105 McNary Estates Dr. N
Keizer, Oregon 97303
(503) 463-4444
murphyauction.com

- 9. PACKAGE SAW: LOTS 811-819
- 10. BAGHOUSE AREA: LOTS 820-932
- 11. CHIP BIN AREA: LOTS 833-839
- 12. WAREHOUSE AREA: LOTS 840-859B
- 13. SAWMILL GROUND LEVEL: LOTS 860-1000
- 14. MILL PARTS AREA: LOTS 1001-1100
- 15. WAREHOUSE AREA: LOTS 1101-1225
- 16. FUELING AREA: LOTS 1226-1275
- 17. BONEYARD: LOTS 1251-1275
- 18. ROLLING STOCK: LOTS 2002-2014
- 19. SORTER AT PLYWOOD MILL: LOTS 2015-2024
- 20. KILNS & BOILER AT GLIDE, OR: LOTS 2025-2037

- A. OFFICE
- B. AUCTION AREA
- C. BATHROOMS
- D. SMOKING AREA
- 1. START OF SALE: LOTS 1-200
- 2. LPC BUILDING: LOTS 201-287
- 3. LOG DECK AREA: LOTS 208-334 & 353-365
- 4. DLJ BUILDING BASEMENT: LOTS 335-352
- 5. HOG & BINS AREA: LOTS 353-384
- 6. FILING ROOM: LOTS 391-470
- 7. LARGE LOG MILL UPSTAIRS: LOTS 471-620
- 8. PLANER MILL: LOTS 621-810

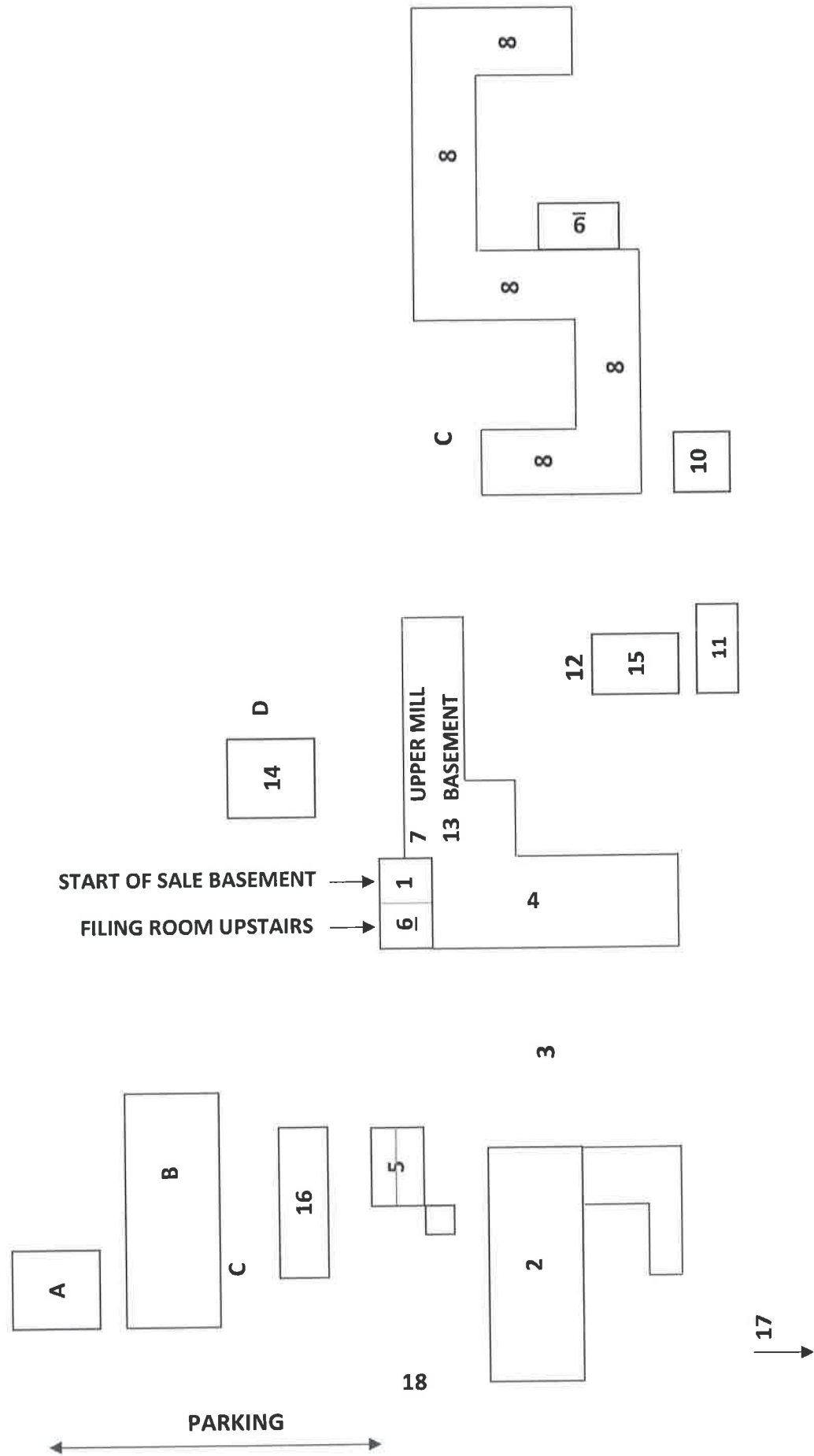



James G. Murphy Co.
P.O. Box 82160
Kenmore, WA 98028
1-800-426-3008
murphyauction.com

SWANSON GROUP GLENDALE SAWMILL - LIVE AUCTION 8/7/2019

LOTS 2002-2037 ROLLING STOCK & EQUIPMENT LOCATED OFFSITE TO BE SOLD AT 1 PM

<u>LOT #</u>	<u>LOT #</u>
2002 1980 CAT 988B RUBBER TIRE LOADER W/MEDFORD LOG FORKS, CAT 3408 DIESEL ENGINE, BRIDGESTONE 35/65R33 TIRES, HRS:12,908 VIN / Serial: 50W05156	2007 2004 HYSTER H190HD 16,050 LB CAPACITY FORKLIFT, DIESEL, 212-1/2" 2-STAGE MAST, FORK POSITIONERS, SIDE SHIFT, 15" X 54" FORKS, DUAL SOLID TIRES, HRS:14,058 VIN / Serial: G007E01740B
2003 2006 SENNEBOGEN 825 RUBBER TIRE MATERIAL HANDLER LOG LOADER W/DEUTZ BF6M1013 6-CYLINDER 150KW DIESEL ENGINE, MYRMO ROTARY LOG GRAPPLES, 45' BOOM MAX REACH, (8) SOLID 10.00-20 TIRES, OUTRIGGERS, HRS:16,719 VIN / Serial: 8250628	2008 1998 HYSTER H190XL 15,800 LB CAPACITY FORKLIFT, DIESEL, 286.6" 2-STAGE MAST, FORK POSITIONERS, SIDE SHIFT, 15" X 48" FORKS, DUAL SOLID TIRES, HRS:8,915 VIN / Serial: E007D03648V
2004 1998 HYSTER H230XL 23,600 LB CAPACITY FORKLIFT, DIESEL, MONOTROL, 183" 2-STAGE MAST W/FORK POSITIONERS, SIDE SHIFT, 15" X 48" FORKS, DUAL SOLID TIRES, HRS:6,714 VIN / Serial: E007D03540V	2009 1996 HYSTER H190XL 19,000 LB CAPACITY FORKLIFT, DIESEL, MONOTROL, 183" 2-STAGE MAST, FORK POSITIONERS, SIDE SHIFT, 15" X 54" FORKS, DUAL SOLID TIRES, HRS:1,190 VIN / Serial: E007D02735T
2005 2001 HYSTER H210HD 19,050 LB CAPACITY FORKLIFT, DIESEL, MONOTROL, 183" 2-STAGE MAST W/FORK POSITIONERS, SIDE SHIFT, 15" X 48" FORKS, DUAL SOLID TIRES, HRS:12,587 VIN / Serial: F007E01658Y	2010 1994 HYSTER H190XL 19,000 LB CAPACITY FORKLIFT, DIESEL, MONOTROL, 183" 2-STAGE MAST, FORK POSITIONERS, SIDE SHIFT, 15" X 54" FORKS, DUAL SOLID TIRES, HRS:6,277 VIN / Serial: E007D1754R
2006 2001 HYSTER H210HD 19,050 LB CAPACITY FORKLIFT, DIESEL, MONOTROL, 183" 2-STAGE MAST W/FORK POSITIONERS, SIDE SHIFT, 15" X 48" FORKS, DUAL SOLID TIRES, HRS:34,416 VIN / Serial: F007E01660Y	2011 1994 HYSTER H190XL 19,000 LB CAPACITY FORKLIFT, DIESEL, MONOTROL, 183" 2-STAGE MAST, FORK POSITIONERS, SIDE SHIFT, 15" X 54" FORKS, DUAL SOLID TIRES, HRS:9,401 VIN / Serial: E007D1758R

10% BUYERS PREMIUM ON ALL ITEMS
15% BUYERS PREMIUM ON ALL ONLINE PURCHASES

James G. Murphy Co.

SWANSON GROUP GLENDALE SAWMILL - LIVE AUCTION 8/7/2019

LOT #**2012 1999 HYSTER H155XL2**

14,400 LB CAPACITY FORKLIFT, DIESEL, 212"
2-STAGE MAST, 10" X 48" FORKS, SIDE SHIFT, SOLID
TIRES, HRS:7,387
VIN / Serial: F006D05791X

2013 1995 HYSTER H80XL

7,500 LB CAPACITY FORKLIFT, PROPANE,
MONOTROL, 171-1/2" 3-STAGE MAST, SIDE SHIFT, 9"
X 48" FORKS, SOLID TIRES, HRS:3,100+
VIN / Serial: G005D005283

2014 -

**2014Z LOTS 2015-2022 ARE LOCATED AT PLYWOOD
MILL IN
GLENDALE OREGON, YOU MUST MAKE AN APPT TO
PREVIEW & BUYERS ARE SOLELY RESPONSIBLE
FOR THE REMOVAL & SECURITY OF THESE LOTS &
MUST ABIDE BY ALL SITE RULES, ALL LOTS ARE
LOCATED BY FUELING STATIONS**

2015 HI-TECH

24' 42-BIN PUSH LUG SORTER, 120' 6-STRAND
LUGGED TRANSFER, (4) 30' 6-STRAND TAKE AWAY
TRANSFERS LOTS 2015-2022 ARE LOCATED AT
PLYWOOD MILL IN GLENDALE OREGON, YOU MUST
MAKE AN APPT TO PREVIEW & BUYERS ARE
SOLELY RESPONSIBLE FOR THE REMOVAL &
SECURITY OF THESE LOTS & MUST ABIDE BY ALL
SITE RULES, ALL LOTS ARE LOCATED BY FUELING
STATIONS

2016 TOSHIBA

10 HP MOTOR TO REX ATLAS 55 RPM REDUCER
(LOCATED BY FUEL EMERGENCY SHUT OFF) LOTS
2015-2022 ARE LOCATED AT PLYWOOD MILL IN
GLENDALE OREGON, YOU MUST MAKE AN APPT TO
PREVIEW & BUYERS ARE SOLELY RESPONSIBLE
FOR THE REMOVAL & SECURITY OF THESE LOTS &
MUST ABIDE BY ALL SITE RULES, ALL LOTS ARE
LOCATED BY FUELING STATIONS

LOT #**2017 TOSHIBA**

10 HP MOTOR TO REX ATLAS 55 RPM REDUCER
(LOCATED BY FUEL EMERGENCY SHUT OFF) LOTS
2015-2022 ARE LOCATED AT PLYWOOD MILL IN
GLENDALE OREGON, YOU MUST MAKE AN APPT TO
PREVIEW & BUYERS ARE SOLELY RESPONSIBLE
FOR THE REMOVAL & SECURITY OF THESE LOTS &
MUST ABIDE BY ALL SITE RULES, ALL LOTS ARE
LOCATED BY FUELING STATIONS

2018 TOSHIBA

5 HP MOTOR TO REX MERCURY 126 RPM REDUCER
(LOCATED BY FUEL EMERGENCY SHUT OFF) LOTS
2015-2022 ARE LOCATED AT PLYWOOD MILL IN
GLENDALE OREGON, YOU MUST MAKE AN APPT TO
PREVIEW & BUYERS ARE SOLELY RESPONSIBLE
FOR THE REMOVAL & SECURITY OF THESE LOTS &
MUST ABIDE BY ALL SITE RULES, ALL LOTS ARE
LOCATED BY FUELING STATIONS

2019 TOSHIBA

10 HP MOTOR TO REX ATLAS 55 RPM REDUCER
(LOCATED BY PROPANE TANK) LOTS 2015-2022 ARE
LOCATED AT PLYWOOD MILL IN GLENDALE
OREGON, YOU MUST MAKE AN APPT TO PREVIEW &
BUYERS ARE SOLELY RESPONSIBLE FOR THE
REMOVAL & SECURITY OF THESE LOTS & MUST
ABIDE BY ALL SITE RULES, ALL LOTS ARE
LOCATED BY FUELING STATIONS

2020 TOSHIBA

10 HP MOTOR TO REX ATLAS 55 RPM REDUCER
(LOCATED BY PROPANE TANK) LOTS 2015-2022 ARE
LOCATED AT PLYWOOD MILL IN GLENDALE
OREGON, YOU MUST MAKE AN APPT TO PREVIEW &
BUYERS ARE SOLELY RESPONSIBLE FOR THE
REMOVAL & SECURITY OF THESE LOTS & MUST
ABIDE BY ALL SITE RULES, ALL LOTS ARE
LOCATED BY FUELING STATIONS

2021 TOSHIBA

10 HP MOTOR TO REX ATLAS 55 RPM REDUCER
(LOCATED BY PROPANE TANK) LOTS 2015-2022 ARE
LOCATED AT PLYWOOD MILL IN GLENDALE
OREGON, YOU MUST MAKE AN APPT TO PREVIEW &

SWANSON GROUP GLENDALE SAWMILL - LIVE AUCTION 8/7/2019

LOT #

BUYERS ARE SOLELY RESPONSIBLE FOR THE REMOVAL & SECURITY OF THESE LOTS & MUST ABIDE BY ALL SITE RULES, ALL LOTS ARE LOCATED BY FUELING STATIONS

2022 TOSHIBA

10 HP MOTOR TO REX ATLAS 55 RPM REDUCER (LOCATED BY PROPANE TANK) LOTS 2015-2022 ARE LOCATED AT PLYWOOD MILL IN GLENDALE OREGON, YOU MUST MAKE AN APPT TO PREVIEW & BUYERS ARE SOLELY RESPONSIBLE FOR THE REMOVAL & SECURITY OF THESE LOTS & MUST ABIDE BY ALL SITE RULES, ALL LOTS ARE LOCATED BY FUELING STATIONS

2023 -**2024 -****2024Z LOTS 2025-2037 ARE LOCATED AT**

1577 GLIDE LP DR IN GLIDE OREGON, MUST MAKE AN APPT TO PREVIEW, BUYERS OF THESE LOTS ARE SOLELY RESPONSIBLE FOR THE REMOVAL & SECURITY OF ALL MATERIALS & SECURITY OF THESE LOTS & MUST ABIDE BY ALL SITE RULES)

2025 WELLONS

(2) 40' X 66' DOUBLE TRACK KILNS & (2) 18' X 66' SINGLE TRACK KILNS W/(6) 6" INDIVIDUALLY MOTORIZED FANS PER KILN, (2) ALLEN BRADLEY POWERFLEX 700 DRIVES, CONTROLS & ELECTRICS, KILN CONTROL HOUSE (NO WIRE OUTSIDE OF KILNS, KILN RAIL OR COOLING SHEDS OR STEAM PIPING TO BOILER HOUSE WALL) LOTS 2025-2037 ARE LOCATED AT 1577 GLIDE LP DR IN GLIDE OREGON, MUST MAKE AN APPT TO PREVIEW, BUYERS OF THESE LOTS ARE SOLELY RESPONSIBLE FOR THE REMOVAL & SECURITY OF ALL MATERIALS & SECURITY OF THESE LOTS & MUST ABIDE BY ALL SITE RULES)

2026 LOT, APPROX (50) SQUARE TUBE & I-BEAM FRAMED 8'L

X 9'W KILN CARTS W/6' CENTER-TO-CENTER ON WHEELS LOTS 2025-2037 ARE LOCATED AT 1577 GLIDE LP DR IN GLIDE OREGON, MUST MAKE AN

LOT #

APPT TO PREVIEW, BUYERS OF THESE LOTS ARE SOLELY RESPONSIBLE FOR THE REMOVAL & SECURITY OF ALL MATERIALS & SECURITY OF THESE LOTS & MUST ABIDE BY ALL SITE RULES)

2027 APPROX 11,500 GALLON DOUBLE WALL DIESEL

FUEL TANK
W/TOKHEIM PUMP LOTS 2025-2037 ARE LOCATED AT 1577 GLIDE LP DR IN GLIDE OREGON, MUST MAKE AN APPT TO PREVIEW, BUYERS OF THESE LOTS ARE SOLELY RESPONSIBLE FOR THE REMOVAL & SECURITY OF ALL MATERIALS & SECURITY OF THESE LOTS & MUST ABIDE BY ALL SITE RULES)

2028 1976 FRUEHAUF

8'W X 8-1/2'H X 20'L CARGO CONTAINER W/BARN DOORS & INTERIOR WALL W/MAN DOOR LOTS 2025-2037 ARE LOCATED AT 1577 GLIDE LP DR IN GLIDE OREGON, MUST MAKE AN APPT TO PREVIEW, BUYERS OF THESE LOTS ARE SOLELY RESPONSIBLE FOR THE REMOVAL & SECURITY OF ALL MATERIALS & SECURITY OF THESE LOTS & MUST ABIDE BY ALL SITE RULES)

2029 KEELER NO. 2182

WOOD FIRED BOILER, 300 HP, 15,350 LBS/HR, 300 PSI RATED, OPERATED AT 150 PSI, 60" WELLONS FUEL CELL, REFRACTORY LINED, AIR HEATER FOLLOWED BY MULTICLONE, UNDER FIRE AIR, OVER FIRE, ID & FD FANS, FLY ASH RECOVERY, FUEL CONVEYORS, PLC CONTROLLED WATER LOTS 2025-2037 ARE LOCATED AT 1577 GLIDE LP DR IN GLIDE OREGON, MUST MAKE AN APPT TO PREVIEW, BUYERS OF THESE LOTS ARE SOLELY RESPONSIBLE FOR THE REMOVAL & SECURITY OF ALL MATERIALS & SECURITY OF THESE LOTS & MUST ABIDE BY ALL SITE RULES)

2030 WELLONS

APPROX 30-UNIT FUEL SILO W/MARKED CONVEYORS & ELECTRICS LOTS 2025-2037 ARE LOCATED AT 1577 GLIDE LP DR IN GLIDE OREGON, MUST MAKE AN APPT TO PREVIEW, BUYERS OF THESE LOTS ARE SOLELY RESPONSIBLE FOR THE REMOVAL & SECURITY OF ALL MATERIALS &

SWANSON GROUP GLENDALE SAWMILL - LIVE AUCTION 8/7/2019

LOT #

SECURITY OF THESE LOTS & MUST ABIDE BY ALL SITE RULES)

2031 APPROX 15-UNIT AIR OPERATED BARK BIN

LOTS 2025-2037 ARE LOCATED AT 1577 GLIDE LP DR IN GLIDE OREGON, MUST MAKE AN APPT TO PREVIEW, BUYERS OF THESE LOTS ARE SOLELY RESPONSIBLE FOR THE REMOVAL & SECURITY OF ALL MATERIALS & SECURITY OF THESE LOTS & MUST ABIDE BY ALL SITE RULES)

2032 APPROX 88' 2-STRAND 8" X 12" BOX

CHAIN INFEED
CONVEYOR W/H&T SPROCKETS, STEEL TROUGH, RETURN CATWALK & STAIRS LOTS 2025-2037 ARE LOCATED AT 1577 GLIDE LP DR IN GLIDE OREGON, MUST MAKE AN APPT TO PREVIEW, BUYERS OF THESE LOTS ARE SOLELY RESPONSIBLE FOR THE REMOVAL & SECURITY OF ALL MATERIALS & SECURITY OF THESE LOTS & MUST ABIDE BY ALL SITE RULES)

2033 APPROX 66' 2-STRAND 8" X 12" BOX

CHAIN INFEED
CONVEYOR W/H&T SPROCKETS, STEEL TROUGH, RETURN & CATWALK LOTS 2025-2037 ARE LOCATED AT 1577 GLIDE LP DR IN GLIDE OREGON, MUST MAKE AN APPT TO PREVIEW, BUYERS OF THESE LOTS ARE SOLELY RESPONSIBLE FOR THE REMOVAL & SECURITY OF ALL MATERIALS & SECURITY OF THESE LOTS & MUST ABIDE BY ALL SITE RULES)

2034 SKK

15 HP/30 RPM DOUBLE REDUCTION GEARHEAD MOTOR W/DRIVE CHAIN (DRIVE FOR LOT 2032)
LOTS 2025-2037 ARE LOCATED AT 1577 GLIDE LP DR IN GLIDE OREGON, MUST MAKE AN APPT TO PREVIEW, BUYERS OF THESE LOTS ARE SOLELY RESPONSIBLE FOR THE REMOVAL & SECURITY OF ALL MATERIALS & SECURITY OF THESE LOTS & MUST ABIDE BY ALL SITE RULES)

2035 SKK

15 HP/30 RPM DOUBLE REDUCTION GEARHEAD MOTOR W/DRIVE CHAIN (DRIVE FOR LOT 2033)
LOTS 2025-2037 ARE LOCATED AT 1577 GLIDE LP DR IN GLIDE OREGON, MUST MAKE AN APPT TO

LOT #

PREVIEW, BUYERS OF THESE LOTS ARE SOLELY RESPONSIBLE FOR THE REMOVAL & SECURITY OF ALL MATERIALS & SECURITY OF THESE LOTS & MUST ABIDE BY ALL SITE RULES)

2036 LOT, WIRE & CONDUIT FROM POWER DISTRIBUTION

CENTER (NOT IN SALE) TO LOTS 2025, 2029 & 2030 (NO WIRE INSIDE ANY BUILDINGS) LOTS 2025-2037 ARE LOCATED AT 1577 GLIDE LP DR IN GLIDE OREGON, MUST MAKE AN APPT TO PREVIEW, BUYERS OF THESE LOTS ARE SOLELY RESPONSIBLE FOR THE REMOVAL & SECURITY OF ALL MATERIALS & SECURITY OF THESE LOTS & MUST ABIDE BY ALL SITE RULES)

2037 LOT, ASSORTED METAL IN THIS AREA

LOTS 2025-2037 ARE LOCATED AT 1577 GLIDE LP DR IN GLIDE OREGON, MUST MAKE AN APPT TO PREVIEW, BUYERS OF THESE LOTS ARE SOLELY RESPONSIBLE FOR THE REMOVAL & SECURITY OF ALL MATERIALS & SECURITY OF THESE LOTS & MUST ABIDE BY ALL SITE RULES)



James G. Murphy Co.
P.O. Box 82160
Kenmore, WA 98028
1-800-426-3008
murphyauction.com

SWANSON GROUP GLENDALE SAWMILL - LIVE AUCTION 8/7/2019

<u>LOT #</u>		<u>LOT #</u>	
1	HUSQVARNA 455 RANCHER GAS CHAIN SAW W/26" BAR	11	DEWALT D28474 9" ANGLE GRINDER, 8,000 RPM
2	HUSQVARNA 455 RANCHER GAS CHAIN SAW W/26" BAR	12	DEWALT D28474 9" ANGLE GRINDER, 8,000 RPM
3	HUSQVARNA 455 RANCHER GAS CHAIN SAW W/26" BAR	13	MILWAUKEE 9" ANGLE GRINDER, 5,000 RPM
4	HUSQVARNA 240X TORQ GAS CHAIN SAW W/16" BAR	14	MILWAUKEE 7"/9" ANGLE GRINDER, 6,000 RPM
5	CHAMPION MINI BRUTE AC35 MAG DRILL	15	MILWAUKEE 7"/9" ANGLE GRINDER, 6,000 RPM
6	JANCY USA 5000 SLUGGER MAG DRILL	16	DEWALT 28114 4-1/2" ANGLE GRINDER, 11,000 RPM
7	DEWALT DW715 12" COMPOUND MITRE SAW (UNUSED)	17	DEWALT 28114 4-1/2" ANGLE GRINDER, 11,000 RPM
8	MILWAUKEE 6536-21 SAWZALL	18	SKILSAW 7-1/4" WORM DRIVE SAW, 4,400 RPM
9	MILWAUKEE 6536-21 SAWZALL	19	CRAFTSMAN 7-1/4" CIRCULAR SAW, 5,000 RPM
10	MILWAUKEE 6536-21 SAWZALL	20	MILWAUKEE 14" CHOP SAW, 1,100 RPM

10% BUYERS PREMIUM ON ALL ITEMS
15% BUYERS PREMIUM ON ALL ONLINE PURCHASES

James G. Murphy Co.

SWANSON GROUP GLENDALE SAWMILL - LIVE AUCTION 8/7/2019

LOT #	LOT #
21 MILWAUKEE M18 RED LITHIUM DRILL W/BATTERIES & CHARGER	32 PROTO J6012C MICROMETER TORQUE WRENCH TO 100 FT/LBS
22 DEWALT 18V-XRP LOT, DRILL W/(3) BATTERIES, (2) CHARGERS & CASE	33 LOT, ASSORTED SOCKETS
23 INGERSOLL RAND 3/4" AIR IMPACT WRENCH	34 LOT, ASSORTED PULLERS ON TABLE
24 INGERSOLL RAND QUIMAX 3/4" AIR IMPACT WRENCH	35 LOT, ASSORTED PULLERS UNDER TABLE
25 INGERSOLL RAND IMPACT TOOL 1/2" AIR IMPACT WRENCH	36 LOT, ASSORTED PRY BARS & SPLITTER BAR
26 INGERSOLL RAND IMPACT TOOL 1/2" AIR IMPACT WRENCH	37 LOG TONG
27 INGERSOLL RAND 231C 1/2" AIR IMPACT WRENCH	38 LOG TONG
28 SPEEDAIRE 21AA64 LOT, (2) 3/8" AIR RATCHETS	39 LOG TONG
29 SPEEDAIRE 21AA64 LOT, (2) 3/8" AIR RATCHETS	40 LOT, ASSORTED C-CLAMPS
30 PROTO 6212 TORQUE MULTIPLIER TO 1,200 FT/LBS	41 BLOCK W/HOOK
31 PROTO J6014C MICROMETER TORQUE WRENCH TO 240 FT/LBS	42 WEBER FAST TAGGER
	43 STOODY POWDER GUN
	44 LOT, CUTTING TORCH W/GAUGES, ASSORTED GAUGES & WELDING SUPPLIES
	45 LOT, (3) BOTTLE JACKS
	46 LOT, (4) BOTTLE JACKS
	47 MERRILL BROS. 2 TON, 0"-1" PLATE CLAMP

SWANSON GROUP GLENDALE SAWMILL - LIVE AUCTION 8/7/2019

LOT #	LOT #
48 MITUTOYO 2"-3" MICROMETER	59 LOT, ASSORTED DRILL BITS
49 MITUTOYO 1"-2" MICROMETER	60 LOT, ASSORTED DRILL BITS
50 MITUTOYO 0"-1" MICROMETER	61 LOT, ASSORTED DRILL BITS
51 WESTLUND 0"-1" MICROMETER	62 LOT, ASSORTED DRILL BITS
52A MITUTOYO 5"-6" INSIDE MICROMETER	63 LOT, ASSORTED DRILL BITS
52B STARRETT NO. 98 PRECISION LEVEL	64 UNION BUTTERFIELD LOT, TAPS
53 LOT, (2) DIGITAL CALIPERS	65 LOT, ASSORTED TOOLING
54 MITUTOYO LOT, (2) MAGNETIC BASES W/(3) DIAL INDICATORS	66 LOT, ASSORTED PUNCHES
55 STUHR BALANCER	67 RIDGID 300 PIPE THREADER ON STAND W/FOOT PEDAL & OILER
56 WARN PULZ-ALL 1/2 TON, 110V ELECTRIC CABLE WINCH	68 LOT, ASSORTED TAPS
57 DAREX DRILL DOCTOR	69 LOT, ASSORTED THREADING TOOLS
58 LOT, EXPANDABLE HONES TO 1-1/2"	70 APPROX 1-1/2"THICK X 54"WIDE X 108"LONG STEEL TABLE (MUST BE EMPTY TO REMOVE)
	71 APPROX 3/4"THICK X 60"WIDE X 120"LONG STEEL TABLE (MUST BE EMPTY TO REMOVE)
	72 8" SWIVEL BASE VISE
	73 5" SWIVEL BASE VISE
	74 APPROX 1"THICK X 48"WIDE X 56"LONG STEEL TABLE ON CASTERS (MUST BE EMPTY TO REMOVE)

SWANSON GROUP GLENDALE SAWMILL - LIVE AUCTION 8/7/2019

LOT #	LOT #
75 RUTLAND 26660630	83 DAYTON 4Z123F
MILLING & DRILLING MACHINE, 50-2,500 RPM, JACOBS 1/8"-5/8" CHUCK, 8" X 28" T-SLOT TABLE W/6" VISE, 2 HP/220V VIN / Serial: 531979	6" DOUBLE END BENCH GRINDER, 1/3 HP/115V
76 JET J-2550	84 CAROLINA HV12
20" DRILL PRESS, T-SLOT TABLE W/8" VISE, 1 HP/115-230V VIN / Serial: 354402	HORIZONTAL/VERTICAL METAL CUTTING BANDSAW, 13"W X 8-1/2"H MATERIAL CAPACITY, 115V VIN / Serial: 10404
77 SHEN JANG 916	85 LINCOLN RANGER 9
HORIZONTAL METAL CUTTING BANDSAW, 1-1/2 HP/115V	PORTABLE GAS WELDER/GENERATOR W/ONAN 18 GAS ENGINE, 250 AMP AC WELDER, 9,000 WATT/115-230V GENERATOR, CART MOUNTED W/OXY-ACETYLENE TORCH SET, LEADS & GROUND
78 PFS	86 MILLER BOBCAT 225
OIL FILTER CART W/BALDOR 1 HP/115-230V MOTOR	PORTABLE GAS WELDER/GENERATOR W/ONAN PERFORMER 16XSL GAS ENGINE, 225 AMP AC/DC WELDER, 8,500 WATT/120-240V GENERATOR W/OXY-ACETYLENE HOSE, LEADS & GROUND, SKID MOUNTED
79A GOODWAY	87A LINCOLN IDEALARC R3R-400
1-1/2 HP/115V INDUSTRIAL SHOP VAC	400 AMP DC WELDER W/LEADS, GROUND & STAND
79B RIDGID SNR	87B LINCOLN IDEALARC R3R-400
6-1/2 HP/16 GALLON SHOP VAC	400 AMP DC WELDER W/LEADS, GROUND, ON CART
80 ALKOTA 112	88 MILLER XMT304
ROTARY PARTS CLEANER W/26" TURNTABLE, 500 L CAPACITY, 32" WORK HEIGHT, 50 GALLON TANK (NO DISCONNECT) VIN / Serial: CM-2075	CC/CV DC INVERTER AC WELDER W/AUTO LINK, MILLER 22A WIRE FEEDER MOUNTED ON CART
81 ENERPAC	89 MILLER MILLERMATIC
100/50 TON HYDRAULIC OPERATED SHOP PRESS W/10,000 PSI PUMP, 115V	250 AMP WIRE WELDER ON WHEELS
81Z SALE MOVES TO GREEN SUPPORT POST	90 MILLER MILLERMATIC 211
82 DAYTON 4Z9128	AUTO SET W/MVP 120/230V WIRE WELDER ON CART
10" DOUBLE END BENCH GRINDER, 1 HP/115V (NO DISCONNECT)	

SWANSON GROUP GLENDALE SAWMILL - LIVE AUCTION 8/7/2019

LOT #	LOT #
91 LINCOLN LN25 WIRE FEEDER ON CART	102 AIR HOSE REEL
92 MILLER MAXSTAR 150S 115/230V WELDER	103 AIR HOSE REEL
93A MILLER SPECTRUM PLUS DC PLASMA CUTTER	104 LOT, GREEN STEEL SHELF W/MARKED WALL HANGERS
93B HYPERTHERM POWERMAX 45P PLASMA CUTTER W/CART	105 CM LODESTAR 1 TON ELECTRIC CHAIN HOIST W/TROLLEY (NO RAIL)
94 LINCOLN IDEALARC 250 AC/DC WELDER W/LEADS	106 COFFING 3 TON CHAIN COME-ALONG
95 COX REELS OXY-ACETYLENE HOSE REEL W/HOSE & GAUGES	107 COFFING 3 TON CHAIN COME-ALONG
96 COX REELS OXY-ACETYLENE HOSE REEL W/HOSE & GAUGES	108 DAYTON 1-1/2 TON CHAIN COME-ALONG
97A LOT, WELDING LEADS	109 JET 1-1/2 TON CHAIN COME-ALONG
97B LOT, ARC AIRS	110 DAYTON 3/4 TON CHAIN COME-ALONG
98 LOT, OXY-ACETYLENE HOSE, GAUGES & CART	111 DAYTON 3/4 TON CHAIN COME-ALONG
99 BOTTLE CART	112 DAYTON 3/4 TON CHAIN COME-ALONG
100 JUST RITE 12 GALLON CAPACITY FLAMMABLES CABINET	113 COFFING 3/4 TON CHAIN COME-ALONG
101 LOT, ASSORTED SLEDGE HAMMERS HANGING ON THE WALL	

SWANSON GROUP GLENDALE SAWMILL - LIVE AUCTION 8/7/2019

<u>LOT #</u>	<u>LOT #</u>
114 COFFING 3/4 TON CHAIN COME-ALONG	127 APPROX 10' X 3/8" RIGGING CHAIN, 5,700 LB CAPACITY
115 OZ 3/4 TON CHAIN COME-ALONG	128 APPROX 10' X 3/8" RIGGING CHAIN, 5,700 LB CAPACITY
116 TUFF TUG 2,500 LB SINGLE LINE CABLE COME-ALONG	129 APPROX 10' X 3/8" RIGGING CHAIN, 5,700 LB CAPACITY
117 LOT, ASSORTED WELDING WIRE & ROD	130 APPROX 10' X 3/8" RIGGING CHAIN, 5,700 LB CAPACITY
118 WILTON 4-1/2" SWIVEL BASE VISE	131 APPROX 10' X 3/8" RIGGING CHAIN, 5,700 LB CAPACITY
119 LOT, ASSORTED BEARINGS & MISC UNDER BENCH (NO STEEL STOCK)	132 APPROX 10' X 3/8" RIGGING CHAIN, 5,700 LB CAPACITY
120 -	133 APPROX 10' X 3/8" RIGGING CHAIN, 5,700 LB CAPACITY
121 DAYTON 30" FAN W/1/2 HP/115V MOTOR	134 LOT, (6) RIGGING CHAINS
122 DAYTON 30" FAN W/1/2 HP/115V MOTOR	135 LOT, STEEL CABINET W/ASSORTED CONTENTS
123 LOT, ASSORTED STEEL SHAFTING, STEEL STOCK, THREADED ROD & ROLLS (NO RACK)	136 LOT, STEEL CABINET ON WHEELS W/ASSORTED CONTENTS
124 ROD BOX W/ROD	137 LOT, STEEL CABINET W/ASSORTED RIGGING
125 -	138 LOT, STEEL CABINET W/ASSORTED CONTENTS
126 APPROX 12' X 3/8" RIGGING CHAIN, 8,800 LB CAPACITY	139 LOT, 56-COMPARTMENT BOLT BIN W/CONTENTS

SWANSON GROUP GLENDALE SAWMILL - LIVE AUCTION 8/7/2019

<u>LOT #</u>	<u>LOT #</u>
140 LOT, 56-COMPARTMENT BOLT BIN W/CONTENTS	152 LOUISVILLE 12' FIBERGLASS STEP LADDER
141 LOT, 56-COMPARTMENT BOLT BIN W/CONTENTS	153 WERNER 10' FIBERGLASS STEP LADDER
142 LOT, 56-COMPARTMENT BOLT BIN W/CONTENTS	154 WERNER 8' FIBERGLASS STEP LADDER
143 LOT, 56-COMPARTMENT BOLT BIN W/CONTENTS	155 WERNER 6' FIBERGLASS STEP LADDER
144 HONEYWELL EMERGENCY EYEWASH STATION	156 WERNER 4' FIBERGLASS STEP LADDER
145 SPEEDAIRE TANK MOUNTED COMPRESSOR W/APPROX 1 HP MOTOR, 8.3 CFM AT 90 PSI, 30 GALLON TANK, 230V	157 HAND TRUCK
146 SIGNODE LOT, (2) AIR BANDERS W/CRIMPING TOOLS	158 HAND TRUCK
147 SIGNODE LOT, (3) AIR BANDERS	159 HAND TRUCK
148 ARO PNEUMATIC PUMP	160 HAND TRUCK
148Z SALE MOVES OUTSIDE	161 LOT, (2) WHEELBARROWS
149 LINCOLN EAGLE SERIES 4,000 LB ENGINE HOIST	162 LOT, (2) WHEELBARROWS
150 TRI-ARC 350 LB ROLLING WAREHOUSE LADDER	163 LOT, (2) WHEELBARROWS
151 COTTERMAN 350 LB ROLLING WAREHOUSE LADDER	164 -
	165 -
	166 -
	167 -

SWANSON GROUP GLENDALE SAWMILL - LIVE AUCTION 8/7/2019

<u>LOT #</u>	<u>LOT #</u>
168 -	189 -
169 -	190 -
170 -	191 -
171 -	192 -
172 -	193 -
173 -	194 -
174 -	195 -
175 -	196 -
176 -	197 -
177 -	198 -
178 -	199 -
179 -	200 -
180 -	201 50'W X 32'L 7-STRAND WR132 SPLIT INFEEED LOG DECK, S-DRIVE, STEEL PLATE & SUPPORTS TO GROUND (NO FRONT LEGS TO GROUND)
181 -	
182 -	202 50'W X 16'L 7-STRAND WR132 SPLIT INFEEED LOG DECK, S-DRIVE, CONVEYOR TO SLOPING TO VIBRATORY CONVEYORS, SUPPORTS TO GROUND, STEEL WALLS & PLATFORMS TO QUADRANT FEEDER
183 -	
184 -	
185 -	203 -
186 -	204 -
187 -	205 WEG
188 -	7-1/2 HP/1,765 RPM MOTOR TO REX NEPTUNE 91.41:1 RATIO REDUCER W/DRIVE CHAIN (DRIVE FOR LOT 201)

SWANSON GROUP GLENDALE SAWMILL - LIVE AUCTION 8/7/2019

LOT #	LOT #
206 WEG	214 BALDOR
7-1/2 HP/1,765 RPM MOTOR TO REX NEPTUNE 91.41:1 RATIO REDUCER W/DRIVE CHAIN (DRIVE FOR LOT 201)	40 HP MOTOR TO REX EARTH 126 RPM REDUCER (NO DATA) W/DRIVE CHAIN (DRIVE FOR LOT 212)
207 GE	215 BALDOR
LOT, (8) 30 AMP DISCONNECTS UNDER LOG DECK LOT 201 (NO WIRE OUTSIDE OF BOX)	40 HP MOTOR TO REX EARTH 126 RPM REDUCER (NO DATA) W/DRIVE CHAIN (DRIVE FOR LOT 213)
208 GE	216 GE
LOT, (3) 100 AMP & (2) 30 AMP DISCONNECTS UNDER LOG DECK LOT 202 (NO WIRE OUTSIDE OF BOX)	LOT, (1) 100 AMP & (5) 60 AMP DISCONNECTS (NO WIRE OUTSIDE OF BOX)
209 HYDRAULIC UNIT W/(2) BALDOR 60 HP MOTORS TO VICKERS PUMPS, HTS & AMERICAN HEAT EXCHANGERS, CHROMALOX TANK HEATER, TRAY, APPROX 500 GALLON TANK (NO HYDRAULIC LINES)	217 GE
	LOT, (1) 200 AMP & (5) 30 AMP DISCONNECTS W/WELDING PLUG (NO WIRE OUTSIDE OF BOX)
209Z SALE MOVES UPSTAIRS	217Z SALE MOVES TO DEBARKER (NOT IN SALE) OUTFEED AREA
210 2004 LINDEN DQ436X55	218 APPROX 42' LOG STOP & LOADER GATE W/MARKED STEEL PLATE, CATWALK & MARKED SUPPORTS
60' DOUBLE ACTING QUADRANT FEEDER W/BALDOR 40 HP MOTOR, HYDRAULIC OPERATED 60' 3-SECTION LOG STOP & LOADER, MARKED SUPPORTS	219 LINDEN
211 1999 STROHM L0-66	42' SINGLE ACTING HYDRAULIC OPERATED QUADRANT FEEDER W/2005 HTS 800 GALLON HYDRAULIC UNIT W/(3) 75 HP MOTORS TO VICKERS PUMPS W/HEAT EXCHANGER (BUILDING MUST REMAIN INTACT)
60" INSERT TOOTH WHOLE LOG CUT OFF SAW W/TOSHIBA 75 HP/1,188 RPM MOTOR, FRAME TO CATWALK	219Z SALE MOVES TO MERCHANDISER LINE
212 APPROX 65' 4-STRAND WR124XHD CHAIN INFEED LOG HAUL, S-DRIVE, PORTER SCANNER SENSORS, CATWALK & MARKED SUPPORTS	220 2000 USNR
213 34' 4-STRAND WR124XHD OUTFEED LOG HAUL, DEBARKER INFEED HOURGLASS ROLL & MARKED SUPPORTS	72" INSERT TOOTH TEMPOSONIC POSITIONED SAW MODULE W/TEMPOSONIC CYLINDER, BALDOR 75 HP/1,185 RPM MOTOR, PRE-SET FENCE, (1) LOG CLAMP, DIVERTER ARM & 34" HYDRAULIC DRIVEN HOURGLASS ROLL, SAW HYDRAULICS MOUNTED ON POWER TRACK SYSTEM

SWANSON GROUP GLENDALE SAWMILL - LIVE AUCTION 8/7/2019

LOT #**221 2000 USNR**

72" INSERT TOOTH TEMPOSONIC POSITIONED SAW MODULE W/TEMPOSONIC CYLINDER, BALDOR 60 HP/1,185 RPM MOTOR, (2) LOG CLAMPS, DIVERTER ARM & 34" HYDRAULIC DRIVEN HOURGLASS ROLLS, SAW HYDRAULICS MOUNTED ON POWER TRACK SYSTEM

222 2000 USNR

72" INSERT TOOTH TEMPOSONIC POSITIONED SAW MODULE W/TEMPOSONIC CYLINDER, BALDOR 60 HP/1,185 RPM MOTOR, (2) LOG CLAMPS, DIVERTER ARM & 34" HYDRAULIC DRIVEN HOURGLASS ROLLS, SAW HYDRAULICS MOUNTED ON POWER TRACK SYSTEM

223 2000 USNR

72" INSERT TOOTH TEMPOSONIC POSITIONED SAW MODULE W/TEMPOSONIC CYLINDER, BALDOR 60 HP/1,185 RPM MOTOR, (2) LOG CLAMPS, DIVERTER ARM & 34" HYDRAULIC DRIVEN HOURGLASS ROLLS, SAW HYDRAULICS MOUNTED ON POWER TRACK SYSTEM

224 2000 USNR

72" INSERT TOOTH TEMPOSONIC POSITIONED SAW MODULE W/TEMPOSONIC CYLINDER, BALDOR 60 HP/1,185 RPM MOTOR, (2) LOG CLAMPS, DIVERTER ARM & 34" HYDRAULIC DRIVEN HOURGLASS ROLLS, SAW HYDRAULICS MOUNTED ON POWER TRACK SYSTEM

225 2000 USNR

72" INSERT TOOTH TEMPOSONIC POSITIONED SAW MODULE W/TEMPOSONIC CYLINDER, BALDOR 60 HP/1,185 RPM MOTOR, (2) LOG CLAMPS, DIVERTER ARM & 34" HYDRAULIC DRIVEN HOURGLASS ROLLS, SAW HYDRAULICS MOUNTED ON POWER TRACK SYSTEM

226 2000 USNR

72" INSERT TOOTH TEMPOSONIC POSITIONED SAW MODULE W/TEMPOSONIC CYLINDER, BALDOR 60

LOT #

HP/1,185 RPM MOTOR, (2) LOG CLAMPS, DIVERTER ARM & 34" HYDRAULIC DRIVEN HOURGLASS ROLLS, SAW HYDRAULICS MOUNTED ON POWER TRACK SYSTEM

227 2000 USNR

72" INSERT TOOTH TEMPOSONIC POSITIONED SAW MODULE W/TEMPOSONIC CYLINDER, BALDOR 75 HP/1,185 RPM MOTOR, PRE-SET FENCE, (1) LOG CLAMP, DIVERTER ARM & 34" HYDRAULIC DRIVEN HOURGLASS ROLL, SAW HYDRAULICS MOUNTED ON POWER TRACK SYSTEM

228 30" X APPROX 54' OUTFEED BELT W/BELT TAKE UP, STEEL TROUGH & MARKED SUPPORTS**229 TECO**

60 HP/1,770 RPM MOTOR TO REX REDUCER W/DRIVE CHAIN (DRIVE FOR LOT 228)

230 (REPLACED) 2019 INDIVIDUALLY OPERATED 4-ARM & 5-ARM LOG STOP & LOADER W/27", 30" & 36" ENVELOPES, CYLINDERS & BEARINGS, MARKED SUPPORT IF ANY**231 60"W X 6-STRAND & 7-STRAND JACK LADDER TRANSFER W/LADDERS EVERY 6', TENSION BAGS & MARKED SUPPORTS****232 BALDOR**

15 HP MOTOR TO REX EARTH REDUCER (NO DATA) W/DRIVE CHAIN (DRIVE FOR LOT 231)

233 LOT, (16) APPROX 28" X 42" HOURGLASS ROLLS

W/INDIVIDUAL HYDRAULIC MOTORS, BEARINGS & BUMPER (NO SUPPORTS)

SWANSON GROUP GLENDALE SAWMILL - LIVE AUCTION 8/7/2019

LOT #	LOT #
234	242
30" X APPROX 64" INFEED BELT TRANSFER FROM	72" INSERT TOOTH SAW W/100-TEETH X 2-GAUGE
SCANNER LOG HAUL W/(2) 4-ARM & (1) 3-ARM LOG KICKERS/SWEEPS, STEEL TROUGH, MARKED SUPPORTS IF ANY	W/2-3/4" ARBORS (IN ROOM)
235	243
BALDOR	72" INSERT TOOTH SAW W/100-TEETH X 2-GAUGE
15 HP MOTOR TO REX EARTH REDUCER (NO DATA) W/DRIVE CHAIN (DRIVE FOR LOT 234)	W/2-3/4" ARBORS (IN ROOM)
236	244
BICKEL TYPE	72" INSERT TOOTH SAW W/100-TEETH X 2-GAUGE
125' SCANNER LOG HAUL W/RO 3315 VEE-CRADLE CHAIN, 24" FLIGHTS SPACING, STEEL TROUGH, MARKED SUPPORTS IF ANY	W/2-3/4" ARBORS (IN ROOM)
237	245
BALDOR	72" INSERT TOOTH SAW W/100-TEETH X 2-GAUGE
40 HP MOTOR TO REX EARTH 126 RPM REDUCER W/DRIVE CHAIN (DRIVE FOR LOT 236)	W/2-3/4" ARBORS (IN ROOM)
238	245Z
2000 USNR/HERMARY	SALE MOVES UPSTAIRS TO CONTROL ROOM
LOG SCANNER W/(6) MOD# 2016 SCAN HEADS, RECONDITIONED FRAME SCANNER, INTERFACE & SOLUTIONS PC'S, SERVER CABINET & MARKED CONTROLS	246
238Z	MITSUBISHI A500
SALE MOVES DOWNSTAIRS	LOT, 30 HP DRIVE W/CONTROLLER (NO BREAKER, SWITCH OR WIRE OUTSIDE OF BOX)
239	247
HYDRAULIC UNIT W/(6) 60 HP MOTORS TO VICKERS	MITSUBISHI A500
PUMPS, (3) HEAT EXCHANGERS, CHROMALOX TANK HEATER	LOT, 15 HP DRIVE W/CONTROLLER (NO BREAKER, SWITCH OR WIRE OUTSIDE OF BOX)
240	248
GE	MITSUBISHI A500
LOT, (5) 100 AMP & (3) 30 AMP DISCONNECTS (NO WIRE OUTSIDE OF BOX)	LOT, 15 HP DRIVE W/CONTROLLER (NO BREAKER, SWITCH OR WIRE OUTSIDE OF BOX)
241	249
72" INSERT TOOTH SAW W/100-TEETH X 2-GAUGE	MITSUBISHI A500
W/2-3/4" ARBORS (IN ROOM)	LOT, 125 HP DRIVE W/CONTROLLER (NO BREAKER, SWITCH OR WIRE OUTSIDE OF BOX)
241	250
72" INSERT TOOTH SAW W/100-TEETH X 2-GAUGE	MITSUBISHI A500
W/2-3/4" ARBORS (IN ROOM)	LOT, 50 HP DRIVE W/CONTROLLER (NO BREAKER, SWITCH OR WIRE OUTSIDE OF BOX)

SWANSON GROUP GLENDALE SAWMILL - LIVE AUCTION 8/7/2019

LOT #	LOT #
251 MITSUBISHI A500	260 -
LOT, 50 HP DRIVE W/CONTROLLER (NO BREAKER, SWITCH OR WIRE OUTSIDE OF BOX)	261 ALLEN BRADLEY POWERFLEX 755
252 MITSUBISHI A500	100 HP DRIVE W/CONTROLLER (NO BREAKER, SWITCH OR WIRE OUTSIDE OF BOX)
LOT, 40 HP DRIVE W/CONTROLLER (NO BREAKER, SWITCH OR WIRE OUTSIDE OF BOX)	262 ALLEN BRADLEY POWERFLEX 755
253 MITSUBISHI A500	LOT, 40 HP & 15 HP DRIVES W/CONTROLLERS (NO BREAKER, SWITCH OR WIRE OUTSIDE OF BOX)
LOT, 40 HP DRIVE W/CONTROLLER (NO BREAKER, SWITCH OR WIRE OUTSIDE OF BOX)	263 ALLEN BRADLEY POWERFLEX 700
254 MITSUBISHI A500	40 HP DRIVE W/CONTROLLER (NO BREAKER, SWITCH OR WIRE OUTSIDE OF BOX)
LOT, 25 HP DRIVE W/CONTROLLER (NO BREAKER, SWITCH OR WIRE OUTSIDE OF BOX)	264 ALLEN BRADLEY POWERFLEX 700
255 MITSUBISHI A500	40 HP DRIVE W/CONTROLLER (NO BREAKER, SWITCH OR WIRE OUTSIDE OF BOX)
LOT, 20 HP DRIVE W/CONTROLLER (NO BREAKER, SWITCH OR WIRE OUTSIDE OF BOX)	265 CUTLER HAMMER FREEDOM SERIES 2100
256 MITSUBISHI A500	3-SECTION MCC W/(3) SWITCHES & BREAKERS (NO DRIVES, CONTROLS OR WIRE OUTSIDE OF BOX)
LOT, 20 HP DRIVE W/CONTROLLER (NO BREAKER, SWITCH OR WIRE OUTSIDE OF BOX)	266 ALLEN BRADLEY CENTERLINE
257 MITSUBISHI A500	7-SECTION MCC W/(18) SWITCHES (NO WIRE OUTSIDE OF BOX)
LOT, 20 HP DRIVE W/CONTROLLER (NO BREAKER, SWITCH OR WIRE OUTSIDE OF BOX)	267 ALLEN BRADLEY CENTERLINE
258 MITSUBISHI A500	5-SECTION MCC W/(19) SWITCHES (NO WIRE OUTSIDE OF BOX)
LOT, 20 HP DRIVE W/CONTROLLER (NO BREAKER, SWITCH OR WIRE OUTSIDE OF BOX)	268 ALLEN BRADLEY CENTERLINE
259 CUTLER HAMMER FREEDOM SERIES 2100	5-SECTION MCC W/(26) SWITCHES (NO WIRE OUTSIDE OF BOX)
11-SECTION MCC CABINET (NO DRIVES, CONTROLLER OR WIRE OUTSIDE OF BOX)	269 ALLEN BRADLEY
	PLC 5/80E W/(12) LINEAR POSITIONING, (1) NETWORK, (2) ENCODERS, (2) DC INPUT & (4) NON-REDUNDANT MODULES, ALLEN BRADLEY 1771 W/(1) AC INPUT & (2) ANALOG INPUT & (2) ANALOG

SWANSON GROUP GLENDALE SAWMILL - LIVE AUCTION 8/7/2019

LOT #	LOT #
OUTPUT MODULES (NO WIRE OUTSIDE OF BOX)	276 LOT, (2) 240 GALLON TANKS, VERTICAL AIR RECEIVER TANK, HYPOWER PUMP STATION, (1) BLUE HOSE REEL & (2) LUBE REELS
270 ALLEN BRADLEY 1771	277 INGERSOLL RAND
ASE W/(10) AC OUTPUT, (5) AC INPUT & (1) DC INPUT MODULES (NO WIRE OUTSIDE OF BOX)	10 HP TANK MOUNTED COMPRESSOR, MOD# 2545 TWIN CYLINDER HEAD
271 LOT, SWING AROUND CONTROL MODULE W/TOUCHSCREEN,	278 AMERICAN CONSTRUCTION
OPTICOM MULTI-CHANNEL DVD PLAYER, MONITORS & CAMERAS THROUGHOUT LPC BUILDING	APPROX 32" X 120" 150 PSI AIR RECEIVER (NO AIR LINES) VIN / Serial: 9888
271Z SALE MOVES OUT TO CRANES	279 LOT, MARKED SUBSTRUCTURE THROUGHOUT LPC BUILDING (DOES NOT INCLUDE SUBSTRUCTURE FOR UPPER OFFICE, CATWALK OR STAIRS ON S.W. SIDE OF OFFICE OR ANY SUBSTRUCTURE OR CATWALK SUBSTRUCTURE, WIRE OR CONDUIT SOLD IN OTHER LOTS, PLEASE SEE AUCTION SITE REP PRIOR TO BIDDING)
272 MILWAUKEE	280 MILL POWER
3-TON RATED UNDERSLUNG BRIDGE CRANE W/BUDGIT 3-TON ELECTRIC CHAIN HOIST, APPROX 48' SPAN X 70' RAILS, POWER TRAVEL, REMOTE CONTROL (SPARE REMOTE IN OFFICE, MUST REMAIN THROUGH END OF REMOVAL PERIOD)	48" X APPROX 30" BALANCED VIBRATORY CONVEYOR, NO SLOPE SHEETING (LOCATED UNDER LOG DECK)
273 MILWAUKEE	281 MILL POWER
3-TON RATED UNDERSLUNG BRIDGE CRANE W/HARRINGTON 3-TON ELECTRIC CHAIN HOIST, APPROX 25' SPAN X 40' RAILS, POWER TRAVEL, REMOTE CONTROL (SPARE REMOTE IN OFFICE, MUST REMAIN THROUGH END OF REMOVAL PERIOD)	48" X APPROX 30" BALANCED VIBRATORY CONVEYOR, NO SLOPE SHEETING (LOCATED UNDER LOG DECK)
274 JET	282 MILL POWER
3-TON CHAIN HOIST W/REMOTE & JIB ARM (MUST REMAIN THROUGH END OF REMOVAL PERIOD)	48" X APPROX 30" BALANCED VIBRATORY CONVEYOR, NO SLOPE SHEETING (LOCATED UNDER LOG DECK)
275 LOT, (2) AIR HOSE REELS BY #1 SAW & DEBARKER & (2) GE 60 AMP DISCONNECTS IN MERCHANDISER AREA	283 MILL POWER
275Z SALE MOVES DOWNSTAIRS BY DEBARKER OUTFEED TO NORTH SIDE OF LPC BUILDING	36" X APPROX 90' BALANCED VIBRATORY CONVEYOR, NO SLOPE SHEETING (LOCATED UNDER DEBARKER LINE)

SWANSON GROUP GLENDALE SAWMILL - LIVE AUCTION 8/7/2019

LOT #	LOT #
284 MILL POWER	291 TOSHIBA
36" X APPROX 90' BALANCED VIBRATORY CONVEYOR, NO SLOPE SHEETING (LOCATED UNDER DEBARKER LINE)	APPROX 15 HP MOTOR TO SKK 125 RPM REDUCER W/DRIVE CHAIN (DRIVE FOR LOT 290)
285 MILL POWER	292 2019 CUSTOM BUILT
36" X APPROX 90' BALANCED VIBRATORY CONVEYOR, NO SLOPE SHEETING (LOCATED UNDER DEBARKER LINE)	LOG SCREW SINGULATOR FROM MERCHANDISER W/(6) 10'L LOG SCREWS, 20'W W/10' TRIPLE STRAND EVEN END CHAIN, MARKED STEEL & SUPPORTS
286 MILL POWER	293 2019 TOSHIBA
24" X APPROX 37' BALANCED VIBRATORY CONVEYOR, NO SLOPE SHEETING (LOCATED AT SOUTH END OF BUILDING)	30 HP MOTOR TO REX POLARIS 32 RPM REDUCER W/DRIVE CHAIN (DRIVE FOR LOT 292)
287 MILL POWER	294 2019 SUMITOMO
36" X APPROX 70' BALANCED VIBRATORY CONVEYOR, NO SLOPE SHEETING (LOCATED UNDER MERCHANDISER SAWS)	10 HP/179:1 RATIO GEARHEAD MOTOR W/DRIVE CHAIN (DRIVE FOR LOT 292)
287Z SALE MOVES OUTSIDE TO S.W. CORNER	295 -
288 APPROX 24' 2-STRAND 8" X 14" BOX CHAIN CONVEYOR (THROUGH WALL)	296 30" X APPROX 58' LOG BELT W/SENSORS, MARKED
289 SKK	TROUGH, STEEL & SUPPORTS
GEARHEAD MOTOR (NO DATA) W/DRIVE CHAIN (DRIVE FOR LOT 288)	297 SKK
289Z SALE MOVES UPSTAIRS THROUGH LPC BUILDING TO	GEARHEAD MOTOR (NO DATA) W/DRIVE CHAIN (DRIVE FOR LOT 295)
OUTFEED BELT FROM MERCHANDISER SAWS	298 GE
290 30" X APPROX 45' OUTFEED BELT FROM MERCHANDISER	LOT, (6) 30 AMP DISCONNECTS (NO BUSS GUTTER OR WIRE OUTSIDE OF BOX)
SAWS W/(1) 4-ARM & (1) 3-ARM LOG KICKERS, LOG KICKERS STATION W/5-ARM KICKER, MARKED TROUGH, STEEL & SUPPORTS	299 LOG ORIENTER W/DUAL 84" ROLLS & KICKERS
	W/30" X
	38' OUTFEED CONVEYOR W/H&T DRUMS, MARKED PLATE & SUPPORTS
	300 SKK
	25 HP/125 RPM GEARHEAD MOTOR W/DRIVE CHAIN (DRIVE FOR LOT 299)

SWANSON GROUP GLENDALE SAWMILL - LIVE AUCTION 8/7/2019

LOT #

301 30" X APPROX 42' LOG INFEED BELT TO STEP FEEDER
W/4-ARM KICKER, H&T DRUMS, MARKED TROUGH & SUPPORTS

302 24" X APPROX 27' LOG OUTFEED BELT FROM STEP
FEEDER, H&T DRUMS, MARKED TROUGH & SUPPORTS

303 SKK

25 HP/125 RPM GEARHEAD MOTOR W/DRIVE CHAIN
(DRIVE FOR LOT 301)

304 MOTOR TO SKK REDUCER (NO DATA)
W/DRIVE CHAIN
(DRIVE FOR LOT 302)

305 LINDEN

24' STEP FEEDER W/(4) STEPS, MARKED STEEL PLATE & SUPPORTS

306 LINDEN

24' STEP FEEDER W/(3) STEPS, MARKED STEEL PLATE & SUPPORTS

307 BALDOR

25 HP MOTOR TO SM CYCLO 75.8 HP RATED REDUCER W/DRIVE CHAIN (DRIVE FOR LOT 305)

308 BALDOR

5 HP MOTOR TO REX VENUS 78.67 RPM REDUCER W/DRIVE CHAIN (DRIVE FOR LOT 306)

309 BALDOR

5 HP MOTOR TO REX VENUS 78.67 RPM REDUCER W/DRIVE CHAIN (DRIVE FOR LOT 306)

LOT #**310 BALDOR**

5 HP MOTOR TO REX VENUS 78.67 RPM REDUCER W/DRIVE CHAIN (DRIVE FOR LOT 306)

311 16' 6-STRAND WR124XD INFEED LOG DECK TO STEP
FEEDER, S-DRIVE, STEEL DECK & SUPPORTS

312 SKK

10 HP/30 RPM DOUBLE REDUCTION GEARHEAD MOTOR W/DRIVE CHAIN (DRIVE FOR LOT 311)

313 30" X APPROX 75' INFEED LOG BELT TO LOG LADDER,
H&T DRUMS, (2) 5-ARM KICKERS, STEEL TROUGH & KICK OUT SIDE, SUPPORTS

314 TOSHIBA

40 HP MOTOR TO REX ATLAS 102 RPM REDUCER W/DRIVE CHAIN (DRIVE FOR LOT 313)

315 MDI TWA2000

WHOLE LOG METAL DETECTOR, 36" X 44', CR85 CONTROLLER W/SERIES 2000 CHASSIS, 30" X APPROX 86' FEED THRU BELT W/(2) SETS OF 5-ARM LOG KICKERS
VIN / Serial: 980617

316 10' 7-STRAND WR124XD INFEED LOG DECK TO LOG
LADDER, S-DRIVE STEEL PLATE & SUPPORTS

317 SKK

DOUBLE REDUCTION GEARHEAD MOTOR (NO DATA) W/DRIVE CHAIN (DRIVE FOR LOT 316)

318 NEW WEST LOG

HYDRAULIC OPERATED 24' 10-STEP LOG LADDER (CONVERTED FROM ELECTRIC OPERATED) & SUPPORTS

SWANSON GROUP GLENDALE SAWMILL - LIVE AUCTION 8/7/2019

LOT #	LOT #
319 HYPOWER	328 APPROX 17" X 48' CLEAN OUT BELT CONVEYOR
HYDRAULIC UNIT W/(3) 60 HP MOTOR TO VICKERS PUMPS, (2) HEAT EXCHANGERS, ACCUMULATOR & FLOOR FAN	FROM LOT 327, H&T DRUMS & STEEL TROUGH
320 LOT, CATWALK & STAIRS FROM LPC TO DLI BUILDING	329 APPROX 11" X 30' CHEVRON BELT CONVEYOR
(MACHINERY HAS PRIORITY OVER CATWALK & STAIRS & MUST REMAIN FOR 30 DAYS)	FROM LOT 328, H&T DRUMS & STEEL TROUGH
321 SUTORBILT 1029-5111	330 SKK
10" X 24" BLOWER W/BROOKS 125 HP MOTOR, STODDARD SILENCER, MARKED PIPING	5 HP/56 RPM GEARHEAD MOTOR W/DRIVE CHAIN (DRIVE FOR LOT 325)
322 -	331 SKK
323 GE	3 HP/56 RPM GEARHEAD MOTOR W/DRIVE CHAIN (DRIVE FOR LOT 326)
LOT, (1) 100 AMP & (1) 30 AMP DISCONNECTS W/BLOWER/FEEDER CONTROLS (NO BUSS GUTTER OR WIRE OUTSIDE OF BOX)	332 SKK
324 ACROWOOD	3 HP/56 RPM GEARHEAD MOTOR W/DRIVE CHAIN (DRIVE FOR LOT 327)
5' X 10' 3-DECK CHIP SCREEN W/METAL COVER & SUPPORTS	333 SKK
325 APPROX 100' COVERED 8" X 14" W/FLITES BOX CHAIN	GEARHEAD MOTOR (NO DATA) W/DRIVE CHAIN (DRIVE FOR LOT 328)
INFEED CONVEYOR TO SCREEN, H&T SPROCKETS, STEEL TROUGH & SUPPORTS	334 SKK
326 APPROX 70" 6" X 11" BOX CHAIN OUTFEED CONVEYOR	3 HP/56 RPM GEARHEAD MOTOR W/DRIVE CHAIN (DRIVE FOR LOT 329)
FROM SCREEN, S-DRIVE, RETURN, H&T SPROCKETS	334Z SALE MOVES INTO DLI BUILDING BASEMENT
327 APPROX 18" X 33' CLEAN OUT BELT CONVEYOR	UNDER LOT 318 LOG LADDER
FROM DLI BUILDING, H&T DRUMS, STEEL TROUGH & SUPPORTS	335 MILL POWER
	48" X APPROX 31' BALANCED VIBRATORY CONVEYOR W/MARKED STEEL SLOPE (BEHIND LOT 336)

SWANSON GROUP GLENDALE SAWMILL - LIVE AUCTION 8/7/2019

LOT #	LOT #
336 MILL POWER 48" X APPROX 31' BALANCED VIBRATORY CONVEYOR W/MARKED STEEL SLOPE	345 APPROX 72' 6" X 11" W/FLITES BOX CHAIN CONVEYOR FROM CONVEYOR LOT 349 TO CONVEYOR LOT 347, STEEL TROUGH, RETURN & SUPPORTS
337 MILL POWER 24" X APPROX 188' BALANCED VIBRATORY CONVEYOR W/MARKED STEEL SLOPE	346 SKK 3 HP/56 RPM GEARHEAD MOTOR W/DRIVE CHAIN (DRIVE FOR LOT 345)
338 ALLEN BRADLEY ROCKWELL CENTERLINE 6-SECTION MCC W/(16) SWITCHES (NO WIRE OUTSIDE OF BOX)	347 MILL POWER 18" X APPROX 18' BALANCED VIBRATORY CONVEYOR
339 ALLEN BRADLEY ROCKWELL CENTERLINE 4-SECTION MCC W/(7) SWITCHES (NO WIRE OUTSIDE OF BOX)	348 MILL POWER 24" X APPROX 32' BALANCED VIBRATORY CONVEYOR (THROUGH WALL)
340 PLC CABINET W/ALLEN BRADLEY REMOTES W/(12) AC INPUT & (11) AC OUTPUT MODULES, ALLEN BRADLEY PANELVIEW 900 TOUCHSCREEN (NO WIRE OUTSIDE OF BOX)	349 MILL POWER 24" X APPROX 90' BALANCED VIBRATORY CONVEYOR (THROUGH WALL)
341 PRECISION 30" X 30" FEEDER W/DRIVE	350 HYDRAULIC UNIT W/(2) 30 HP MOTORS TO VICKERS PUMPS (ON OTHER SIDE OF LOT 349)
342 RADER 20" X 25" ESW FEEDER W/DRIVE & MARKED PIPING	351 LOT, BLOWER & ASSORTED ITEMS IN THIS AREA (ON OTHER SIDE OF LOT 349)
343 ALLEN BRADLEY ROCKWELL CENTERLINE 7-SECTION MCC W/(14) SWITCHES (NO WIRE OUTSIDE OF BOX)	352 LOT, CATWALK & STAIRS OVER LOTS 348 & 349
344 PLC CABINET W/ALLEN BRADLEY PLC 5/40L W/(1) LINEAR & (1) ANALOG INPUT, (7) AC INPUT & (6) AC OUTPUT MODULES W/BLOWER/FEEDER CONTROL BOX (NO WIRE OUTSIDE OF BOX)	352Z SALE MOVES OUTSIDE BETWEEN LOTS 348 & 349 TO LONG CONVEYORS TO HOG
	353 APPROX 82' 8" X 14" W/FLITES BOX CHAIN CONVEYOR, S-DRIVE, H&T SPROCKETS, STEEL TROUGH & RETURN

James G. Murphy Co.

SWANSON GROUP GLENDALE SAWMILL - LIVE AUCTION 8/7/2019

LOT #	LOT #
354 APPROX 87' 2-STRAND 6" X 11" W/FLITES BOX CHAIN CONVEYOR, H&T SPROCKETS, STEEL TROUGH & RETURN	364 SKK 5 HP/30 RPM GEARHEAD MOTOR W/DRIVE CHAIN (DRIVE FOR LOT 363)
355 SKK 5 HP/30 RPM GEARHEAD MOTOR W/DRIVE CHAIN (DRIVE FOR LOT 353)	365 PARTIAL 51' 2-STRAND 8" X 14" BOX CHAIN CONVEYOR TO LOT 363, S-DRIVE (NO DRIVE MOTOR)
356 MOTOR TO REX REDUCER (NO DATA) W/DRIVE CHAIN (DRIVE FOR LOT 354)	366 APPROX 100' 8" X 14" BOX CHAIN CONVEYOR FROM LOT 363 TO HOG INFEED BELT W/S-DRIVE, STEEL TROUGH & RETURN
357 APPROX 16' 2-STRAND 6" X 11" BOX CHAIN CONVEYOR TO LOT 353, H&T SPROCKETS & STEEL TROUGH	367 SKK 15 HP/25 RPM DOUBLE REDUCTION GEARHEAD MOTOR W/DRIVE CHAIN (DRIVE FOR LOT 367)
358 APPROX 20" X 23' CLEAN OUT BELT CONVEYOR TO LOT 353, H&T DRUMS & STEEL TROUGH	367Z SALE MOVES TO HOG AREA
359 APPROX 26' 6" X 11" BOX CHAIN CLEAN OUT CONVEYOR TO LOT 354, H&T SPROCKETS & STEEL TROUGH	368 28" X APPROX 28' HOG INFEED BELT W/36" FIBERGLASS TROUGH
360 SKK 5 HP/56 RPM GEARHEAD MOTOR W/DRIVE CHAIN (DRIVE FOR LOT 357)	369 SKK 5 HP/56 RPM GEARHEAD MOTOR W/DRIVE CHAIN (DRIVE FOR LOT 368)
361 SKK GEARHEAD MOTOR (NO DATA) W/DRIVE CHAIN (DRIVE FOR LOT 358)	370 MDI CR85 METAL DETECTOR VIN / Serial: 970714
362 SKK GEARHEAD MOTOR (NO DATA) W/DRIVE CHAIN (DRIVE FOR LOT 359)	371 JEFFREY 54WB HAMMER HOG (NEW GRATES & HAMMERS IN 2018), INFEED CHUTE VIN / Serial: 13697
363 APPROX 25' 2-STRAND 8" X 14" BOX CHAIN CONVEYOR TO LOT 366, H&T SPROCKETS & STEEL TROUGH	372 HPS INERTIA 200 HP/1,200 RPM MOTOR W/GE 400 AMP DISCONNECT (NO COUPLER)

SWANSON GROUP GLENDALE SAWMILL - LIVE AUCTION 8/7/2019

LOT #	LOT #
373 MARKED SUPPORT STRUCTURE W/STAIRS	383 LOT, ASSORTED LOOSE STEEL IN THIS AREA
374 SAF OPAL SS6 SERIES 200 HP SOLID STATE REVERSE VOLTAGE STARTER (NO WIRE OUTSIDE OF BOX)	384 APPROX 310"H X 200"W X 300"L YARD STACKING FRAME
375 ALLEN BRADLEY FLEX I/O CABINET (NO WIRE OUTSIDE OF BOX)	385 -
376 LOT, SIEMENS 400 AMP DISCONNECT PANEL W/(1) 350 AMP, (1) 200 AMP, 50 AMP & 40 AMP BREAKERS, 480Y/277V, (3) ALLEN BRADLEY SIZE 2 STARTERS, TRANSFORMERS & LIGHTING PANEL (NO BUSS GUTTER OR WIRE OUTSIDE OF BOXES)	386 -
377 LOT, (2) APPROX 30-UNIT HYDRAULIC OPERATED CHIP BINS W/18' DOORS, CROSS TOP CONVEYOR, 15 HP HYDRAULIC UNIT, ATTACHED ELECTRICS & STAIRS	387 -
378 APPROX 24-UNIT HYDRAULIC OPERATED CHIP BIN W/ATTACHED STAIRS & CATWALK	388 -
379 APPROX 24-UNIT HYDRAULIC OPERATED CHIP BIN W/ATTACHED STAIRS & CATWALK	389 -
380 APPROX 90' 8" X 14" W/FLITES BOX CHAIN CONVEYOR TO LOT 378, S-DRIVE, STEEL TROUGH & RETURN	389Z SALE MOVES TO FILING ROOM (UPSTAIRS S.E. CORNER OF DLI BUILDING)
381 BALDOR 15 HP MOTOR TO REX NEPTUNE 73 RPM REDUCER W/DRIVE CHAIN (DRIVE FOR LOT 380)	390 STEEL CUT OFF SAW W/ALLEN BRADLEY SIZE 1 STARTER (AT THE FOOT OF THE STAIRS TO THE FILING ROOM)
382 LOT, HIGH PRESSURE BLOWPIPE FROM CHIP BINS TO BLOWERS & FEEDERS AT THE DLI BUILDING, SAWMILL & FUELING AREA W/TOWER	390Z SALE MOVES UPSTAIRS
	391 WRIGHT 1902-P DUAL BANDSAW GUIDE GRINDER VIN / Serial: 011401W1902P
	392 ARMSTRONG #4 LH AUTO BAND SHARPENER W/LINEAR SLIDE, SHAPE UP ARM, VS DRIVE, FILING CLAMP & STAND VIN / Serial: 14694
	393 ARMSTRONG #4 RH AUTO BAND SHARPENER W/LINEAR SLIDE, SHAPE UP ARM, VS DRIVE, FILING CLAMP & STAND VIN / Serial: 14685

SWANSON GROUP GLENDALE SAWMILL - LIVE AUCTION 8/7/2019

LOT #	LOT #
393Z SALE MOVES DOWN THE RAMP	402 ARMSTRONG 3-10C
394 ARMSTRONG #4	CIRCLE SAW STRETCHER ROLL W/LEVELING ATTACHMENT VIN / Serial: 9642
LH AUTO BAND SHARPENER W/LINEAR SLIDE, SHAPE UP ARM, VS DRIVE, FILING CLAMP & STAND VIN / Serial: 10186	403 IMW 240
395 ARMSTRONG #4	DUAL HEAD GUIDE RESURFACER
RH AUTO BAND SHARPENER W/LINEAR SLIDE, SHAPE UP ARM, VS DRIVE, FILING CLAMP & STAND VIN / Serial: 10185	404 IMW NO. 700
396 ARMSTRONG #5	GUIDE GRINDER
BANDSAW STRETCHER ROLL W/VS DRIVE, CLAMP & ANVIL VIN / Serial: 17940	405 WRIGHT 350HD
397 ARMSTRONG #5	AUTO DUAL SIDE SHARPENER (RECENT REBUILD) VIN / Serial: L0403
BANDSAW STRETCHER ROLL W/VS DRIVE, CLAMP & ANVIL	406 MILLER DIVERSION 180
398 ARMSTRONG #5	WELDER W/CART
BANDSAW STRETCHER ROLL W/VS DRIVE, CLAMP & ANVIL VIN / Serial: 4510	407 MILLER ECONOTIG
399 ARMSTRONG #16	CC-AC/DC WELDING POWER SOURCE W/CART
CIRCLE SAW SHARPENER VIN / Serial: 10002	408 MILLER MILLERMATIC 140 AUTO-SET
400 WRIGHT TALONG TW-2	120V WIRE WELDER W/CART
AUTO TIP WELDER VIN / Serial: 10502	409 MILLER MILLERMATIC 140 AUTO-SET
401 ARMSTRONG	120V WIRE WELDER
PROFILE GRINDER VIN / Serial: 20100	410 LOT, BOTTLE CART W/GAUGES & HOSE
	411 LOT, (2) BOTTLE CARTS W/HAND TRUCK
	412 THERMAL ARC
	TORCH
	413 BALDOR
	3/4 HP DOUBLE END GRINDER, 115/230V

SWANSON GROUP GLENDALE SAWMILL - LIVE AUCTION 8/7/2019

LOT #	LOT #
414 4,400 LB CAPACITY PALLET JACK	427 LOT, ALUMINUM GUIDE BLOCKS FOR TWIN BAND RESAW
415 CRAFTSMAN 6-1/2 HP/20 GALLON/175 BLOWING MPH SHOP VAC	428 LOT, ALUMINUM GUIDE BLOCKS FOR QUAD BAND W/GUIDE MATERIAL
416 COX REELS AIR HOSE REEL	428Z SALE MOVES BETWEEN LOTS 401 & 402
417 LOT, MARKED ELECTRICS, LIGHTS, (2) AIR CONDITIONERS (IN LOWER LEVEL ONLY, NO WIRE OUTSIDE OF BOX)	429 LOT, 4" X 16" ROUND SAW ANVILS W/STAND, LIGHT & SAW TIPS
418 JET JDP14J 14" BENCH TOP DRILL PRESS, 1/2 HP, 115/240V	430 26" DIA SAW W/1-1/2" ARBOR
419 BENCH TOP CHAIN SHARPENER W/PIN PRESSES & TOOLS	431 LOT, 22" DIA SAWS W/5" ARBORS
420 LOT, OREGON 3/8-.050" CHAINSAW CHAIN	432 LOT, 22" DIA SAWS W/5" ARBORS
421 LOT, (2) STEEL TOP WOOD BENCHES W/ASSORTED PARTS	433 LOT, 20" DIA SAWS W/SPLINED ARBORS
422 MITUTOYO 4-1/2" X 24" X 24" GRADE A GRANITE PLATE	434 LOT, 20" DIA SAWS W/SPLINED ARBORS
423 LOT, REMAINING LOOSE CONTENTS OF THIS ROOM	435 LOT, 20" DIA SAWS W/1" ARBORS
424 ARMSTRONG TENSION GAUGE GRINDER	435Z SALE MOVES OUT ONTO LANDING
425 KEY KNIFE SHARPENER, 1/2 HP, 115/208-230V W/KNIVES	436 SIMONDS LOT, (4) 10" WIDE BANDSAWS IN CRATE
426 LOT, ASSORTED CAMS	437 SIMONDS LOT, (2) 9"W X 30"L BANDSAWS IN CRATE
	438 ARMSTRONG 3-60C CIRCLE SAW STRETCHER ROLL VIN / Serial: 11987
	439 LOT, (2) 4" X 12" X 60" ANVILS W/5" X 18" ROUND SAW ANVIL, BANDSAW SHARPENER CLAMPS & WOOD CABINETS W/CONTENTS

James G. Murphy Co.

SWANSON GROUP GLENDALE SAWMILL - LIVE AUCTION 8/7/2019

LOT #	LOT #
439Z SALE MOVES BACK INTO FILING ROOM	453 LOT, (15) 1-1/2" ALUMINUM GUIDES FOR GANG EDGER
440 15' ALUMINUM STRAIGHT EDGE	454 STEEL TABLE W/CIRCLE SAW PROFILING ARBOR
441 12' ALUMINUM STRAIGHT EDGE	455 LOT, 6" SWIVEL BASE VISE, MARKED WOOD CABINETS, ASSORTED CONTENTS
442 LOT, (2) 32" HEAVY DUTY FLOOR FANS (1 ON EACH LEVEL)	456 SPEEDAIRE AIR HOSE REEL
443 LOT, ACE & MINARIK DRIVE CONTROLLERS	456Z SALE MOVES TO NEXT ROOM
444 BALDOR LOT, (1) UNUSED & (1) USED 1/49TH HP/43 RPM GEARHEAD MOTORS	457 LOT, RESAW BANDSAWS
445 CHAR-LYNN HYDRAULIC DRIVE OR PUMP	458 LOT, 1/2 TON CHAIN HOIST W/BOTTLE RACK
446 LOT, (2) BABBIT POTS, (2) CONTROLLERS & MINI HOOD	459 BARNHARDT NO. 51 BANDSAW WHEEL GRINDER SET W/3 HP MOTORIZED & FLEX SHAFT HEAD W/CONTROLLER, (2) NON-POWERED HEADS, 60" & 40" BARRELS, ATTACHMENTS & CORDS
447 EDGER GUIDE PRESS PNEUMATIC OPERATED	460 LOT, ASSORTED ITEMS IN THIS AREA
448 LOT, BABBIT PLATES FOR EDGER GUIDES & ASSORTED COPPER IN THIS AREA	461 LOT, EYEWASH STATION W/FIRST AID BOX
449 LOT, (7) 4" ALUMINUM GUIDES FOR GANG EDGER	461Z SALE MOVES UP THE RAMP
450 LOT, (8) 2-1/4" & (1) 2-1/2" ALUMINUM GUIDES FOR GANG EDGER	462 INGERSOLL RAND SERIES T30 VERTICAL TANK MOUNTED COMPRESSOR W/MOD# S85 COMPRESSOR HEAD, 5 HP/3,450 RPM MOTOR, 230V
451 LOT, (15) 1-3/4" ALUMINUM GUIDES FOR GANG EDGER	463 LOT, BANDSAWS W/CARTS (FITS QUAD BAND)
452 LOT, (15) 1-3/4" ALUMINUM GUIDES FOR GANG EDGER	464 ARMSTRONG #14 BANDSAW SHARPENER

SWANSON GROUP GLENDALE SAWMILL - LIVE AUCTION 8/7/2019

LOT #	LOT #
465 LOT, (2) WOOD CABINETS W/CONTENTS	475 APPROX 26' 6-STRAND H78 TRANSFER FROM LOT 474, S-DRIVE, (6) STOP PINS, STEEL PLATE, NO SUPPORTS
466 EAGLE 1932 30 GALLON FLAMMABLES CABINET	476 SKK 5 HP/56 RPM GEARHEAD MOTOR W/DRIVE CHAIN (DRIVE FOR LOT 471)
467 OXY/ACETYLENE HOSE REEL W/GAUGES & BRAZING TORCH	477 SKK GEARHEAD MOTOR (NO DATA) W/DRIVE CHAIN (DRIVE FOR LOT 472)
468 SPEEDAIRE AIR HOSE REEL	478 SKK 5 HP/45 RPM GEARHEAD MOTOR W/DRIVE CHAIN (DRIVE FOR LOT 473)
469 MILLER SRH444 DC WELDER W/LEADS & CART	479 -
470 MILLER SRH444 DC WELDER W/LEADS & CART	480 -
470Z SALE MOVES INTO DLI BUILDING (FOR OUTFEED TRANSFERS ONLY)	481 24" X APPROX 56' BELT TRANSFER BETWEEN BUILDINGS TO GANG EDGER, H&T DRUMS, STEEL TROUGH
471 APPROX 14' 8-STRAND H82 TRANSFER FROM QUAD, H-SHAFT ONLY, STEEL PLATE, NO SUPPORTS	482 24" X APPROX 50' BELT TRANSFER TO BOARD EDGER, H&T DRUMS, STEEL TROUGH
472 APPROX 9' 7-STRAND H138 LUMBER LANDING TABLE FROM QUAD, H-SHAFT, STEEL PLATE & MARKED CATWALK & PLATE	483 SKK 15 HP/100 RPM GEARHEAD MOTOR W/DRIVE CHAIN (DRIVE FOR LOT 481)
473 APPROX 15' 6-STRAND H78 TRANSFER FROM LOT 472, H-SHAFT, STEEL PLATE, NO SUPPORTS	484 SKK 5 HP/125 RPM GEARHEAD MOTOR W/DRIVE CHAIN (DRIVE FOR LOT 482)
474 APPROX 11' 6-STRAND H138 TRANSFER FROM LOT 473, H-SHAFT, STEEL PLATE, NO SUPPORTS	485 APPROX 33' POWERED ROLLCASE TO RESAW W/(11) APPROX 8-1/2" X 42" ROLLS, (2) STOP GATES & 24' STOP GATE, APPROX 9' 6-STRAND 81XH TRANSFER TO TRIMMER W/H-SHAFT & SUPPORTS

SWANSON GROUP GLENDALE SAWMILL - LIVE AUCTION 8/7/2019

LOT #	LOT #
486 SKK	494 SKK
5 HP/56 RPM GEARHEAD MOTOR (ROLLCASE DRIVE MOTOR) W/DRIVE CHAIN (DRIVE FOR LOT 485)	7-1/2 HP/37 RPM GEARHEAD MOTOR W/DRIVE CHAIN (DRIVE FOR LOT 492)
487 SKK	495 APPROX 25' 6-STRAND H78 OVERHEAD TRANSFER FROM LOT 492, H-SPROCKETS, NO T-SHAFT, EXPANDED METAL DECK, CHAIN RETURNS, MARKED SUPPORTS
5 HP/68 RPM GEARHEAD MOTOR (TRANSFER DRIVE MOTOR) W/DRIVE CHAIN (DRIVE FOR LOT 485)	
487Z SALE MOVES TO RESAW RE-ENTRY AREA	496 APPROX 15' 8-STRAND H82 OVERHEAD TRANSFER FROM LOT 495, H-SHAFT, T-SPROCKETS, EXPANDED METAL DECK, MARKED SUPPORTS
488 SIEMENS	497 APPROX 9' 7-STRAND H138 LUMBER LANDING TABLE FROM LOT 485, T-SHAFT (NO HEAD SHAFT OR SUPPORTS)
LOT, (13) 30 AMP DISCONNECTS (NO BUSS GUTTER OR WIRE OUTSIDE OF BOXES)	
488Z SALE MOVES TO RE-ENTRY TRANSFERS	498 SKK
489 GE	5 HP/45 RPM GEARHEAD MOTOR W/DRIVE CHAIN (DRIVE FOR LOT 496)
LOT, (4) 30 AMP DISCONNECTS (NO BUSS GUTTER OR WIRE OUTSIDE OF BOXES)	
490 APPROX 6' 6-STRAND H78 RE-ENTRY TRANSFER	499 SKK
W/H-SHAFT TO APPROX 12' 6-STRAND H138 LUMBER LANDING TABLE TO LOT 492 W/H-SHAFT, MARKED STEEL PLATE, SUPPORTS & CATWALK	5 HP/56 RPM GEARHEAD MOTOR W/DRIVE CHAIN (DRIVE FOR LOT 497)
491 SKK	499Z SALE MOVES TO RESAW
5 HP/56 RPM GEARHEAD MOTOR W/DRIVE CHAIN (DRIVE FOR LOT 490)	500 SALEM
492 APPROX 40' 6-STRAND CSX CHAIN SPLIT INCLINE	5' TEMPOSONIC POSITIONED VERTICAL TWIN BAND RESAW W/RELIANCE 150 HP/1,190 RPM MOTORS, 1" TOP & BOTTOM WHEELS, HYDRAULIC HOODS, MARKED LUBE SYSTEM (SPARE GUIDES & SAWS IN FILING ROOM)
TRANSFER W/H&T SHAFTS, LATTICE FRAME, EXPANDED METAL DECK, MARKED CATWALK & SUPPORTS	
493 SKK	501 APPROX 26' POWERED INFEEED ROLLCASE W/(6) 8" X 30"
10 HP/30 RPM DOUBLE REDUCTION GEARHEAD MOTOR W/DRIVE CHAIN (DRIVE FOR LOT 492)	CANTED ROLLS, FIXED LINE BAR, POWERED PRESS ROLLS W/3-1/2' 4-STRAND H78 INFEEED TRANSFER W/CANT TURNER

SWANSON GROUP GLENDALE SAWMILL - LIVE AUCTION 8/7/2019

LOT #	LOT #
502 APPROX 26' POWERED OUTFEED ROLLCASE W/(9) 8-1/2" X 72" KNURLED & SMOOTH ROLLS, APPROX 7' 11-STRAND OUTFEED BOARD PICKER TRANSFER	511 ALLEN BRADLEY SMC FLEX 200 HP DRIVE IN THIS BUCKET (NO BREAKER OR SWITCH, NO WIRE OUTSIDE OF BOX)
503 TOSHIBA 30 HP MOTOR TO SKK 190 RPM REDUCER W/DRIVE CHAIN (DRIVE FOR LOT 501)	512 ALLEN BRADLEY POWERFLEX 700 10 HP DRIVE IN THIS BUCKET (NO BREAKER OR SWITCH, NO WIRE OUTSIDE OF BOX)
504 SKK 5 HP/56 RPM GEARHEAD MOTOR W/DRIVE CHAIN (DRIVE FOR LOT 501)	513 ALLEN BRADLEY POWERFLEX 700 5 HP DRIVE IN THIS BUCKET (NO BREAKER OR SWITCH, NO WIRE OUTSIDE OF BOX)
505 SKK GEARHEAD MOTOR (NO DATA) W/DRIVE CHAIN (DRIVE FOR LOT 502)	514 ALLEN BRADLEY POWERFLEX 700 5 HP DRIVE IN THIS BUCKET (NO BREAKER OR SWITCH, NO WIRE OUTSIDE OF BOX)
506 APPROX 15' 9-STRAND H82 INCLINE TRANSFER TO LOT 501, S-DRIVE & SUPPORTS	515 ALLEN BRADLEY POWERFLEX 700 7-1/2 HP DRIVE IN THIS BUCKET (NO BREAKER OR SWITCH, NO WIRE OUTSIDE OF BOX)
507 SKK 5 HP/56 RPM GEARHEAD MOTOR W/DRIVE CHAIN (DRIVE FOR LOT 506)	516 ALLEN BRADLEY POWERFLEX 700 30 HP DRIVE IN THIS BUCKET (NO BREAKER OR SWITCH, NO WIRE OUTSIDE OF BOX)
508 LOT, MARKED MACHINE CONTROLS, DVD, SCREENS, COMPUTERS, PRINTER & A/C UNIT	517 ALLEN BRADLEY CENTERLINE 8-SECTION MCC W/(23) SWITCHES (NO DRIVES SOLD W/LOTS 509-516, NO WIRE OUTSIDE OF BOX)
509 ALLEN BRADLEY LOGIX 5516 PLC W/(2) ETHERNET, (3) DC INPUT, (1) DC OUTPUT MODULES, RMC 150 MOTION CONTROLLER, ALLEN BRADLEY STRATIX 8000 ETHERNET CONTROLLER, 2ND RACK W/(1) ETHERNET, (3) DC OUTPUT, (1) ANALOG INPUT, (5) AC INPUT, (3) AC OUTPUT MODULES W/SOLA (NO WIRE OUTSIDE OF BOX)	517Z SALE MOVES INTO FILING ROOM
510 ALLEN BRADLEY SMC FLEX 200 HP DRIVE IN THIS BUCKET (NO BREAKER OR SWITCH, NO WIRE OUTSIDE OF BOX)	518 LOT, AIR HOSE REEL BY LOT 517 & MANUAL CHAIN HOIST W/RAIL BY RESAW
	518Z SALE MOVES UP & OVER CATWALKS TOWARD BOARD EDGER

SWANSON GROUP GLENDALE SAWMILL - LIVE AUCTION 8/7/2019

LOT #	LOT #
519 LOT, SWING ARM CONTROL PANEL, MONITOR & ELECTRIC FAN	527 TOSHIBA 200 HP/1,180 RPM DRIVE MOTOR (CHIP DRIVE HEAD FOR LOT 525)
519Z SALE MOVES TO BOARD EDGER	528 SCHURMAN TEMPOSONIC POSITIONED 650 MAXIMIZER INFEED MODULE CONVERTED TO A 625 PUSHER MODULE W/CENTERLINE CHAIN & HYDRAULIC DRIVES, BOARD PUSHER STATIONS (NO INFEED TRANSFER)
520 1998 SCHURMAN 2TA30SBE CHIPPING SAW BOSS REMAN EDGER, 2" X 18" SPLINED BOTTOM ARBOR BOARD EDGER TOP SEGMENTED REMAN HEAD, RIGHT & LEFT HAND 2-SAW SPLINED ARBORS, HOLD DOWN ROLLS, CLAMSHELL OPENING (NO DRIVE MOTORS, SPARE GUIDES & SAWS SOLD IN FILING ROOM)	529 52" X APPROX 11' OUTFEED BELT W/TAILO ROLL, H&T DRUMS, STEEL TROUGH
521 TOSHIBA 150 HP/1,775 RPM MOTOR (REMAN HEAD DRIVE FOR LOT 520)	530 SKK 5 HP/350 RPM GEARHEAD MOTOR W/DRIVE CHAIN (DRIVE FOR LOT 529)
522 TOSHIBA 75 HP/3,540 RPM MOTOR (2-SAW SPLINED ARBOR DRIVE FOR LOT 520)	531 GE 8000 LINE 7-SECTION MCC W/(21) SWITCHES, (2) SAF MOD# SS6-360 350 HP & (1) SAS 360 200 HP SOFT STARTS
523 TOSHIBA 75 HP/3,540 RPM MOTOR (2-SAW SPLINED ARBOR DRIVE FOR LOT 520)	532 LOT, (4) GE 60 AMP DISCONNECTS, LIGHTING PANEL, (4) ALLEN BRADLEY START & STOPS (NO BUSS GUTTER OR WIRE OUTSIDE OF BOXES)
524 TOSHIBA 30 HP MOTOR TO SKK 350 RPM REDUCER (FEED ROLLS DRIVE FOR LOT 520)	533 ALLEN BRADLEY PLC 5/40E W/(1) ENCODER, (1) ANALOG, (1) CONTACT OUTPUT, (2) DC INPUT, (2) DC OUTPUT, (5) LINEAR, (10) AC INPUT & (6) AC OUTPUT MODULES (IN OFFICE, NO WIRE OUTSIDE OF BOX)
525 CM&E 91 TEMPOSONIC POSITIONED CHIPPING HEADS W/LINDSAY CONVERSION, (10) KNIVES, 24-7/8" FACE, SLIDE BASE & TEMPOSONICS (NO DRIVE MOTORS)	534 MITSUBISHI FREQROLL A200 100 HP INVERTER BETWEEN EDGER & OFFICE (NO WIRE OUTSIDE OF BOX)
526 TOSHIBA 200 HP/1,180 RPM DRIVE MOTOR (CHIP DRIVE HEAD FOR LOT 525)	535 APPLIED THEORY/USNR EDGER OPTIMIZER, SCAN 20', PASS 24', USNR S26LZD HEADS, USNR GEOII-VAX 400 TIMBER GRAFIX PACKAGE, MARKED COMPUTERS, RACK, MONITORS

SWANSON GROUP GLENDALE SAWMILL - LIVE AUCTION 8/7/2019

LOT #	LOT #
& PRINTER IN ROOM W/REMAINING UNSOLD CONTENTS	544 SKK
536 APPROX 15' 9-STRAND LUGGED 81X PASS THRU INFEED TRANSFER W/(7) 30" EVEN END ROLLS, 3' 7-ARM TIPPLE, BOARD HOOKS, HYDRAULIC DRIVES	5 HP/56 RPM GEARHEAD MOTOR W/DRIVE CHAIN (DRIVE FOR LOT 542)
537 24" X APPROX 30' BELT TRANSFER TO GANG, H&T DRUMS, STEEL TROUGH	545 APPROX 15' 6-STRAND 81X TRANSFER FROM LOT 546, H-SHAFT, STEEL PLATE
538 SKK	546 APPROX 15' 6-STRAND 81X TRANSFER FROM DLI BUILDING, H-SHAFT, STEEL PLATE
10 HP/100 RPM GEARHEAD MOTOR W/DRIVE CHAIN (DRIVE FOR LOT 537)	547 -
539 APPROX 12' 8-STRAND LUMBER UNSCRAMBLER W/HYDRAULIC DRIVE	548 SKK
540 APPROX 6' 5-STRAND LUMBER LANDING TABLE W/H-SHAFT, T-SPROCKETS, MARKED STEEL SUPPORTS	3 HP/56 RPM GEARHEAD MOTOR W/DRIVE CHAIN (DRIVE FOR LOT 546)
541 APPROX 5' 5-STRAND LUMBER LANDING TABLE W/H-SHAFT, T-SPROCKETS, MARKED STEEL SUPPORTS	549 36" X APPROX 48' OVERHEAD BELT TO GANG ON ROAD SIDE OF LOTS 540-542, H&T DRUMS, STEEL TROUGH
542 APPROX 7' 5-STRAND LUMBER LANDING TABLE W/H-SHAFT, T-SPROCKETS, MARKED STEEL SUPPORTS	550 SKK
543 SKK	10 HP/100 RPM GEARHEAD MOTOR W/DRIVE CHAIN (DRIVE FOR LOT 549)
5 HP GEARHEAD MOTOR W/DRIVE CHAIN (DRIVE FOR LOT 540 & 541)	551 20" X APPROX 20' OVERHEAD BELT BEHIND LOT 549, H&T DRUMS, STEEL TROUGH
	552 SKK
	3 HP GEARHEAD MOTOR W/DRIVE CHAIN (DRIVE FOR LOT 551)
	553 -
	554 LOT, BUDGIT 2 TON CHAIN HOIST OVER LOT 551, AIR HOSE REEL BY LOT 535 & FAN ATTACHED TO OFFICE

James G. Murphy Co.

SWANSON GROUP GLENDALE SAWMILL - LIVE AUCTION 8/7/2019

LOT #**554Z SALE MOVES TO GANG EDGER****555 SCHURMAN/USNR 4/6SA24**

GANG EDGER W/(1) ACC 350 HP/1,7750 RPM/445T
FRAME & (1) TOSHIBA 300 HP/1,775 RPM/449T FRAME
MOTORS, #2 INVOLUTE SPLINED BOTTOM ARBOR,
CHROMED FEED ROLLS, SIDE PRESS ROLL & HOLD
DOWNS (NO DRIVE MOTORS, SPARE GUIDES &
SAWS SOLD IN FILING ROOM)

556 ACC

350 HP/1,775 RPM/445T FRAME ARBOR MOTOR
W/ATTACHED SHEAVE & BELT (NO WIRE OUTSIDE
OF BOX)

557 TOSHIBA

300 HP/1,775 RPM/449T FRAME ARBOR MOTOR
W/ATTACHED SHEAVE & BELT (NO WIRE OUTSIDE
OF BOX)

558 TOSHIBA

10 HP MOTOR TO SKK 37.1 HP/280 RPM REDUCER

559 APPROX 24' POWERED INFEED ROLLCASE

W/(4) CHROMED
& KNURLED & (5) SMOOTH 8-1/2" X 21-1/2" ROLLS,
FIXED LINE BAR, FRAME TO FLOOR

560 24" X APPROX 24' OUTFEED BELT

TRANSFER, H&T
DRUMS, BLOWER

561 SKK

5 HP/56 RPM GEARHEAD MOTOR W/DRIVE CHAIN
(DRIVE FOR LOT 559)

562 SKK

GEARHEAD MOTOR (NO DATA) W/DRIVE CHAIN
(DRIVE FOR LOT 560)

LOT #**563 GANG SAW WATER PANEL****564 ALLEN BRADLEY 509-HOB SERIES**

SIZE 7 REDUCED VOLTAGE STARTER W/CH MOD#
3800WK 800 AMP BREAKER (NO WIRE OUTSIDE OF
BOX)

565 MITSUBISHI A200

LOT, 100 HP & 20 HP INVERTERS IN CABINET W/2ND
STARTER CABINET (NO STARTER)

566 MITSUBISHI A500

10 HP INVERTER IN CABINET (ON STAIRS)

567 LOT, APPROX 30' POWERED INFEED ROLLCASE

TO LOT
559 W/(5) CHROMED & KNURLED & (5) SMOOTH
8-1/2" X 21-1/2" ROLLS W/FIXED LINE BAR, APPROX
12' 5-STRAND UPPER INFEED TRANSFER W/(5) SETS
OF BOARD HOOKS, 2-1/2" X 7-ARM TIPPLE

568 SKK

GEARHEAD MOTOR ROLLCASE DRIVE (NO DATA)
W/DRIVE CHAIN (DRIVE FOR LOT 567)

569 SKK

GEARHEAD MOTOR TRANSFER DRIVE (NO DATA)
W/DRIVE CHAIN (DRIVE FOR LOT 567)

570 LOT, APPROX 30' POWERED LOWER

ROLLCASE W/APPROX
12' 5-STRAND INFEED TRANSFER W/(5) SETS OF
BOARD HOOKS

571 SKK

GEARHEAD MOTOR ROLLCASE DRIVE (NO DATA)
W/DRIVE CHAIN (DRIVE FOR LOT 570)

SWANSON GROUP GLENDALE SAWMILL - LIVE AUCTION 8/7/2019

LOT #	LOT #
572 SKK	581 SKK
5 HP/56 RPM GEARHEAD MOTOR TRANSFER DRIVE W/DRIVE CHAIN (DRIVE FOR LOT 570)	5 HP/45 RPM GEARHEAD MOTOR W/DRIVE CHAIN (DRIVE FOR LOT 578)
573 APPROX 7' 7-STRAND H78B LUMBER LANDING TABLE, H-SHAFT, T-SPROCKETS, STEEL PLATE	582 SKK
	GEARHEAD MOTOR (NO DATA) W/DRIVE CHAIN (DRIVE FOR LOT 579)
574 SKK	583 SIEMENS
5 HP/56 RPM GEARHEAD MOTOR W/DRIVE CHAIN (DRIVE FOR LOT 573)	LOT, (5) 30 AMP DISCONNECTS (NO BUSS GUTTER OR WIRE OUTSIDE OF BOX)
575 APPROX 6' 10-STRAND UNSCRAMBLER TO APPROX 6' 7-STRAND OUTFEED TRANSFER, HYDRAULIC DRIVE, STEEL PLATE & SUPPORTS	584A LOT, MARKED CONTROL PANEL, MONITORS & MARKED
	ELECTRICS BY LOTS 567 & 570
576 APPROX 10' 7-STRAND H138 TRANSFER W/HYDRAULIC	584B 16" X APPROX 76' TRANSFER BELT ALONG SIDE OF GANG LINE FROM LOT 570 W/SKK 3 HP/100 RPM GEARHEAD MOTOR
DRIVE MOTOR, H-SHAFT, T-SPROCKETS, MARKED STEEL PLATE	
577 APPROX 16' 8-STRAND H78 TRANSFER W/H-SHAFT,	585 -
T-SPROCKETS & MARKED STEEL PLATE	585Z SALE MOVES TO TRIMMER/SORTER INFEEED AREA
578 APPROX 9' 6-STRAND H138 TRANSFER W/H-SHAFT,	586 APPROX 9' 9-STRAND H138 TRANSFER W/SKK GEARHEAD MOTOR (NO DATA), H-SHAFT, T-SPROCKETS, STEEL PLATE
T-SPROCKETS & MARKED STEEL PLATE	
579 APPROX 8' 9-STRAND H138 TRANSFER W/H-SHAFT,	587 APPROX 7' 7-STRAND H78 TRANSFER W/(7) 12" X 60" EVEN END ROLLS, DRIVE MOTOR, H-SHAFT, T-SPROCKETS, STEEL PLATE FROM LOT 586
T-SPROCKETS & MARKED STEEL PLATE	
580 SKK	588 APPROX 11' 7-STRAND H78 INCLINE TRANSFER
5 HP/56 RPM GEARHEAD MOTOR W/DRIVE CHAIN (DRIVE FOR LOT 577)	W/H-SHAFT, T-SPROCKETS, STEEL PLATE FROM LOT 587

SWANSON GROUP GLENDALE SAWMILL - LIVE AUCTION 8/7/2019

LOT #

589 SKK

7-1/2 HP/25 RPM DOUBLE REDUCTION GEARHEAD
MOTOR W/DRIVE CHAIN (DRIVE FOR LOT 588)

590 APPROX 26' 6" X 11" BOX CHAIN CONVEYOR
TO CHIPPER

AREA W/DRIVE MOTOR, H&T SPROCKETS, STEEL
TROUGH

591 LOT, MARKED CONTROL PANEL, (1) SIEMENS
&

(2) GE
60 AMP & (4) GE 30 AMP DISCONNECTS, MONITORS
OVER LOT 604 (NO BUSS GUTTER OR WIRE OUTSIDE
OF BOXES)

592 -

593 AIR HOSE REEL ABOVE LOT 602

594 -

594Z SALE MOVES TO TRAY SORTER

595 LSI

20' 7-TRAY SORTER, 8' 5-STRAND 81X LUGGED
INCLINE TRANSFER, APPROX 12' 6-STRAND INCLINE
TRANSFER W/5-STRAND BELT TRANSFER TO 28'
6-STRAND DECLINE TRANSFER W/(7) SETS OF
LUMBER DIVERTERS TO SKATE ROLLS, 1ST
SECTION OF TRAYS IS AVERAGE OF 20'L X
5-STRAND X 7-TRAYS W/(7) GEARHEAD MOTORS,
2ND SECTION OF TRAYS IS AVERAGE OF 40'L X
5-STRAND X 7-TRAYS W/(7) GEARHEAD MOTORS,
3RD SECTION OF TRAYS IS AVERAGE OF 80'L X
5-STRAND X 7-TRAYS W/(7) TOSHIBA 3 HP MOTORS
TO HAMPTON 30:1 RATIO REDUCER GEARHEAD
MOTORS, 8" X APPROX 22' 5-STRAND TIPPLE BELT
W/SKK 7-1/2 HP/56 RPM GEARHEAD MOTOR, TOWER
DRIVE, ALL MARKED SUPPORTS & CATWALKS

596 TECO

30 HP/1,780 RPM MOTOR TO SKK 30 HP RATED 100
RPM REDUCER W/DRIVE CHAIN (DRIVE FOR LOTS
595-604)

LOT #

597 APPROX 17' 9-STRAND 81X LUGGED
OUTFEED TRANSFER

FROM TRIMMER W/(9) 9' EVEN END ROLLS, 9-ARM
CHAIN TIPPLE, H&T SHAFTS, STEEL RACES

598 16" X APPROX 24' CLEAN OUT BELT W/(4)
8-1/2" X

26" POWERED OUTFEED ROLLS, H&T DRUMS, STEEL
TROUGH & ROLLS FRAME

599 SKK

GEARHEAD MOTOR (NO DATA) W/DRIVE CHAIN
(DRIVE FOR LOT 598)

600 HEMCO SERIES 332

ACCU-TRIM RH AIR LIFT TRIMMER, CUT 20', PASS
24', S/N:3276 W/(13) 22" INDIVIDUALLY MOTORIZED
SAWS, ZERO SAW, 2"-20" & 9'-3' SAWS, APPROX 9'
9-STRAND LUGGED FEED THRU TRANSFER, AIR
OPERATED HOODS, MARKED CABINET W/SPARE
SAWS & PARTS BY LOT 610

601 2011 SEC POS724

MINI POSI-LOCK POSITIONING FENCE, 0"-24"
ADJUSTMENTS, (10) PADDLES, (8) SCAN SEGMENTS,
15" LUG SPACE, 9' EVEN ENDING 81X LUGGED
TRANSFER W/(9) 8' EVEN ENDING ROLLS, SUPPORTS
TO FLOOR

602 HEMCO/USNR P3A001

TRIMMER OPTIMIZER, SCAN 20', PASS 24' W/USNR
G26L7D HEADS (SERVER RACK W/PC'S & MARKED
ELECTRICS IN OFFICE SOLD AT LOT 606)

603 APPROX 10' 5-STRAND 81X LUGGED PASS
THRU TRANSFER

W/(8) SPLINED & SMOOTH EVEN END ROLLS
W/INDIVIDUAL HYDRAULIC DRIVE MOTORS,
T-SHAFT ONLY

James G. Murphy Co.

SWANSON GROUP GLENDALE SAWMILL - LIVE AUCTION 8/7/2019

LOT #**604 PLC 200**

TONG DOG LOADER W/9' X 6-LUGS INFEED
TRANSFER W/INDIVIDUALLY HYDRAULIC DRIVEN
EVEN END ROLLS, 9' 8-STRAND 2-SECTION INFEED
W/SKK GEARHEAD MOTORS, SUPPORTS TO FLOOR

605 APPROX 6' 8-STRAND UNSCRAMBLER
W/HYDRAULIC DRIVE
MOTOR

605Z SALE MOVES INTO OFFICE

606 LOT, MARKED SERVER RACK W/PC'S,
RECORDERS,

PRINTER, ELECTRONICS & A/C UNIT (NO PLC
CABINET)

607 PLC CABINET W/ALLEN BRADLEY 5/40E PLC
W/(1)

ETHERNET, (1) ENCODER, (2) DC OUTPUT, (2) DC
INPUT, (5) AC INPUT & (5) AC OUTPUT MODULES
(NO WIRE OUTSIDE OF BOX)

607Z SALE MOVES OUT TO DRIVE AREA

608 ALLEN BRADLEY POWERFLEX 700

30 HP DRIVE W/BRAKE & I/O CABINET (NO WIRE
OUTSIDE OF BOX)

609 ALLEN BRADLEY POWERFLEX 700

LOT, (2) 5 HP DRIVES (NO WIRE OUTSIDE OF BOX)

610 ALLEN BRADLEY

REMOTE I/O W/(4) AC INPUT & (4) AC OUTPUT
MODULES (NO WIRE OUTSIDE OF BOX)

610Z SALE MOVES DOWNSTAIRS**LOT #****611 ALLEN BRADLEY CENTERLINE**

8-SECTION MCC W/(43) SWITCHES (NO WIRE
OUTSIDE OF BOX)

612 ALLEN BRADLEY

REMOTE I/O W/(6) AC INPUT & (3) AC OUTPUT
MODULES (NO WIRE OUTSIDE OF BOX)

613 APPROX 64' 5-STRAND GREEN CHAIN W/(2)
STRANDS OF
4" POLY TOP, (1) STRAND OF 4" STEEL TOP & (2)
STRANDS OF H78 CHAIN, H-SHAFT, T-SPROCKETS,
SUPPORTS, CATWALK & MATS

614 APPROX 80' 5-STRAND 81X TRANSFER FROM
LOT 613,
H-SHAFT, T-SPROCKETS, SUPPORTS

615 SKK

5 HP/56 RPM GEARHEAD MOTOR W/DRIVE CHAIN
(DRIVE FOR LOT 613)

616 SKK

5 HP/56 RPM GEARHEAD MOTOR W/DRIVE CHAIN
(DRIVE FOR LOT 614)

617 LOT, (3) APPROX 32' POWERED LUMBER
PULL ROLLCASES
W/(9) 6-1/2" X 48" ROLLS W/SKK 1 HP/59 RPM
GEARHEAD MOTOR

618 LOT, (4) APPROX 32' POWERED LUMBER
PULL ROLLCASES
W/(9) 6-1/2" X 48" ROLLS W/SKK 1 HP/59 RPM
GEARHEAD MOTOR

619 LOT, (2) APPROX 32' POWERED LUMBER
PULL ROLLCASES
W/(9) 6-1/2" X 48" ROLLS W/SKK 1 HP/59 RPM
GEARHEAD MOTOR

SWANSON GROUP GLENDALE SAWMILL - LIVE AUCTION 8/7/2019

LOT #	LOT #
620 APPROX 32' LUMBER PULL ROLLCASE W/(9) 6-1/2" X 48" ROLLS	629 MITSUBISHI 2 HP/68 RPM GEARHEAD MOTOR W/DRIVE CHAIN (DRIVE FOR LOT 628)
620Z SALE MOVES TO PLANER INFEED AREA	629Z SALE MOVES TO PLANER
621 2015 NEWNES HYDRAULIC OPERATED 20' CONTINUOUS TILT HOIST W/5-ARM X 56" HOIST, 40 HP, 25 HP & 15 HP HYDRAULIC UNIT, MARKED CONTROL PANEL	630 1993 YATES A95RH PLANER, 6" X 13" CAPACITY, 4-HEAD, 20-KNIFE, 150 HP TOP, 75 HP BOTTOM & 100 HP & 75 HP SIDE HEADS, 2018 MILLER CONVERSION W/75 HP ELECTRIC DRIVE ON (4) INFEED ROLLS, 50 HP ELECTRIC DRIVE ON (2) OUTFEED ROLLS, CHIP BREAKERS, PLANER DOCTORS, WATER CO VIN / Serial: B29644
622 APPROX 20' 4-STRAND H82 INFEED TRANSFER, S-DRIVE, STEEL BUMP FRAME	631 2018 MILLER 20' TRIPLE PINEAPPLE FEED TABLE W/15 HP MOTORS, HYDRAULIC DRIVEN SPEED UP ROLL, (9) 14" X 30" SPIRAL ROLLS W/TOSHIBA 15 HP/875 RPM MOTORS, 48" EVEN END CHAIN W/GEARHEAD MOTOR, 5' 7-STRAND INFEED TRANSFER W/SKK 3 HP/56 RPM GEARHEAD MOTOR
623 SKK 5 HP/30 RPM DOUBLE REDUCTION GEARHEAD MOTOR W/DRIVE CHAIN (DRIVE FOR LOT 622)	632 2018 MILLER 18' 2-SECTION LIVE BRIDGE W/(8) 14" X 20" KNURLED & SMOOTH ROLLS W/TOSHIBA 30 HP/900 RPM MOTOR, (2) SETS OF (4) POWERED HOLD DOWN ROLLS W/TOSHIBA 7-1/2 HP/900 RPM MOTOR
624 2015 MOCO STICKER RECOVERY SYSTEM W/6' 2-STRAND LUGGED 81X UNSCRAMBLER TO 20' 2-STRAND STICKER TRANSFER TO 38' 2-STRAND STICK CART TRANSFER	633 STAIN TUNNEL W/(3) LMI METERING PUMPS, (2) SEA METRICS CONTROLLERS, PUMPS, TANKS, FILTERS, BAGS (IN LOWER ROOM)
625 APPROX 11" X 32' STICKER RECOVERY BELT, H&T DRUM, STEEL TROUGH, SUPPORTS & STEEL SLOPING	634 18" X 11' OUTFEED BELT W/SKK GEARHEAD MOTOR, STAIRS TO OTHER SIDE
626 SKK 3 HP/350 RPM GEARHEAD MOTOR W/DRIVE CHAIN (DRIVE FOR LOT 625)	635 2018 ALLEN BRADLEY POWERFLEX 755 75 HP AC DRIVE W/BRAKE & CONTROLLER (NO BREAKER, SWITCH OR WIRE OUTSIDE OF BOX)
627 48" TRASH SAW W/APPROX 20 HP MOTOR, STEEL FRAME	
628 16" X APPROX 23' OUTFEED BELT CONVEYOR W/H&T DRUMS, STEEL TROUGH & SUPPORTS	

SWANSON GROUP GLENDALE SAWMILL - LIVE AUCTION 8/7/2019

LOT #	LOT #
636 2018 ALLEN BRADLEY POWERFLEX 755 100 HP AC DRIVE W/BRAKE & CONTROLLER (NO BREAKER, SWITCH OR WIRE OUTSIDE OF BOX)	645 2018 ALLEN BRADLEY POWERFLEX 755 20 HP AC DRIVE W/BRAKE & CONTROLLER (NO BREAKER, SWITCH OR WIRE OUTSIDE OF BOX)
637 2018 ALLEN BRADLEY POWERFLEX 755 40 HP AC DRIVE W/BRAKE & CONTROLLER (NO BREAKER, SWITCH OR WIRE OUTSIDE OF BOX)	646 2018 ALLEN BRADLEY POWERFLEX 755 20 HP AC DRIVE W/BRAKE & CONTROLLER (NO BREAKER, SWITCH OR WIRE OUTSIDE OF BOX)
638 2018 ALLEN BRADLEY POWERFLEX 755 15 HP AC DRIVE W/BRAKE & CONTROLLER (NO BREAKER, SWITCH OR WIRE OUTSIDE OF BOX)	647 2018 ALLEN BRADLEY CENTERLINE 8-SECTION MCC W/(14) SWITCHES & STRATIX 800 ETHERNET SWITCH (NO WIRE OUTSIDE OF BOX)
639 2018 ALLEN BRADLEY POWERFLEX 755 20 HP AC DRIVE W/BRAKE & CONTROLLER (NO BREAKER, SWITCH OR WIRE OUTSIDE OF BOX)	648 ALLEN BRADLEY PLC W/(1) ETHERNET, (7) AC INPUT & (6) AC OUTPUT MODULES, PANELVIEW PLUS 1500 TOUCHSCREEN (NO WIRE OUTSIDE OF BOX)
640 2018 ALLEN BRADLEY POWERFLEX 755 7-1/2 HP AC DRIVE W/BRAKE & CONTROLLER (NO BREAKER, SWITCH OR WIRE OUTSIDE OF BOX)	649 LOT, SAF OPAL SERIES DC1-300-C & DCI-125-C SOLID STATE STARTERS W/SAFTRONICS EZ6240 SOLID STATE STARTER (IN PLANER ROOM, NO WIRE OUTSIDE OF BOX)
641 2018 ALLEN BRADLEY POWERFLEX 755 15 HP AC DRIVE W/BRAKE & CONTROLLER (NO BREAKER, SWITCH OR WIRE OUTSIDE OF BOX)	650 LOT, MARKED ELECTRICS IN THIS ROOM & BY OUTFEED CONVEYOR (NO WIRE OUTSIDE OF BOX)
642 2018 ALLEN BRADLEY POWERFLEX 755 40 HP AC DRIVE W/BRAKE & CONTROLLER (NO BREAKER, SWITCH OR WIRE OUTSIDE OF BOX)	651 LOT, (2) 4" X 20-KNIFE PLANER HEADS W/STANDS
643 2018 ALLEN BRADLEY POWERFLEX 755 7-1/2 HP AC DRIVE W/BRAKE & CONTROLLER (NO BREAKER, SWITCH OR WIRE OUTSIDE OF BOX)	652 LOT, (2) 2" X 20-KNIFE PLANER HEADS
644 2018 ALLEN BRADLEY POWERFLEX 755 20 HP AC DRIVE W/BRAKE & CONTROLLER (NO BREAKER, SWITCH OR WIRE OUTSIDE OF BOX)	653 LOT, (2) 2" X 20-KNIFE PLANER HEADS
	654 LOT, (2) 2" X 20-KNIFE PLANER HEADS
	655 LOT, (2) 2" X 20-KNIFE PLANER HEADS
	656 LOT, (2) 2" X 20-KNIFE PLANER HEADS

James G. Murphy Co.

SWANSON GROUP GLENDALE SAWMILL - LIVE AUCTION 8/7/2019

<u>LOT #</u>	<u>LOT #</u>
657 LOT, (2) JOINTER BARS, (2) ROLLER BARS, PLANER HEAD SET UP STAND	SUPPORTS
658 LOT, PLANER PARTS IN THIS ROOM & MARKED WOOD CABINETS OUTSIDE THIS ROOM BY PLANER OUTFEED BELTS	669 APPROX 6' 6-STRAND 81X TRANSFER W/4' 6-STRAND SHARP CHAIN SPEED UP TRANSFER, H&T SHAFTS, T-SPROCKETS, SUPPORTS
659 GOCKEL TYPE G50SEL TRAVEL HEAD KNIFE GRINDER W/84" MAGNETIC CHUCK VIN / Serial: 7559	670 APPROX 4' 12-STRAND UNSCRAMBLER, SLOPE, STEEL
660 OREGON 511AX CHAIN SHARPENER	671 APPROX 10' 6-STRAND 81X ACCUMULATION TRANSFER, S-DRIVE, 9' 6-STRAND 81X BYPASS TRANSFER W/H-SHAFT, T-SPROCKETS, SUPPORTS
661 LOT, (2) DOUBLE END GRINDERS	672 APPROX 14' 5-STRAND 81X DECLINE TRANSFER FROM TILT HOIST, H-SHAFT, T-SPROCKETS & H-SHAFT SUPPORTS
662 18"D X 43"W X 65"T FLAMMABLES CABINET	673 SKK 3 HP GEARHEAD MOTOR W/DRIVE CHAIN (DRIVE FOR LOT 667)
663 JUST RITE 12 GALLON FLAMMABLES CABINET	674 SKK 3 HP/100 RPM GEARHEAD MOTOR W/DRIVE CHAIN (DRIVE FOR LOT 668)
664 LOT, HEATER W/DISCONNECT, LIGHTS, A/C UNIT & MONITOR IN THIS ROOM	675 SKK 3 HP/100 RPM GEARHEAD MOTOR W/DRIVE CHAIN (DRIVE FOR LOT 668)
665 LOT, (3) MARKED AIR HOSE REELS IN PLANER ROOM	676 SKK 3 HP/100 RPM GEARHEAD MOTOR W/DRIVE CHAIN (DRIVE FOR LOT 669)
666 -	677 SKK 3 HP/10 RPM GEARHEAD MOTOR W/DRIVE CHAIN (DRIVE FOR LOT 669)
666Z SALE MOVES OUT TO PLANER FEED TABLE AREA	
667 APPROX 12" X 24' DROP OUT BELT TO TRASH SAW, H&T DRUMS, STEEL TROUGH	
668 APPROX 7' 5-STRAND 81X TRANSFER W/(3) 5-STRAND MOTORIZED TIPPLE TRANSFER, H&T SHAFTS,	

10% BUYERS PREMIUM ON ALL ITEMS
15% BUYERS PREMIUM ON ALL ONLINE PURCHASES

SWANSON GROUP GLENDALE SAWMILL - LIVE AUCTION 8/7/2019

LOT #	LOT #
678 SKK	686Z SALE MOVES TO PLANER OUTFEED AREA
10 HP/45 RPM GEARHEAD MOTOR W/DRIVE CHAIN (DRIVE FOR LOT 670)	687 LOT, MARKED STEEL PLATE UNDER LOT 647 MCC
679 SKK	W/STAIRS
5 HP/100 RPM GEARHEAD MOTOR W/DRIVE CHAIN (DRIVE FOR LOT 671)	688 LOT, LOOSE CONTENTS OF OFFICE & LUNCHROOM
680 SKK	W/MARKED EYEWASH STATION, WOOD CABINET & METAL LOCKERS
5 HP/100 RPM GEARHEAD MOTOR W/DRIVE CHAIN (DRIVE FOR LOT 671)	689 17" X APPROX 52' OUTFEED BELT W/H&T DRUMS, STEEL TROUGH & SUPPORTS
681 SKK	690 SKK
5 HP/100 RPM GEARHEAD MOTOR W/DRIVE CHAIN (DRIVE FOR LOT 672)	GEARHEAD MOTOR (NO DATA) W/DRIVE CHAIN (DRIVE FOR LOT 689)
682 LOT, (1) GE 60 AMP & (18) GE 30 AMP DISCONNECTS	691 60" X APPROX 16' PLANER SLOW DOWN BELT W/SKK GEARHEAD MOTOR, CATWALK & SUPPORTS
(NO BUSS GUTTER OR WIRE OUTSIDE OF BOXES)	691Z SALE MOVES OUTSIDE
683 ALLEN BRADLEY	692 LOT, BARREL CONTAINMENT STATION W/RACK & COVER
REMOTE W/(1) ETHERNET, (5) AC INPUT & (2) AC OUTPUT MODULES W/OPTICON DVR & ANV CAMERAS OUTSIDE OF PLANER ROOM	693 APPROX 13' 5-ARM X 52" HYDRAULIC OPERATED
684 LOT, MARKED CONTROL PANEL & DISCONNECTS ON WALL	RE-ENTRY TILT HOIST W/20 HP HYDRAULIC UNIT W/MARKED SUPPORTS
685 LOT, (2) AIR HOSE REELS, (1) TOWARD PLANER	693Z SALE MOVES INSIDE & UPSTAIRS
OUTFEED, LARGE FLOOR FAN & WALL MOUNT FAN W/HEATER	694 APPROX 20'L MOVABLE FENCE FROM SLOWDOWN BELT W/GEARHEAD MOTOR & FRAMEWORK TO GROUND
686 LOT, MARKED STEEL DECK PLATE & STAIRS (NO GRATING OR STAIRS TO GRINDING ROOM)	

SWANSON GROUP GLENDALE SAWMILL - LIVE AUCTION 8/7/2019

LOT #	LOT #
695 APPROX 12' 8-STRAND H78B LUMBER LANDING TABLE W/H-SHAFT, T-SPROCKETS, STEEL PLATE & SUPPORTS	703 SKK 5 HP/56 RPM GEARHEAD MOTOR W/DRIVE CHAIN (EVEN END ROLLS DRIVE OF LOT 702)
696 LOT, (7) 14" X 56" SPIRAL EVEN END ROLLS W/BEARINGS	704 ALLEN BRADLEY CENTERLINE 5-SECTION MCC W/(19) SWITCHES (NO WIRE OUTSIDE OF BOX)
697 SKK 5 HP/56 RPM GEARHEAD MOTOR W/DRIVE CHAIN (DRIVE FOR LOT 695)	705 -
698 SKK 3 HP/84 RPM GEARHEAD MOTOR W/DRIVE CHAIN (DRIVE FOR LOT 686)	706 APPROX 26' 10-STRAND 81X LUGGED OUTFEED TRANSFER W/(9) 17' EVEN END ROLLS W/9' 5-STRAND 81X LUGGED OUTFEED TRANSFER (NO HEAD SHAFT ON OUTFEED TRANSFER), H-SHAFT, T-SPROCKETS, 26' OUTFEED TRANSFER, CHAIN RETURNS, PORTION OF CATWALK & STAIRS, SUPPORTS TO GROUND
699 APPROX 6' EVEN END CHAIN W/SKK GEARHEAD MOTOR, ADJUSTABLE FRAME	707 APPROX 28' 5-STRAND 81X LUGGED CUT-IN-TWO STATION W/H-SHAFT, T-SPROCKETS, LUMBER RETURNS, DRIVE ASSEMBLY & SUPPORTS TO FLOOR
700 IRVINGTON MOORE 6671LH AIR LIFT TRIMMER, CUT 24', PASS 30', S/N:21253L W/(13) 20" 10 HP/3,4450 RPM INDIVIDUALLY MOTORIZED SAWS, ZERO SAW & 2'-24' SAWS, APPROX 16' 8-STRAND 81X LUGGED PASS THRU TRANSFER W/H-SHAFT, T-SPROCKETS, MARKED CATWALK, STAIRS, LADDER & MARKED BLOWPIPE TO WALL	707Z SALE MOVES OUTSIDE TOWARD CHIPPER
701 2013 USNR 7PLH24 MULTI-TRACK FENCE W/24" SETBACK, INFINITE FENCE BUMPER RESOLUTION, SPEEDS TO OVER 250 LPM, ALL ELECTRIC ACTUATION, ROTATING CHAIN TRACK W/1-1/2" SPACING	708 30" X APPROX 76' CLEAN OUT BELT FROM TRIMMER, H&T DRUMS, STEEL TROUGH, MARKED ELECTRICS, PLATFORM & STAIRS OVER CONVEYOR
702 APPROX 32' 7-STRAND 81X LUGGED INFEED TRANSFER W/(7) 9' EVEN END ROLLS, H-SHAFT, T-SPROCKETS, CHAIN RETURNS, SUPPORTS TO FLOOR, MARKED CATWALK	709 SKK 7-1/2 HP/100 RPM GEARHEAD MOTOR W/DRIVE CHAIN (DRIVE FOR LOT 708)
	709Z SALE MOVES UP & OVER CONVEYOR TO HYDRAULIC UNIT
	710 NEWNES 15 HP HYDRAULIC UNIT W/HEAT EXCHANGER & DISCONNECT (ACCESS THROUGH TIN WALLS)

SWANSON GROUP GLENDALE SAWMILL - LIVE AUCTION 8/7/2019

LOT #**711 PRECISION 66.18**

8-KNIFE CHIPPER, HORIZONTAL INFEED, TOP
OUTFEED, PIPING TO CYCLONE, MARKED
ELECTRICS, HOSE REEL, CAMERA & MIRROR, WOOD
CABINETS W/CONTENTS
VIN / Serial: C2207

712 TOSHIBA

150 HP/1,180 RPM MOTOR (NO WIRE OUTSIDE OF
BOX)

713 MILL POWER

18"-24" X APPROX 19' BALANCED VIBRATORY
CONVEYOR W/4' TUB, CATWALK

714 MDI CCW65A

METAL DETECTOR W/SERIES XR-3000 COIL
VIN / Serial: 2577

715 APPROX 10'L X 8'W X 10'H LIVE BOTTOM

SURGE IN
W/APPROX 11'L DOUBLE SCREW AUGER W/MOTOR
TO REDUCER, APPROX 6' DIA CYCLONE, STEEL
FRAME, STAIRS & CATWALK

716 BM&M 5X102D

2-DECK CHIP SCREEN, STEEL COVER (NO
SUPPORTS)

717 14" X APPROX 32' CHEVRON CLEAN OUT

BELT TO
CHIPPER, H&T DRUMS, STEEL TROUGH & RETURN,
CATWALK

718 SKK

GEARHEAD MOTOR (NO DATA) W/DRIVE CHAIN
(DRIVE FOR LOT 717)

719 SUTORBILT/RADER

8" X 24" BLOWER, US 75 HP/1,770 RPM MOTOR,
SILENCER (NO PIPING)

LOT #**720 PRECISION TYPE**

20" X 20" FEEDER W/DRIVE (NO PIPING)

721 20" LOW PRESSURE BLOWER W/25 HP MOTOR

(NO PIPING)

722 24" LOW PRESSURE BLOWER W/50 HP MOTOR

(NO PIPING)

VIN / Serial: 169-97-18380

723 APPROX 6' X 6' X 8' WOOD BUILDING

W/METAL SHED

ROOF, MAN DOOR (BY CHIP SCREEN)

724 APPROX 8' X 4' X 8' WOOD BUILDING

W/METAL SHED

ROOF, MAN DOOR (BY MOCO STACKER)

724Z SALE MOVES TO ELECTRICAL BUILDING BY CHIPPER

INFEED

725 ALLEN BRADLEY SMC FLEX

150 HP DRIVE W/BRAKE & CONTROLLER (NO
SWITCH, BREAKER OR WIRE OUTSIDE OF BOX)

726 ALLEN BRADLEY SMC FLEX

300 HP DRIVE W/BRAKE & CONTROLLER (NO
SWITCH, BREAKER OR WIRE OUTSIDE OF BOX)

727 ALLEN BRADLEY POWERFLEX 755

7-1/2 HP DRIVE W/BRAKE & CONTROLLER (NO
SWITCH, BREAKER OR WIRE OUTSIDE OF BOX)

728 ALLEN BRADLEY POWERFLEX 753

15 HP DRIVE W/BRAKE & CONTROLLER (NO
SWITCH, BREAKER OR WIRE OUTSIDE OF BOX)

SWANSON GROUP GLENDALE SAWMILL - LIVE AUCTION 8/7/2019

<u>LOT #</u>	<u>LOT #</u>
729 ALLEN BRADLEY POWERFLEX 755	738 ALLEN BRADLEY
10 HP DRIVE W/BRAKE & CONTROLLER (NO SWITCH, BREAKER OR WIRE OUTSIDE OF BOX)	9-SECTION MCC W/(30) SWITCHES (NO WIRE OUTSIDE OF BOX)
730 ALLEN BRADLEY POWERFLEX 755	739 ALLEN BRADLEY POWERFLEX 753
15 HP DRIVE W/BRAKE & CONTROLLER (NO SWITCH, BREAKER OR WIRE OUTSIDE OF BOX)	7-1/2 HP DRIVE W/BRAKE & CONTROLLER (NO SWITCH, BREAKER OR WIRE OUTSIDE OF BOX)
731 ALLEN BRADLEY POWERFLEX 753	740 ALLEN BRADLEY POWERFLEX 753
10 HP DRIVE W/BRAKE & CONTROLLER (NO SWITCH, BREAKER OR WIRE OUTSIDE OF BOX)	7-1/2 HP DRIVE W/BRAKE & CONTROLLER (NO SWITCH, BREAKER OR WIRE OUTSIDE OF BOX)
732 ALLEN BRADLEY POWERFLEX 753	741 ALLEN BRADLEY POWERFLEX 753
15 HP DRIVE W/BRAKE & CONTROLLER (NO SWITCH, BREAKER OR WIRE OUTSIDE OF BOX)	7-1/2 HP DRIVE W/BRAKE & CONTROLLER (NO SWITCH, BREAKER OR WIRE OUTSIDE OF BOX)
733 ALLEN BRADLEY POWERFLEX 755	742 ALLEN BRADLEY POWERFLEX 753
10 HP DRIVE W/BRAKE & CONTROLLER (NO SWITCH, BREAKER OR WIRE OUTSIDE OF BOX)	20 HP DRIVE W/BRAKE & CONTROLLER (NO SWITCH, BREAKER OR WIRE OUTSIDE OF BOX)
734 ALLEN BRADLEY POWERFLEX 755	743 ALLEN BRADLEY POWERFLEX 753
10 HP DRIVE W/BRAKE & CONTROLLER (NO SWITCH, BREAKER OR WIRE OUTSIDE OF BOX)	15 HP DRIVE W/BRAKE & CONTROLLER (NO SWITCH, BREAKER OR WIRE OUTSIDE OF BOX)
735 ALLEN BRADLEY POWERFLEX 753	744 ALLEN BRADLEY
15 HP DRIVE W/BRAKE & CONTROLLER (NO SWITCH, BREAKER OR WIRE OUTSIDE OF BOX)	4-SECTION MCC W/(11) SWITCHES (NO WIRE OUTSIDE OF BOX)
736 ALLEN BRADLEY POWERFLEX 753	745 ALLEN BRADLEY LOGIX 5572
7-1/2 HP DRIVE W/BRAKE & CONTROLLER (NO SWITCH, BREAKER OR WIRE OUTSIDE OF BOX)	PLC W/(1) ANALOG, (1) DC INPUT, (2) AC INPUT, (1) AC OUTPUT & (2) ETHERNET MODULES (NO WIRE OUTSIDE OF BOX)
737 ALLEN BRADLEY POWERFLEX 753	746 ALLEN BRADLEY
7-1/2 HP DRIVE W/BRAKE & CONTROLLER (NO SWITCH, BREAKER OR WIRE OUTSIDE OF BOX)	REMOTE W/(1) ETHERNET, (5) AC INPUT & (4) AC OUTPUT MODULES (NO WIRE OUTSIDE OF BOX)

James G. Murphy Co.

SWANSON GROUP GLENDALE SAWMILL - LIVE AUCTION 8/7/2019

LOT #	LOT #
746Z SALE MOVES TO RADIUS TRANSFER AREA	
747 LOT, ASSORTED PARTS & SUPPLIES IN THESE (2) ROOMS W/TRIMMER DUTY MOTORS ON BENCH	754 RUCKER 15 HP HYDRAULIC UNIT
748 LOT, ASSORTED SPROCKETS, WEAR STRIP & BRUSHES W/RACK & WOOD CABINET W/CONTENTS	755 APPROX 35' 5-STRAND 81X TAKE AWAY TRANSFER, S-DRIVE, STEEL RACES & FRONT SUPPORTS
749 -	756 APPROX 35' 5-STRAND 81X TAKE AWAY TRANSFER, S-DRIVE, STEEL RACES & FRONT SUPPORTS
749Z SALE MOVES TO SORTER	757 APPROX 35' 5-STRAND 81X TAKE AWAY TRANSFER, S-DRIVE, STEEL RACES & FRONT SUPPORTS
750 IRVINGTON MOORE 20' 45-BIN 4-STRAND PUSH LUG SORTER, 36" IN BETWEEN COLUMNS, (8) REMOTE STATIONS, 30' 6-STRAND 81X LUGGED INCLINE INFEED TRANSFER, MARKED CATWALK & STAIRS, ATTACHED ELECTRICS (NOTE: ALL WIRE ATTACHED TO SORTER & FROM ANY LOTS ATTACHED TO SORTER AREA INCLUDED IN THIS LOT, MUST REMOVE SORTER WITHOUT DISTURBING THE BUILDING, PLEASE SEE AUCTION SITE REP PRIOR TO BIDDING)	758 APPROX 35' 5-STRAND 81X TAKE AWAY TRANSFER, S-DRIVE, STEEL RACES & FRONT SUPPORTS
751 BALDOR 200 HP/1,180 RPM MOTOR TO DODGE TXM 181 RPM REDUCER (SPARE REDUCER SOLD SEPARATELY) W/DRIVE CHAIN (DRIVE FOR LOT 750)	759 SKK 10 HP/100 RPM GEARHEAD MOTOR W/DRIVE CHAIN (DRIVE FOR LOT 755)
752 ALLEN BRADLEY POWERFLEX 755 250 HP DRIVE ON UPPER LANDING (NO WIRE OUTSIDE OF BOX)	760 SKK 10 HP/100 RPM GEARHEAD MOTOR W/DRIVE CHAIN (DRIVE FOR LOT 756)
753 ALLEN BRADLEY REMOTE PLC CABINET W/(1) ETHERNET, (1) ANALOG INPUT & (1) ANALOG OUTPUT, (8) AC OUTPUT, (5) AC INPUT MODULES, PLC #2 W/(1) ETHERNET, (8) AC OUTPUT & (3) AC INPUT MODULES, ALLEN BRADLEY STRATIX 5700 ETHERNET CONTROLLER (NO WIRE OUTSIDE OF BOX)	761 SKK 10 HP/100 RPM GEARHEAD MOTOR W/DRIVE CHAIN (DRIVE FOR LOT 757)
	762 SKK 10 HP/100 RPM GEARHEAD MOTOR W/DRIVE CHAIN (DRIVE FOR LOT 758)

SWANSON GROUP GLENDALE SAWMILL - LIVE AUCTION 8/7/2019

LOT #

763 APPROX 21' 5-STRAND 81X TRANSFER FROM SORTER,

S-DRIVE, STEEL RACES & SUPPORTS

764 APPROX 17' 5-STRAND 81X TRANSFER FROM SORTER,

S-DRIVE, STEEL RACES & SUPPORTS

765 SKK

10 HP/100 RPM GEARHEAD MOTOR W/DRIVE CHAIN
(DRIVE FOR LOT 763)

766 SKK

7-1/2 HP/100 RPM GEARHEAD MOTOR W/DRIVE
CHAIN (DRIVE FOR LOT 764)

766Z SALE MOVES BACK TO TRIMMER OUTFEED AREA

**767 4-STRAND 110-DEGREE RADIUS TRANSFER TO SORTER
W/GEAR DRIVE BOX, MARKED SUPPORTS & CATWALK**

768 APPROX 21' 5-STRAND 81X LUGGED CHAIN TRANSFER,

H&T SPROCKETS & SUPPORTS

769 -

769Z SALE MOVES TO STACKER

770 IRVINGTON MOORE

20' HYDRAULIC OPERATED CONTINUOUS OVER
END STACKER W/DUAL 50 HP HYDRAULIC UNIT,
6-ARM X 56" LUMBER LOWERING PRIMARY HOIST,
7-ARM X 56" LUMBER LOWERING SECONDARY
HOIST, (5) LUMBER PLACING ARMS, (3) LATH
MAGAZINES, 30' 4-SECTION INFEED TRANSFER
SYSTEM, 24' 5-STRAND 81XHD W/SKK & CROSS
OVER ROLLCASE, MARKED CONTROLS & SUPPORT
EQUIPMENT, CATWALK, STAIRS & SUPPORTS

LOT #

771 APPROX 26' 5-STRAND 81XH TAKE AWAY TRANSFER,

S-DRIVE, STEEL RACES & SUPPORTS

772 APPROX 20' POWERED ROLLCASE W/(9) 8-1/2" X 60"

ROLLS, AIR BAGS & STEEL FRAME

773 SKK

25 HP GEARHEAD MOTOR W/DRIVE CHAIN (DRIVE
FOR LOT 771)

774 SKK

5 HP/56 RPM GEARHEAD MOTOR W/DRIVE CHAIN
(DRIVE FOR LOT 772)

**775 APPROX 12' 8-STRAND UNSCRAMBLER
W/HYDRAULIC DRIVE
MOTOR**

776 ALLEN BRADLEY CENTERLINE

9-SECTION MCC W/(28) SWITCHES, ALLEN BRADLEY
POWERFLEX 700 15 HP DRIVE (NO WIRE OUTSIDE OF
BOX)

777 ALLEN BRADLEY LOGIX 5561

PLC W/(2) ETHERNET & (1) DH+/RIO, (1) ANALOG
INPUT, (1) ANALOG OUTPUT, (6) AC INPUT & (4) AC
OUTPUT MODULES, 2ND PLC W/(1) ETHERNET, (3)
AC INPUT & (2) AC OUTPUT MODULES, ETHERTRAK
ETHERNET CONTROLLERS (NO WIRE OUTSIDE OF
BOX)

777Z SALE MOVES DOWN & OUTSIDE TOWARD TRACKS

778 1996 QNW 241DA

ROTARY SCREW COMPRESSOR W/50 HP MOTOR
VIN / Serial: 9602380

SWANSON GROUP GLENDALE SAWMILL - LIVE AUCTION 8/7/2019

<u>LOT #</u>	<u>LOT #</u>
779 LOT, ASSORTED AIR RECEIVERS & PIPING THROUGHOUT MILL SITE W/MARKED PIPING & ELECTRICS	788A SKK GEARHEAD MOTOR (NO DATA) W/DRIVE CHAIN (DRIVE FOR LOT 786)
779Z SALE MOVES BACK UNDER STACKER	788B SKK GEARHEAD MOTOR (NO DATA) W/DRIVE CHAIN (DRIVE FOR LOT 787)
780 20" X 30' CLEAN OUT CONVEYOR UNDER STACKER, H&T DRUM, STEEL TROUGH & SLOPING	789 SKK 5 HP/56 RPM GEARHEAD MOTOR W/DRIVE CHAIN (DRIVE FOR LOT 787)
781 APPROX 7' 5-STRAND H78B LUMBER LANDING TABLE, H-SHAFT & T-SPROCKETS	790 CONVEY KEYSTONE END SEAL & STENCIL STATIONS W/ALL PUMPS & MARKED ELECTRICS, CONTENTS OF WOOD BUILDING
782 SKK GEARHEAD MOTOR (NO DATA) W/DRIVE CHAIN (DRIVE FOR LOT 780)	791 APPROX 8' 2-STRAND INFEED TRANSFER W/S-DRIVE, STEEL RACES & SUPPORTS
783 SKK 3 HP/45 RPM GEARHEAD MOTOR W/DRIVE CHAIN (DRIVE FOR LOT 781)	792 APPROX 34' 2-STRAND & 4-STRAND OUTFEED TRANSFER W/S-DRIVE, STEEL RACES & SUPPORTS
784 SIGNODE BANDING CHOPPER	793A SKK GEARHEAD MOTOR (NO DATA) W/DRIVE CHAIN (DRIVE FOR LOT 790)
785 SIGNODE MHT-MP44 BANDER, MHT80 PLASTIC HEAD, BANDING FEEDER (NEW BANDING FEEDER INSTALLED IN 2017), CONVEY KEYSTONE DOUBLE MAGAZINE BATTEN FEEDER, MARKED CONTROLS, PLATFORM & STAIRS VIN / Serial: C547	793B SKK GEARHEAD MOTOR (NO DATA) W/DRIVE CHAIN (DRIVE FOR LOT 791)
786 APPROX 24' 2-STRAND INFEED TRANSFER W/9" X 60" ROLL, S-DRIVE, STEEL RACES & SUPPORTS	794 LOT, (6) APPROX 20' POP UP ROLLS
787 APPROX 24' 2-STRAND OUTFEED TRANSFER, S-DRIVE, STEEL RACES & SUPPORTS	795 SKK 5 HP/45 RPM GEARHEAD MOTOR W/DRIVE CHAIN (DRIVE FOR LOT 794)

SWANSON GROUP GLENDALE SAWMILL - LIVE AUCTION 8/7/2019

LOT #	LOT #
796 IRVINGTON MOORE	806 ALLEN BRADLEY POWERFLEX 700
HYDRAULIC OPERATED LOAD DOUBLER W/4' FORKS, HYDRAULIC UNIT W/(2) 50 HP PUMPS	7-1/2 HP DRIVE W/BRAKE (NO WIRE OUTSIDE OF BOX)
797 APPROX 28' 4-STRAND 81X OUTFEED TRANSFER	807 ALLEN BRADLEY POWERFLEX 700
W/S-DRIVE, STEEL RACES & SUPPORTS	7-1/2 HP DRIVE W/BRAKE (NO WIRE OUTSIDE OF BOX)
798 SKK	808 ALLEN BRADLEY
20 HP/125 RPM GEARHEAD MOTOR W/DRIVE CHAIN (DRIVE FOR LOT 797)	PLC 5/30 W/(1) DC INPUT, (5) AC INPUT, (3) AC OUTPUT MODULES, PANELVIEW 550 TOUCHSCREEN (NO WIRE OUTSIDE OF BOX)
799 LOT, (2) MARKED AIR HOSE REELS IN THIS DOORWAY & (1) MARKED AIR HOSE REEL BY LOT 789 PAINT STATION	809 ALLEN BRADLEY
	3-SECTION MCC W/(14) SWITCHES (NO WIRE OUTSIDE OF BOX)
800 SIGNODE MHT80	810 ALLEN BRADLEY SLC 500
PLASTIC BANDING HEAD	PLC W/(1) ADAPTOR, (1) AC INPUT & (4) AC OUTPUT MODULES, MARKED ELECTRICS (NO WIRE OUTSIDE OF BOX)
801 SIGNODE MHT80	810Z SALE MOVES TO PACKAGE SAW
PLASTIC BANDING HEAD	811 L&M
802 DANFOSS VLT-2800	7' PACKAGE SAW W/10 HP MOTOR,(3) SPARE BARS, 5 HP HYDRAULIC UNIT ON SCREW, 20' PACKAGE CARRIAGE W/MOTOR TO REDUCER DRIVE, 7' LIFT STATION, 48' CARRIAGE W/SIDE ROLLS, PLATFORM, STAIRS & CANOPY, AIR HOSE REELS & FLAMMABLES CABINET
1 HP DRIVE BY LOT 808 (NO WIRE OUTSIDE OF BOX)	812 23" X APPROX 27' CLEAN OUT BELT W/GEARHEAD MOTOR
803 ALLEN BRADLEY POWERFLEX 700	813 APPROX 21' PACKAGE ROLLCASE/BUMP STATION W/(7)
7-1/2 HP DRIVE W/BRAKE & CABINET (NO WIRE OUTSIDE OF BOX)	8-1/2" X 51" ROLLS, MOTOR TO SM CYCLO REDUCER DRIVE
804 ALLEN BRADLEY POWERFLEX 700	
7-1/2 HP DRIVE W/BRAKE (NO WIRE OUTSIDE OF BOX)	
805 ALLEN BRADLEY POWERFLEX 700	
7-1/2 HP DRIVE W/BRAKE (NO WIRE OUTSIDE OF BOX)	

SWANSON GROUP GLENDALE SAWMILL - LIVE AUCTION 8/7/2019

LOT #	LOT #
814 ALLEN BRADLEY 2-SECTION MCC W/(9) SWITCHES, (2) POWERFLEX 755 5 HP DRIVES (NO WIRE OUTSIDE OF BOX)	824 APPROX 12' DIA LONG NECK CYCLONE W/STAND & SPIRAL BLOWPIPE TO LOT 823
815 ALLEN BRADLEY LOGIX 5561 PLC W/(2) ETHERNET, (2) AC INPUT & (1) AC OUTPUT MODULES (NO WIRE OUTSIDE OF BOX)	825 PRECISION 30" X 30" CHIP FEEDER W/10 HP MOTOR TO DODGE TXTA8 SHAFT MOUNTED REDUCER, MARKED PIPING
816 APPROX 20" X 11' CLEAN OUT BELT TO TRIMMER, H&T DRUMS, STEEL TROUGH	826 RADER/SUTORBILT 8" X 20" HIGH PRESSURE BLOWER W/TOSHIBA 50 HP MOTOR, (2) STODDARD SILENCERS, MARKED PIPING
817 SKK 3 HP/100 RPM GEARHEAD MOTOR W/DRIVE CHAIN (DRIVE FOR LOT 816)	827 LOT, BAGHOUSE RELATED ELECTRICS W/(2) ALLEN BRADLEY 500F SERIES SIZE 3 & (2) SIZE 1 STARTERS, LIGHTING ELECTRICS, STEEL COVER (NO BUSS GUTTER OR WIRE OUTSIDE OF BOX)
818 APPROX 9' X 12' HYDRAULIC OPERATED TILT TABLE (TO LOT 816)	828 ALLEN BRADLEY REMOTE PLC W/(1) ETHERNET, (3) AC INPUT & (1) AC OUTPUT MODULES (NO WIRE OUTSIDE OF BOX)
819 LOT, (3) 7' SAW BARS	829 CLARKES PYROGUARD CXC-2 SPARK EXTINGUISHING SYSTEM W/(2) ZONES (LOCATED IN & NOT SOLD W/BLOWPIPE LOTS)
819Z SALE MOVES TO BAGHOUSE AREA	830 LOT, APPROX 42" SPIRAL BLOWPIPE (NO SENSORS) FROM TOP OF PLANER ROOF TO BAGHOUSE W/MARKED SUPPORTS
820 1997 WESTERN PNEUMATICS 630FLT BAGHOUSE FILTER, APPROX 66,000 CFM AT 8:1 CLOTH RATIO, 8,247 SQ FT CLOTH, APPROX 15' DIA X 45'H VIN / Serial: 169-97-18380	831 APPROX 6' DIA LONG NECK CYCLONE W/STAND (NO PIPING)
821 WESTERN PNEUMATICS RTF-23 46" LOW PRESSURE FAN W/TOSHIBA 250 HP/1,780 RPM MOTOR W/MARKED PIPING	832 APPROX 18' DIA SPIRAL BLOWPIPE FROM TRIMMER TO LOT 721 BLOWER & FROM LOT 721 BLOWER TO CYCLONE LOT 831
822 18" LOW PRESSURE FAN W/35 HP MOTOR (NO PIPING)	
823 CLARKES HI-SPEED ABORT GATE W/MARKED PIPING	

SWANSON GROUP GLENDALE SAWMILL - LIVE AUCTION 8/7/2019

LOT #	LOT #
833 APPROX 60-UNIT HYDRAULIC OPERATED MONO BIN W/CROSS TOP CONVEYOR, MARKED STAIRS, CATWALK & ELECTRICS	843 LOT, STEEL STICKER RACK W/3/4" X 1-1/2" X 53" LAMINATED STICKERS
834 APPROX 30-UNIT HYDRAULIC OPERATED BIN W/15 HP HYDRAULIC UNIT	844 LOT, STEEL STICKER RACK W/ASSORTED LENGTH 4X4'S
835 LOT, HIGH PRESSURE BLOWPIPE FROM SAWMILL W/STAND & SUPPORTS	845 LOT, STEEL STICKER RACK W/ASSORTED LENGTH 4X4'S
836 LOT, HIGH PRESSURE BLOWPIPE FROM PLANER W/STAND & SUPPORTS	846 LOT, STEEL RACK W/ASSORTED WOOD
837 LOT, HIGH PRESSURE BLOWPIPE FROM BAGHOUSE W/STAND & SUPPORTS	847 LOT, STEEL RACK W/ASSORTED WOOD
838 APPROX 12' DIA LONG NECK CYCLONE W/STAND & SPIRAL BLOWPIPE (NO SUPPORTS)	848 LOT, STEEL RACK W/ASSORTED WOOD
839 APPROX 6' DIA LONG NECK CYCLONE W/STAND	849 LOT, 48" BANDING BUNKS
839Z SALE MOVES TO BACK SIDE OF WAREHOUSE	850 LOT, ASSORTED TIMBERS & LUMBER
840 LOT, STEEL STICKER RACK W/3/4" X 1-1/2" X 53" LAMINATED STICKERS	851 SELF-DUMPING HOPPER (BLUE)
841 LOT, STEEL STICKER RACK W/3/4" X 1-1/2" X 53" LAMINATED STICKERS	852 SELF-DUMPING HOPPER (BLUE)
842 LOT, STEEL STICKER RACK W/3/4" X 1-1/2" X 53" LAMINATED STICKERS	853 SELF-DUMPING HOPPER (BLUE)
	854 SELF-DUMPING HOPPER (ORANGE)
	855 SELF-DUMPING HOPPER (YELLOW)
	856 SELF-DUMPING HOPPER (YELLOW)
	857 PUSH BLADE W/FORK POCKETS
	858 JILL POKE W/FORK POCKETS
	859A JILL POKE W/FORK POCKETS
	859B STEEL CHUTE W/FORK POCKETS
	860 32" TIMBER SAW W/10HP MOTOR, MARKED CONTROLS, STEEL BUILDING

James G. Murphy Co.

SWANSON GROUP GLENDALE SAWMILL - LIVE AUCTION 8/7/2019

LOT #	LOT #
860Z SALE MOVES TO TIMBER SAW	869 HYDRAULIC UNIT W/(2) PUMPS & MOTORS (NO DATA)
861 APPROX 33' 2-SECTION HYDRAULIC DRIVEN INFEED ROLLCASE W/(13) 8" X 30" ROLLS, TIMBER TURNER, (2) HYDRAULIC MOTORS, TIMBER TURN ARM & SUPPORTS	869Z SALE MOVES UNDER MILL BEHIND TIMBER WALL
862 APPROX 18' HYDRAULIC DRIVEN OUTFEED ROLLCASE W/(6) 8" X 30" ROLLS, 8'-18' TIMBER STOPS, TIMBER SLIDE ARMS & SUPPORTS	870 -
863 APPROX 18' 2-STRAND H78 W/FLITES CLEAN OUT CONVEYOR, H&T SPROCKETS, STEEL TROUGH & SUPPORTS	871 -
864 SKK 3 HP/125 RPM GEARHEAD MOTOR W/DRIVE CHAIN (DRIVE FOR LOT 863)	872 1978 QNW 740B ROTARY SCREW COMPRESSOR W/100 HP MOTOR W/AIR COOLER, STARTER & MARKED PIPING VIN / Serial: 781129
865 ALLEN BRADLEY 3-SECTION MCC W/(12) SWITCHES (NO WIRE OUTSIDE OF BOX)	873 30" X 72" AIR RECEIVER W/PIPING TO COMPRESSOR
866 APPROX 10' 6-STRAND C155D INFEED TRANSFER TO LOT 861 W/HYDRAULIC DRIVE MOTOR, H-SHAFT, T-SPROCKETS, MARKED STEEL SUPPORTS W/STEEL DECK ABOVE	874 APPROX 30" X 52' CLEAN OUT BELT CONVEYOR TO LOT 875, H&T DRUMS, STEEL TROUGH
867 APPROX 4-1/2' 4-STRAND H78B LUMBER LANDING TABLE TO LOT 866, H-SHAFT, T-SPROCKETS & STEEL PLATE	875 APPROX 14" X 43' CHEVRON BELT CONVEYOR W/(4) GRIZZLY ROLLS, H&T DRUMS, STEEL TROUGH & STEEL SLIDES
868 SKK GEARHEAD MOTOR (NO DATA) W/DRIVE CHAIN (DRIVE FOR LOT 867)	876 SKK 10 HP/100 RPM GEARHEAD MOTOR W/DRIVE CHAIN (DRIVE FOR LOT 874)
	877 SKK GEARHEAD MOTOR (NO DATA) W/DRIVE CHAIN (DRIVE FOR LOT 875)
	878 APPROX 32' BUCKET ELEVATOR TO SURGE BIN W/(58) APPROX 12" BUCKETS W/STRAIGHT SIDE CHAIN, DRIVE MOTOR

James G. Murphy Co.

SWANSON GROUP GLENDALE SAWMILL - LIVE AUCTION 8/7/2019

LOT #	LOT #
879 APPROX 30' BUCKET ELEVATOR TO SURGE BIN W/(50) APPROX 12" BUCKETS W/STRAIGHT SIDE CHAIN, DRIVE MOTOR	888 APPROX 30' 5"X9" BOX CHAIN CONVEYOR FROM LOT 886, H&T SPROCKETS, STEEL TROUGH
879Z SALE MOVES UPSTAIRS	889 SKK 3 HP/56 RPM GEARHEAD MOTOR W/DRIVE CHAIN (DRIVE FOR LOT 887)
880 CM&E 600SS 60" 6-KNIFE CHIPPER W/GE 150 HP/1,180 RPM MOTOR, DROP INFEED, BOTTOM OUTFEED	890 SKK GEARHEAD MOTOR (NO DATA) W/DRIVE CHAIN (DRIVE FOR LOT 888)
881 INERTIA EZ6-180-150 SOFT START (NO WIRE OUTSIDE OF BOX)	891 SUTORBILT/RADER 8" X 24" BLOWER W/75 HP/1,775 RPM MOTOR W/MARKED PIPING & SILENCER
882 APPROX 12' OUTFEED SCREW AUGER CONVEYOR W/SKK 5 HP/56 RPM GEARHEAD MOTOR	892 20" X 20" CHIP FEEDER W/MOTOR TO SHAFT MOUNTED REDUCER (NO PIPING)
883 MILL POWER 18" X 28' BALANCED VIBRATORY CONVEYOR W/5' FIBERGLASS TUB, SLOPING & SUPPORTS	893 LOT, MARKED ELECTRICS ON THIS WALL (NO BUSS GUTTER OR WIRE OUTSIDE OF BOXES)
884 RENS L240 METAL DETECTOR & COIL VIN / Serial: 082499	894 APPROX 20'W X 32'L X 40'H ALL STEEL BUILDING OVER MACHINERY TO INCLUDE STEEL DECKS, STAIRS & SUPPORTS (DOES NOT INCLUDE ANY WIRE OR CONDUIT, MACHINERY HAS PRIORITY OVER BUILDING)
885 APPROX 8'W X 8'L X 12'H LIVE BOTTOM SINGLE SCREW SURGE BIN W/MOTOR TO SHAFT MOUNTED REDUCER, SUPPORTS TO GROUND	895 -
886 ROTEX 5X8 2-DECK CHIP SCREEN, SUPPORTS TO GROUND	895Z SALE MOVES UNDER MILL
887 APPROX 47' STRAIGHT SIDE CHAIN W/FLITES CONVEYOR FROM LOT 886, H&T SPROCKETS, STEEL TROUGH	896 HYDRAULIC UNIT W/(1) 40 HP PUMP & ACCUMULATOR
	897 PFS HYDRAULIC UNIT W/(1) 40 HP & (1) 25 HP PUMP, ACCUMULATOR, COOLER, 210 GALLON

SWANSON GROUP GLENDALE SAWMILL - LIVE AUCTION 8/7/2019

LOT #	LOT #
898 PFS HYDRAULIC UNIT W/(2) 30 HP PUMPS, COOLER	910 APPROX 46' 6" X 11" W/FLITES BOX CHAIN CONVEYOR FROM LOT 911, S-DRIVE, STEEL TROUGH & RETURN
899 HYDRAULIC UNIT W/(1) 30 HP PUMP, COOLER	911 APPROX 39' 8" X 14" FLITES BOX CHAIN CONVEYOR TO LOT 911, S-DRIVE, STEEL TROUGH & RETURN
900 550 GALLON TANK W/(5) TRANSFER PUMPS	912 APPROX 32' 6" X 11" BOX CHAIN CONVEYOR TO LOT 903, H&T SPROCKETS, STEEL TROUGH & SLOPING
901 240 GALLON TANK	913 SKK GEARHEAD MOTOR (NO DATA) W/DRIVE CHAIN (DRIVE FOR LOT 910)
902 BLUE APPROX 42' 6" X 11" W/FLITES BOX CHAIN CLEAN OUT CONVEYOR, S-DRIVE, RETURN & SLOPING	914 SKK 10 HP/56 RPM GEARHEAD MOTOR W/DRIVE CHAIN (DRIVE FOR LOT 911)
903 30" X APPROX 120' CLEAN OUT BELT CONVEYOR TO VIBRATORY, H&T DRUMS, STEEL TROUGH	915 SKK GEARHEAD MOTOR (NO DATA) W/DRIVE CHAIN (DRIVE FOR LOT 912)
904 APPROX 16" X 28" CLEAN OUT BELT CONVEYOR TO LOT 903, H&T DRUMS, STEEL TROUGH	915Z SALE MOVES TOWARD CHIPPER AREA
905 BALDOR 5 HP MOTOR TO FALK REDUCER W/DRIVE CHAIN (DRIVE FOR LOT 902)	916 HYDRAULIC UNIT W/(1) 30 HP PUMP, HEAT EXCHANGER
906 SKK GEARHEAD MOTOR (NO DATA) W/DRIVE CHAIN (DRIVE FOR LOT 903)	917 APPROX 6' DIA CYCLONE W/GREEN BLOWPIPE TO CHIPPER
907 SKK 10 HP/100 HP GEARHEAD MOTOR W/DRIVE CHAIN (DRIVE FOR LOT 904)	918 APPROX 10'L X 8'W X 10'H DOUBLE SCREW LIVE BOTTOM SURGE BIN W/MARKED SUPPORT FRAME, CATWALK & LADDERS
908 LOT, MARKED ASSORTED ELECTRICS (NO BUSS GUTTER OR WIRE OUTSIDE OF BOXES)	919 BM&M 4X82D 2-DECK CHIP SCREEN W/MARKED SUPPORT FRAME
909 LOT, MARKED ASSORTED ELECTRICS (NO BUSS GUTTER OR WIRE OUTSIDE OF BOXES)	

SWANSON GROUP GLENDALE SAWMILL - LIVE AUCTION 8/7/2019

LOT #	LOT #
920 2000 WESTERN PNEUMATICS	929 RADER 8X24V-3000
20" X 25" CCW FEEDER W/DRIVE & MARKED PIPING	8" X 24" BLOWER W/TOSHIBA 50 HP MOTOR, STODDARD SILENCER, MARKED PIPING
921 CM&E NORMAN 50	929Z SALE MOVES INTO ELECTRICAL ROOM
16-KNIFE CHIPPER W/GE 100 HP/880 RPM MOTOR, DROP INFEED, TOP OUTFEED, BOLT ON THROAT PLATE, MARKED STEEL COVER	930 ALLEN BRADLEY SMC FLEX
922 APPROX 18" X APPROX 36" INFEED BELT CONVEYOR TO CHIPPER W/5' FIBERGLASS TUB, S-DRIVE, STEEL TROUGH, MARKED CATWALK & STAIRS	100 HP DRIVE (NO BREAKER, SWITCH OR WIRE OUTSIDE OF BOX)
923 SKK	931 ALLEN BRADLEY CENTERLINE
7-1/2 HP/56 RPM GEARHEAD MOTOR W/DRIVE CHAIN (DRIVE FOR LOT 922)	5-SECTION MCC W/(15) SWITCHES (NO WIRE OUTSIDE OF BOX)
924 2016 MDI CR-853000	932 ALLEN BRADLEY LOGIX 5571
METAL DETECTOR DIGITAL CONTROL CHASSIS W/XR-9 FUNCTION BLOCK 40-200 FPM, S/N:V1022, 20" X 36" XR3000 COIL (NO TROUGH) VIN / Serial: EV10873	PLC W/(1) ETHERNET, (2) DC INPUT, (1) DC OUTPUT, (4) AC OUTPUT & (2) AC INPUT MODULES, SOLA CVS & SIEMENS 120/240V, SINGLE PHASE LIGHTING PANEL (NO WIRE OUTSIDE OF BOX)
925 18" X 36' OUTFEED BELT CONVEYOR FROM SCREEN, H&T DRUMS, STEEL TROUGH	933 LOT, REMAINING LOOSE CONTENTS OF THIS ROOM
926 18" X 13' OUTFEED BELT CONVEYOR FROM SCREEN, H&T DRUMS, STEEL TROUGH	934 HPS
927 SKK	240 X 480HV TO 120/240LV X 50 KVA SINGLE PHASE TRANSFORMER W/BLOWER CONTROL BOXES (NO WIRE OUTSIDE OF BOX)
5 HP/56 RPM GEARHEAD MOTOR W/DRIVE CHAIN (DRIVE FOR LOT 925)	934Z SALE MOVES TOWARD COMPRESSORS
928 SKK	935 APPROX 6' DIA DUST COLLECTOR W/APPROX 24" 10 HP BLOWER W/PIPING FROM FILING ROOM, ROTARY AIR LOCK & DUMPSTER, STEEL FRAME
3 HP/100 RPM GEARHEAD MOTOR W/DRIVE CHAIN (DRIVE FOR LOT 926)	936 1997 PNEUMATECH EE-1500
	HEAT ACTIVATED REGENERATIVE AIR DRYER, 1,500 SCFM AT 150-DEGREES W/ATTACHED STARTER & 400 AMP DISCONNECT, MARKED PIPING VIN / Serial: 9708-521723485636

SWANSON GROUP GLENDALE SAWMILL - LIVE AUCTION 8/7/2019

LOT #**937 1997 QNW 751D**

ROTARY SCREW COMPRESSOR W/150 HP MOTOR &
DISCONNECT, AIR COOLED, MARKED PIPING
VIN / Serial: 970426C

938 1994 PNEUMATECH EE-1100

HEATLESS REGENERATIVE AIR DRYER, 1,100 SCFM
AT 150-DEGREES W/(2) INLINE FILTERS, MARKED
PIING
VIN / Serial: 9410-S118691-64232

939 APPROX 36" X 96" AIR RECEIVER**940 APPROX 6" X 10' PORTABLE SCREW AUGER
CONVEYOR**

W/GEARHEAD MOTOR

**941 60 HP HYDRAULIC UNIT (FOR LOT 500
RESAW)****942 MILL POWER**

36" X 28' BALANCED VIBRATORY CONVEYOR INTO
LOT 349

**942Z SALE MOVES AROUND LOT 349 VIBRATORY
CONVEYOR TO
CONVEYOR BETWEEN BUILDINGS****943 20" X APPROX 69' CLEAN OUT CONVEYOR
W/S-DRIVE,**

STEEL TROUGH & SUPPORTS

944 SKK

5 HP/56 RPM GEARHEAD MOTOR W/DRIVE CHAIN
(DRIVE FOR LOT 943)

945 LOT, ASSORTED WIRE ON REELS**LOT #****945Z SALE MOVES BACK UNDER SAWMILL
TOWARD ROAD****946 ALLEN BRADLEY**

PLC W/(1) ETHERNET & (1) DH+/RIO MODULE (NO
WIRE OUTSIDE OF BOX)

**947 LOT, (2) PLC CABINETS W/PLC 5/40E &
REMOTE PLC
(FOR LOT 555 GANG, NO WIRE OUTSIDE OF BOX)****948 ALLEN BRADLEY**

6-SECTION MCC W/(30) SWITCHES, (1) POWERFLEX
755 7-1/2 HP DRIVE, (1) POWERFLEX 700 5 HP DRIVE
(NO WIRE OUTSIDE OF BOX)

949 ALLEN BRADLEY

LOT, FUSED STARTERS, DISCONNECTS & MARKED
ELECTRICS (NO WIRE OUTSIDE OF BOX)

949Z SALE MOVES INTO NEXT ROOM**950 -****951 LOT, ASSORTED MARKED ELECTRICS IN LOT
948 AREA****951Z SALE MOVES OUT UNDER MILL TOWARD
KILNS****952 LOT, ASSORTED PLASTIC PIPE NEXT TO
WALKWAY****953 LOT, ASSORTED CLEAN UP TOOLS IN WOOD
CABINET BY
LOT 349 VIBRATORY CONVEYOR****954 LOT, ASSORTED PIKE POLES, STEEL STOCK
& MILL
PARTS Y LOT 940 CONVEYOR**

James G. Murphy Co.

SWANSON GROUP GLENDALE SAWMILL - LIVE AUCTION 8/7/2019

<u>LOT #</u>	<u>LOT #</u>
955 LOT, ASSORTED PARTS IN THIS AREA	970 LOT, ASSORTED UHMW ROUND STOCK
955Z SALE MOVES INTO PARTS ROOM	971 LOT, AIR VALVES & ASSORTED ITEMS ON WOOD SHELF
956 LOT, BUSHINGS	972 LOT, AIR VALVES & ASSORTED ITEMS ON WOOD SHELF
957 LOT, REMAINING MARKED CONTENTS OF THIS ROOM	973 LOT, ASSORTED MILL PARTS ON WOOD SHELVES W/MARKED METAL CABINETS
958 LOT, PARTS BIN W/CHAIN PINS	974 LOT, ASSORTED MILL PARTS ON WOOD SHELVES
959 LOT, (2) PARTS BINS W/KEY STOCK & ASSORTED ITEMS	975 LOT, ASSORTED TOOLS & SUPPLIES IN CAGE AREA
960 LOT, (2) PARTS W/NUTS, BOLTS & ASSORTED ITEMS	975Z SALE MOVES INTO NEXT PARTS ROOM
961 LOT, (2) PARTS W/NUTS, BOLTS & ASSORTED ITEMS	976 LOT, ASSORTED HOSE, SPRAYERS, FILTERS & ASSORTED ITEMS IN THIS AREA
962 LOT, (2) PARTS W/NUTS, BOLTS & ASSORTED ITEMS	977 DEWALT D28715 14" CUT OFF SAW W/TABLE
963 LOT, (2) PARTS W/NUTS, BOLTS & ASSORTED ITEMS	978 GATES PC707 HYDRAULIC HOSE CRIMPER W/DIES
964 LOT, (2) PARTS W/NUTS, BOLTS & ASSORTED ITEMS	979 LOT, AIR HOSE
965 LOT, (2) PARTS W/NUTS, BOLTS & ASSORTED ITEMS	980 LOT, (8) ASSORTED BOLT BINS W/CONTENTS
966 LOT, (2) PARTS W/NUTS, BOLTS & ASSORTED ITEMS	981 LOT, ASSORTED KEY KNIFE STOCK, VALVES, HOSE BLOCK & STEEL STAND
967 LOT, PARTS BIN W/CHAIN LINKS	982 LOT, ASSORTED HYDRAULIC HOSE FITTINGS, HYDRAULIC MOTORS, NUTS & BOLTS IN THIS AREA
968 LOT, ASSORTED CHAIN	
969 LOT, ASSORTED PARTS & SUPPLIES ON WOOD SHELF W/CABLE	

SWANSON GROUP GLENDALE SAWMILL - LIVE AUCTION 8/7/2019

LOT #	LOT #
983 LOT, ASSORTED MARKED ELECTRICS & LIGHTING IN THIS AREA (NO BUSS GUTTER OR WIRE OUTSIDE OF BOX)	999 LOT, ASSORTED SAWHORSES & TRIPOD
984 LOT, ASSORTED BELT PULLEYS IN THIS AREA	1000 -
985 LOT, ASSORTED BELT PULLEYS IN THIS AREA	1000Z SALE MOVES TO LUMBER SHED BY POND
986 LOT, ASSORTED SPROCKETS IN THIS AREA	1001 PARAMAX 39.190:1 RATIO REDUCER (FITS QUADRANT FEEDER LOT 210)
987 LOT, ASSORTED SPROCKETS IN THIS AREA	1002 LOT, BELL CRANK & DOG BONES (FITS QUADRANT FEEDER LOT 210)
988 LOT, ASSORTED SPROCKETS IN THIS AREA	1003 LINDSAY DEBARKER ARMS (FITS A7 DEBARKER-NOT IN SALE)
989 LOT, ASSORTED SPROCKETS IN THIS AREA	1004 HOURGLASS ROLL (FITS MERCHANDISER LOT 233)
990 LOT, ASSORTED SPROCKETS IN THIS AREA	1005 IDLER ROLL FOR 124 CHAIN (FITS LOG HAUL LOTS 211 & 212)
991 STEEL 2-DOOR LOCKER	1006 24" X 42" HOURGLASS ROLL (FITS MERCHANDISER LOT 233)
992 LOT, (2) WOOD LOCKERS	1007 LOT, BELL CRANKS & DOG BONES (FITS STEP FEEDER LOT 305)
993 LOT, (2) WOOD LOCKERS	1008 LOT, LOG KICKERS (FITS LOG ORIENTER LOT 299)
994 LOT, (2) WOOD LOCKERS	1009 LOT, LOG KICKERS (FITS LOG ORIENTER LOT 299)
995 LOT, (2) WOOD LOCKERS	1010 LOG KICKER
995Z SALE MOVES OUTSIDE TO THE OTHER SIDE OF WALL W/SPROCKETS	
996 LOT, ASSORTED SPROCKETS IN THIS AREA	
997 LOT, ASSORTED SPROCKETS IN THIS AREA	
998 LOT, ASSORTED SPROCKETS IN THIS AREA	

SWANSON GROUP GLENDALE SAWMILL - LIVE AUCTION 8/7/2019

LOT #	LOT #
1011 LOG KICKER	1022 LOT, ASSORTED KNURLED ROLLS (FITS BOARD EDGER LOT 520)
1012 LOG KICKER	1023 LOT, ASSORTED KNURLED ROLLS (FITS BOARD EDGER LOT 520)
1013 LOT, (17) HAMMER HOG GRATES (FITS HAMMER HOG LOT 371)	1024 LOT, ASSORTED KNURLED ROLLS (FITS BOARD EDGER LOT 520)
1014 LOT, (12) HAMMER HOG HAMMERS W/REPLACEABLE TIPS (FITS HAMMER HOG LOT 371)	1025 LOT, ASSORTED DOUBLE LENGTH INFEED PARTS (NOT FOR DLI LOCATED ON SITE)
1015 LOT, (32) HAMMER HOG HAMMER REPLACEABLE TIPS (FITS HAMMER HOG LOT 371)	1026 LOT, ASSORTED DOUBLE LENGTH INFEED PARTS (NOT FOR DLI LOCATED ON SITE)
1016 SALEM LOT, 5' TWIN PARTS (FITS SALEM 5' TWIN RESAW LOT 500)	1027 LOT, ASSORTED DOUBLE LENGTH INFEED PARTS (NOT FOR DLI LOCATED ON SITE)
1017 SALEM LOT, 5' TWIN PARTS (FITS SALEM 5' TWIN RESAW LOT 500)	1028 LOT, ASSORTED DOUBLE LENGTH INFEEDS (NOT FOR DLI LOCATED ON SITE)
1018 SALEM LOT, 5' TWIN PARTS (FITS SALEM 5' TWIN RESAW LOT 500)	1029 LOT, (10) 124A PLATE SPROCKETS
1019 LOT, ASSORTED KNURLED ROLLS (FITS GANG EDGER LOT 555)	1030 THERMA TRANSFER A0-40 HEAT EXCHANGER, 300 PSI
1020 LOT, ASSORTED KNURLED ROLLS (FITS GANG EDGER LOT 555)	1031 LOT, ASSORTED ACCUMULATORS
1021 LOT, ASSORTED CHIP HEAD RAILS (FITS BOARD EDGER LOT 525)	1032 LOT, ASSORTED SPROCKETS & BELT PULLEYS

SWANSON GROUP GLENDALE SAWMILL - LIVE AUCTION 8/7/2019

<u>LOT #</u>	<u>LOT #</u>
1033 NORMAN LOT, ASSORTED CHIPPER PARTS	1044 LOT, ASSORTED CYLINDERS ON THIS PALLET (FITS ASSORTED MACHINERY)
1034 LOT, ASSORTED CYLINDERS ON THIS PALLET (FITS ASSORTED MACHINERY)	1045 LOT, ASSORTED CYLINDERS ON THIS PALLET (FITS ASSORTED MACHINERY)
1035 LOT, ASSORTED CYLINDERS ON THIS PALLET (FITS ASSORTED MACHINERY)	1046 LOT, ASSORTED CYLINDERS ON THIS PALLET (FITS ASSORTED MACHINERY)
1036 LOT, ASSORTED CYLINDERS ON THIS PALLET (FITS ASSORTED MACHINERY)	1047 LOT, ASSORTED CYLINDERS ON THIS PALLET (FITS ASSORTED MACHINERY)
1037 LOT, ASSORTED CYLINDERS ON THIS PALLET (FITS ASSORTED MACHINERY)	1048 LOT, ASSORTED CYLINDERS ON THIS PALLET (FITS ASSORTED MACHINERY)
1038 LOT, ASSORTED CYLINDERS ON THIS PALLET (FITS ASSORTED MACHINERY)	1049 LOT, ASSORTED CYLINDERS ON THIS A PALLET (FITS ASSORTED MACHINERY)
1039 LOT, ASSORTED CYLINDERS ON THIS PALLET (FITS ASSORTED MACHINERY)	1049B LOT, ASSORTED CYLINDERS ON THIS PALLET (FITS ASSORTED MACHINERY)
1040 LOT, ASSORTED CYLINDERS ON THIS PALLET (FITS ASSORTED MACHINERY)	1049 LOT, (5) MERCHANDISER CYLINDERS (FITS C LOTS 220-227)
1041 LOT, ASSORTED CYLINDERS ON THIS PALLET (FITS ASSORTED MACHINERY)	1049 BIN SORTER CYLINDER (FITS LOT 750) D
1042 LOT, ASSORTED CYLINDERS ON THIS PALLET (FITS ASSORTED MACHINERY)	1050 BALDOR 5 HP/1,755 RPM MOTOR W/STEARNS BRAKE (UNUSED)
1043 LOT, ASSORTED CYLINDERS ON THIS PALLET (FITS ASSORTED MACHINERY)	1051 TOSHIBA 15 HP/1,755 RPM MOTOR

SWANSON GROUP GLENDALE SAWMILL - LIVE AUCTION 8/7/2019

<u>LOT #</u>	<u>LOT #</u>
1052 TOSHIBA	1064 GE
15 HP/1,755 RPM MOTOR W/PUMP	GEARHEAD MOTOR (NO DATA)
1053 LOT, (2) PALLETS W/(5) MOTORS	1065 REX MERCURY
1054 NORD	126 RPM REDUCER W/BASE
5 HP/9.80:1 RATIO GEARHEAD MOTOR (UNUSED)	1066 REX MERCURY
1055 TOSHIBA	126 RPM REDUCER
5 HP/REX MERCURY 126 RPM GEARHEAD MOTOR	1067 HAMPTON MAKISHINKO
1056 TOSHIBA	REDUCER (NO DATA)
5 HP/REX MERCURY 126 RPM GEARHEAD MOTOR	1068 MORSE
1057 TOSHIBA	10:1 RATIO REDUCER
5 HP/REX MERCURY 126 RPM GEARHEAD MOTOR	1069 HUB CITY
1058 WEG	RIGHT ANGLE GEAR 1:1 RATIO
3 HP/REX MERCURY 126 RPM GEARHEAD MOTOR	1070 HUB CITY
1059 TOSHIBA	RIGHT ANGLE GEAR 1:1 RATIO
3 HP/REX MERCURY 126 RPM GEARHEAD MOTOR	1071 LOT, (4) REDUCERS ON THIS PALLET
1060 WEG	1072 BALDOR
3 HP/REX MERCURY 126 RPM GEARHEAD MOTOR	7-1/2 HP/1,770 RPM MOTOR, HAMPTON MAKISHINKO REDUCER
1061 TOSHIBA	1073 TOSHIBA
3 HP/REX MERCURY 126 RPM GEARHEAD MOTOR	5 HP/1,775 RPM MOTOR TO DODGE SHAFT MOUNTED REDUCER
1062 SKK	1074 BREVINI EB2065-FS
10 HP/25 RPM GEARHEAD MOTOR	HYDRAULIC DRIVE MOTOR
1063 SKK	
GEARHEAD MOTOR (NO DATA)	

James G. Murphy Co.

SWANSON GROUP GLENDALE SAWMILL - LIVE AUCTION 8/7/2019

<u>LOT #</u>	<u>LOT #</u>
1075 LEESON	1088 -
3/4 HP/1,725 RPM MOTOR W/HYDRAULIC PUMP	1089 -
1076 LOT, ASSORTED HYDRAULIC MOTORS	1090 -
1077 HAMPTON	1091 -
LOT, ASSORTED SPEED REDUCERS ON THIS PALLET	1092 -
1078 HAMPTON	1093 -
LOT, ASSORTED SPEED REDUCERS ON THIS PALLET	1094 -
1079 1994 QNW 751-D	1095 -
ROTARY SCREW COMPRESSOR, 150 HP VIN / Serial: 990493C	1096 -
1080 STEEL FRAME W/FORK POCKET	1097 -
1081 STEEL FRAME W/ADJUSTABLE TABLE W/FORK POCKETS	1098 -
1082 STEEL CART	1099 -
1083 LUMBER WRAP STATION	1100 -
1084 2001 REFORM 51	1100Z SALE MOVES TO WAREHOUSE (NOTE: NO SHELVING IN SALE)
TRAVELING HEAD KNIFE GRINDER W/3,100 MM MAGNETIC CHUCK VIN / Serial: 7039	1101 MTS
1085 CALIFORNIA CEDAR PRODUCTS TRINCHERA BRAZER	LOT, (6) TEMPOSONIC WANDS, APPROX 102" & 110" (PLEASE CHECK LENGTH)
CARBIDE TIPPER SAW	1102 MTS
1086 CALIFORNIA CEDAR PRODUCTS DYNAMIC	LOT, (4) TEMPOSONIC WANDS, APPROX 50" (PLEASE CHECK LENGTH)
TEST STAND	1103 MTS
1087 -	LOT, (4) TEMPOSONIC WANDS, APPROX 40" & 62" (PLEASE CHECK LENGTH)

10% BUYERS PREMIUM ON ALL ITEMS
15% BUYERS PREMIUM ON ALL ONLINE PURCHASES

SWANSON GROUP GLENDALE SAWMILL - LIVE AUCTION 8/7/2019

LOT #	LOT #
1104 MTS R-SERIES	1114 ALLEN BRADLEY DIALOG PLUS 150-B180NBDD
LOT, (3) TEMPOSONIC WANDS, 28" & 32" (PLEASE CHECK LENGTH)	150 HP SMART MOTOR CONTROLLER
1105 MTS G-SERIES	1115 BALDOR ZD8H340-E0
LOT, (5) TEMPOSONIC WANDS, 20", 32" & 40" (PLEASE CHECK LENGTH)	30 HP DRIVE
1106 MTS G-SERIES	1116 MITSUBISHI A500 FR-A540-22K-NA
LOT, (6) TEMPOSONIC WANDS, 16" & 28" (PLEASE CHECK LENGTH)	LOT, (2) 40 HP DRIVES
1107 MTS G-SERIES	1117 BALDOR ZD18H407-E
LOT, (6) TEMPOSONIC WANDS, 16" (PLEASE CHECK LENGTH)	LOT, (2) 7-1/2 HP DRIVES
1108 LOT, (1) LPS & (5) MTS TEMPOSONIC WANDS, 18", 26" & 32" (PLEASE CHECK LENGTH)	1118 ALLEN BRADLEY SIZE 3
1109 MTS R-SERIES	50 HP STARTER (IN BUCKET W/DOOR)
LOT, (5) TEMPOSONIC WANDS, 26", 32" & 52" (PLEASE CHECK LENGTH)	1119 LOT, ASSORTED CYLINDERS (NO RACK)
1110 MTS G-SERIES	1120 AUBURN GEAR POWER WHEEL
LOT, (6) TEMPOSONIC WANDS, 10", 32", 34" & 40" (PLEASE CHECK LENGTH)	HYDRAULIC MOTOR (REBUILT)
1111 MTS	1121 AUBURN GEAR POWER WHEEL
LOT, (9) TEMPOSONIC WANDS, 9", 15" & 27" (PLEASE CHECK LENGTH) W/MARKED PARTS IN BOTTOM OF WOOD CABINET	HYDRAULIC MOTOR (UNUSED)
1112 ALLEN BRADLEY SMC-FLEX 150-F317NBDD	1122 HYDRAULIC DRIVE MOTOR (UNUSED)
250 HP SMART MOTOR CONTROLLER	1123 HYDRAULIC DRIVE MOTOR (UNUSED)
1113 MITSUBISHI A500-400V CLASS	1124 ADJUSTABLE MOTOR BASE
INVERTER	1125 LOT, 40' OF SUMMIT 81X SHARP CHAIN (UNUSED)
	1126 LOT, 50' OF SUMMIT 81X SHARP CHAIN (UNUSED)

SWANSON GROUP GLENDALE SAWMILL - LIVE AUCTION 8/7/2019

<u>LOT #</u>	<u>LOT #</u>
1127 LOT, 50' OF SUMMIT 81X SHARP CHAIN (UNUSED)	1139 LOT, ASSORTED PARTS ON THIS 1/2 SHELF & FLOOR (FOR ASSORTED MERCHANDISER MACHINERY)
1128 LOT, 50' OF SUMMIT 81X SHARP CHAIN (UNUSED)	1140 - A
1129 LOT, 50' OF ALI066 CHAIN (UNUSED)	1140B LOT, ASSORTED PARTS ON THIS 1/2 SHELF (FOR LOT 500 TWIN BANDSAW)
1130 LOT, 40' OF 60-IP2PADP CHAIN (UNUSED)	1141 LOT, ASSORTED PARTS ON THIS 1/2 SHELF (FOR LOT 600 HEMCO TRIMMER)
1130Z SALE MOVES TO BACK WALL	1142 LOT, ASSORTED PARTS ON THIS 1/2 SHELF (FOR LOT 600 HEMCO TRIMMER)
1131 LOT, ASSORTED PARTS IN THIS AREA (FOR LOT 811 PACKAGE SAW)	1143 LOT, ASSORTED PARTS ON THIS 1/2 SHELF (FOR LOT 520 SCHURMAN BOARD EDGER)
1132 LOT, ASSORTED PARTS ON THIS SHELF (FOR LOT 866 ROTEX SCREEN)	1144 LOT, ASSORTED PARTS ON THIS 1/2 SHELF (FOR LOT 555 SCHURMAN/USNR GANG EDGER)
1133 LOT, ASSORTED PARTS ON THIS 1/2 SHELF (FOR LOT 305 LINDEN 4-STEP FEEDER)	1145 LOT, ASSORTED PARTS ON THIS 1/2 SHELF (FOR LOT 555 SCHURMAN/USNR GANG EDGER)
1134 LOT, ASSORTED PARTS ON THIS 1/2 SHELF (FOR LOG KICKERS)	1146 COTTERMAN A 350 LB CAPACITY 5' ROLLING WAREHOUSE LADDER
1135 LOT, ASSORTED PARTS ON THIS SHELF (FOR ASSORTED CHIPPERS)	1146B MTS LOT, (4) TEMPOSONIC PROBES
1136 LOT, ASSORTED PARTS ON THIS SHELF (FOR LOT 305 LINDEN 4-STEP FEEDER)	1146B SALE MOVES TO BACK ROW OF SHELVING Z
1137 LOT, ASSORTED PARTS ON THIS SHELF (FOR LOT 316 10-STEP LOG LADDER)	1147 WOODWARD R-DDV LOT, (4) SERVO VALVES
1138 LOT, ASSORTED PARTS ON THIS 1/2 SHELF (FOR LOT 601 SEC BOARD FENCE)	

SWANSON GROUP GLENDALE SAWMILL - LIVE AUCTION 8/7/2019

LOT #	LOT #
1148 WOODWARD R-DDV LOT, (4) SERVO VALVES	1161 LOT, ASSORTED FILTERS ON THIS SHELF
1149 WOODWARD R-DDV LOT, (4) SERVO VALVES	1162 LOT, ASSORTED FILTERS ON THIS SHELF
1150 WOODWARD R-DDV LOT, (4) SERVO VALVES	1163 LOT, ASSORTED FILTERS ON THIS SHELF
1151 WOODWARD R-DDV LOT, (4) SERVO VALVES	1164 LOT, ASSORTED VALVES & PARTS ON THESE (3) SHELVES
1152 WOODWARD R-DDV LOT, SERVO VALVES	1165 LOT, ASSORTED VALVES & PARTS ON THESE (2) SHELVES
1152Z SALE MOVES TO NEXT SHELF	1165Z SALE MOVES TO NEXT SHELF
1153 LOT, ASSORTED PARTS ON THESE (2) SHELVES	1166 LOT, ASSORTED COUPLERS ON THESE (3) SHELVES
1154 LOT, ASSORTED PARTS ON THESE (4) SHELVES	1167 LOT, ASSORTED CYLINDER PARTS ON THESE (3) SHELVES
1155 LOT, ASSORTED AIR VALVES & PARTS ON THIS SHELF	1168 LOT, ASSORTED BELT DRUMS & ASSORTED ITEMS ON THESE (3) SHELVES
1156 LOT, ASSORTED AIR VALVES & PARTS ON THIS SHELF	1169 LOT, ASSORTED SPROCKETS ON THESE (2) SHELVES
1157 LOT, ASSORTED AIR VALVES & PARTS ON THIS SHELF	1170 LOT, ASSORTED MOTOR COVERS ON THESE (2) SHELVES
1158 LOT, ASSORTED AIR VALVES & PARTS ON THIS SHELF	1170Z SALE MOVES TO NEXT SHELF
1159 LOT, ASSORTED FILTERS ON THIS SHELF	1171 LOT, ASSORTED HYDRAULIC MOTORS, BELT PULLEYS & ASSORTED ITEMS ON THESE (4) SHELVES
1160 LOT, ASSORTED FILTERS ON THIS SHELF	1172 LOT, ASSORTED MOTOR COVERS & CONDUIT FITTINGS ON THESE (3) SHELVES
	1173 LOT, ASSORTED BEARINGS ON THESE (2) SHELVES

SWANSON GROUP GLENDALE SAWMILL - LIVE AUCTION 8/7/2019

<u>LOT #</u>	<u>LOT #</u>
1174 LOT, ASSORTED SCANNER HEADS & PARTS ON THIS SHELF	1185 LOT, ASSORTED CHAIN LINKS ON THIS SHELF
1175 LOT, ASSORTED HYDRAULIC MOTORS & PARTS ON THESE (2) SHELVES	1186 LOT, ASSORTED BANDSAWS ON THIS SHELF
1175Z SALE MOVES TO NEXT SHELF	1187 LOT, ASSORTED BANDSAWS ON THIS SHELF
1176 LOT, ASSORTED PLC RACKS ON THESE (2) SHELVES	1188 LOT, ASSORTED TRACK & PARTS ON THESE (2) SHELVES
1177 LOT, ASSORTED ELECTRICAL ON THESE (3) SHELVES	1189 LOT, ASSORTED ELECTRICAL ON THESE (2) SHELVES
1178 LOT, (2) SHAFTS (FOR LOT 500 SALEM TWIN BAND RESAW)	1190 LOT, ASSORTED ELECTRICAL ON THESE (2) SHELVES
1179 LOT, (2) SHAFTS (FOR LOTS 220-227 MERCHANDISER HOURGLASS ROLLCASE)	1191 LOT, ASSORTED ELECTRICAL ON THESE (3) SHELVES
1180 LOT, (2) SHAFTS (FOR LOT 600 HEMCO TRIMMER CLUTCH)	1191Z SALE MOVES TO NEXT SHELF
1181 LOT, 8" BELTING (FOR LOT 595 TRAY SORTER OUTFEED TIPPLE)	1192 LOT, ASSORTED ELECTRICAL ON THESE (3) SHELVES
1182 LOT, ASSORTED FLEX HOSE ON THESE (2) SHELVES	1193 LOT, ASSORTED ELECTRICAL ON THESE (3) SHELVES
1182Z SALE MOVES TO NEXT SHELF	1194 LOT, ASSORTED ELECTRICAL ON THESE (4) SHELVES
1183 LOT, ASSORTED CHAIN ON THIS SHELF	1194Z SALE MOVES TO NEXT SHELF
1184 LOT, ASSORTED CHAIN ON THIS SHELF	1195 LOT, ASSORTED ELECTRICAL ON THESE (2) SHELVES
	1196 LOT, ASSORTED ELECTRICAL ON THESE (2) SHELVES
	1197 LOT, ASSORTED ELECTRICAL ON THESE (3) SHELVES
	1197Z SALE MOVES TO NEXT SHELF

SWANSON GROUP GLENDALE SAWMILL - LIVE AUCTION 8/7/2019

LOT #	LOT #
1198 LOT, ASSORTED ELECTRICAL ON THESE (3) SHELVES	1211 APPROX 2-1/2"THICK X 48"W X 168"L WOOD CONFERENCE TABLE
1199 LOT, ASSORTED ELECTRICAL ON THESE (3) SHELVES	1212 LOT, MARKED FURNITURE IN THESE (2) ROOMS
1200 LOT, ASSORTED ELECTRICAL ON THESE (3) SHELVES	1213 LOT, (4) ASSORTED PRINTERS
1200Z SALE MOVES TO NEXT SHELF	1214 TRIPP LITE LOT, (5) BATTERY SURGE & NOISE PROTECTORS
1201 LOT, ASSORTED BELTS ON THIS SHELF (UNUSED)	1215 TRIPP LITE LOT, (5) BATTERY SURGE & NOISE PROTECTORS
1202 LOT, ASSORTED BELTS ON THIS SHELF (UNUSED)	1216 LOT, (4) ASSORTED BATTERY SURGE & NOISE PROTECTORS
1203 LOT, ASSORTED BELTS ON THIS SHELF (UNUSED)	1217 LOT, (4) ASSORTED COMPUTER MONITORS
1204 LOT, ASSORTED BELTS ON THIS SHELF (UNUSED)	1218 LOT, (4) ASSORTED COMPUTER MONITORS
1205 LOT, ASSORTED BELTS ON THIS SHELF (UNUSED)	1219 -
1206 LOT, ASSORTED BELTS ON THIS SHELF (UNUSED)	1220 -
1207 LOT, ASSORTED BELTS ON THIS SHELF (UNUSED)	1221 -
1208 LOT, ASSORTED BELTS THIS THIS AREA (UNUSED)	1221Z SALE MOVES TO SIDE OFFICES
1209 LOT, ASSORTED BELTS THIS THIS AREA (UNUSED)	1222 LOT, LOOSE CONTENTS OF THIS OFFICE
1210 LOT, ASSORTED FILTERS IN THIS AREA (UNUSED)	1223 LOT, LOOSE CONTENTS OF THIS OFFICE
1210Z SALE MOVES TO CONFERENCE ROOM	1224 LOT, LOOSE CONTENTS OF THIS OFFICE
	1225 LOT, LOOSE CONTENTS OF THIS OFFICE
	1225Z SALE MOVES TO FUEL HOUSE AREA BY KILNS

SWANSON GROUP GLENDALE SAWMILL - LIVE AUCTION 8/7/2019

LOT #	LOT #
1226 LOT, H104 CHAIN ON THIS PALLET	1242 LOT, APPROX 260 GALLON OIL TANK W/MARKED
1227 LOT, H102 CHAIN ON THIS PALLET	CONTAINMENT BINS
1228 LOT, H102 CHAIN ON THIS PALLET	1243 APPROX 106" DIA, 12,000 GALLON DIESEL TANK W/PUMP & HOSE REEL
1229 LOT, 6" X 6-1/2" BOX CHAIN ON THIS PALLET	1244 LOT, (4) APPROX 260 GALLON OIL TANKS W/STAND
1230 LOT, ASSORTED CHAIN ON THESE (4) PALLETS	1245 LOT, (2) APPROX 260 GALLON OIL TANKS W/STAND
1231 LOT, ASSORTED CHAIN ON THESE (5) PALLETS	1246 LOT, APPROX 260 GALLON GAS TANK A W/NOZZLE & STAND
1232 LOT, ASSORTED CHAIN & BUCKETS ON THESE (4) PALLETS	1246B-
1233 LOT, ASSORTED CHAIN ON THESE (3) PALLETS	1247 LOT, APPROX 53"W X 16'L ALL WOOD UNIT A COVERS
1234 LOT, ASSORTED ROLLS & SPROCKETS IN THIS AREA	1247BLOT, APPROX 53"W X 16'L ALL WOOD UNIT COVERS
1235 LOT, ASSORTED ROLLS & BLOWPIPE FITTINGS IN THIS AREA	1248 LOT, STEEL LOG BUNKS BY ROAD
1236 LOT, ASSORTED MILL ITEMS IN THIS AREA	1249 -
1237 STEEL RACK W/WOOD SHELVES	1250 -
1238 STEEL RACK W/WOOD SHELVES	1250Z SALE MOVES TO BONEYARD
1239 LOT, (4) SECTIONS OF PALLET RACKING	1251 YATES
1240 LOT, STEEL RACKS IN THIS AREA	24' HYDRAULIC DRIVEN TRIPLE PINEAPPLE FEED TABLE W/(6) 29" X 12" HYDRAULIC DRIVEN ROLLS
1241 LOT, ASSORTED MILL EQUIPMENT IN THIS AREA	1252 YATES
	13' LIVE BRIDGE W/(6) 16" X 12" ROLLS & (2) HYDRAULIC DRIVEN FEED ROLLS

SWANSON GROUP GLENDALE SAWMILL - LIVE AUCTION 8/7/2019

LOT #	LOT #
1253 LOT, MARKED STEEL & EQUIPMENT IN THIS AREA	1264 HYDRAULIC UNIT W/(3) LINCOLN 100 HP MOTORS TO SAUER/SUNSTRAND PUMPS, 10 HP & 15 HP RECIRCULATORY PUMPS, ACCUMULATOR & FILTER
1254 LOT, LOOSE CONTENTS OF SCALERS OFFICE	1265 IRVINGTON 20' OVER END STACKER W/(5) LUMBER PLACING ARMS, (6) 60" LUMBER LOWERING ARMS, 4-STATION STICKER PLACER, MARKED CATWALK
1255 14' 5-ARM X 51" MECHANICAL TILT HOIST (NO DRIVE)	1266 PC-35HD CRANE ARM W/CONTROLS
1256 APPROX 30' MOVEABLE LUMBER GATE FRAME W/GEARHEAD DRIVE	1267 LOT, (6) ASSORTED DUMP BINS
1257 APPROX 28' POWERED ROLLCASE W/(9) 10-1/2" X 60" ROLLS, (11) LUMBER STOPS, MOTOR TO REDUCER	1268 LOT, (3) BLOWPIPE ASSEMBLIES W/MARKED STEEL ALONG CONTAINER
1258 APPROX 20' HYDRAULIC POWERED ROLLCASE W/(6) 6-1/2" X 74" ROLLS, 12-ARM LUMBER SKIDS, (10) CHAIN WAYS (NO CHAIN OR DRIVE SHAFT)	1269 LOT, ALL KILN CARTS OR KILN PARTS IN BONEYARD
1259 WESTERN INDUSTRIAL DESIGN PACKAGE BUMP ROLLCASE W/(2) APPROX 22' POWERED ROLLCASES W/(7) 8-1/2" X 54-1/2" ROLLS, GEARHEAD MOTOR, MARKED ACCESSORIES & STEEL	1270 60" 12-BLADE FAN
1260 LOT, (2) APPROX 22' 2-STRAND TRANSFERS W/APPROX 16' ROLLCASE	1271 24" X 24" CHIP FEEDER W/MOTOR SHAFT MOUNTED REDUCER
1261 LOT, (2) APPROX 24' 2-STRAND TRANSFERS	1272 24" X 24" CHIP FEEDER W/FALK SHAFT MOUNTED REDUCER
1262 APPROX 14' POWERED ROLLCASE W/(6) 8-1/2" X 60" ROLLS	1273 LOT, MARKED HYDRAULIC UNITS & TANKS IN THIS AREA
1263 2007 WESTERN PNEUMATICS 24" X 24" AIR LOCK W/MOTOR TO SHAFT MOUNTED REDUCER	1274 LOT, (2) POWERED ROLLCASES W/8-1/2" X 54" ROLLS
	1275 LOT, UNSOLD MARKED ASSORTED STEEL & EQUIPMENT IN THIS AREA

James G. Murphy Co.

SWANSON GROUP GLENDALE SAWMILL - LIVE AUCTION 8/7/2019

LOT #

1276 4' X8' CONFERENCE TABLE

1277 LOT, (10) RED CLOTH SIDE CHAIRS

**1278 LOT, WOOD DESK W/(2) WOOD TOP METAL
BASE TABLE**

**1279 LOT, (5) WHITE ROLLING TABLES & (3)
WHITE ROLLING
CORNER UNITS**

1280 LOT, ASSORTED FURNITURE & CHAIRS

1281 -

1282 -

1283 -

1284 -

1285 LOT, (5) STICKER RACKS

1286 LOT, (5) STICKER RACKS

1287 LOT, (6) STICKER RACKS

1288 LOT, (6) STICKER RACKS

1289 LOT, (6) STICKER RACKS

1290 LOT, (5) STICKER RACKS

1291 LOT, (5) STICKER RACKS

1292 LOT, (5) STICKER RACKS

1293 LOT, (5) STICKER RACKS

1294 LOT, (5) STICKER RACKS

NOTES

Lined area for notes, consisting of multiple horizontal lines.